



## 6 Stubbs Close, Pontefract, WF8 4TE

Nestled in the tranquil cul-de-sac of Stubbs Close, Pontefract, this stunning detached house is a remarkable find for those seeking modern living in a peaceful setting. Built in 2018, this new build property boasts a generous 1,141 square feet of well-designed space, making it perfect for families or those who enjoy entertaining.

The home features four spacious double bedrooms, providing ample room for relaxation and privacy. With two well-appointed bathrooms, morning routines will be a breeze, ensuring convenience for all residents. The heart of the home is a welcoming reception room, ideal for gatherings or quiet evenings in.

One of the standout features of this property is the large garden, offering a wonderful outdoor space for children to play, gardening enthusiasts to thrive, or simply for enjoying the fresh air. The double drive provides parking for two vehicles, adding to the practicality of this lovely home.

Situated in a desirable location, this property combines the benefits of a peaceful neighbourhood with easy access to local amenities. Whether you are looking for a family home or a place to settle down, this delightful house on Stubbs Close is sure to impress. Don't miss the opportunity to make this beautiful property your own.

- STUNNING 4 BEDROOM DETACHED HOME
- SOUGHT AFTER LOCATION
- 4 DOUBLE BEDROOMS
- LARGE GARDEN
- DOUBLE DRIVEWAY
- OPEN PLAN KITCHEN DINER
- EN SUITE

£390,000



Floor 0

Approximate total area<sup>(1)</sup>  
120.5 m<sup>2</sup>

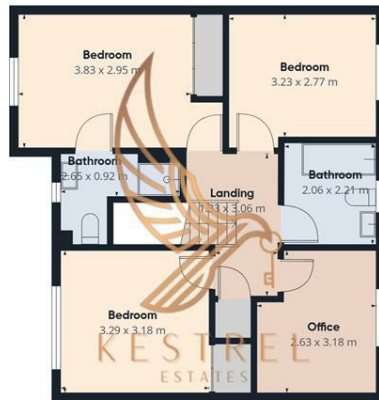

Floor 1

(1) Excluding balconies and terraces

Calculations reference the RICS IPMS 3C standard. Measurements are approximate and not to scale. This floor plan is intended for illustration only.

GIRAFFE360

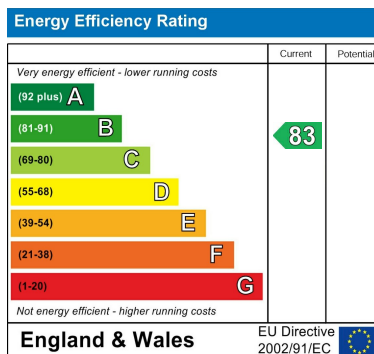

83