

Sturry Road, Canterbury, CT1 1DA

£1,350 Per Month



## Sturry Road

### Canterbury CT1 1DA

This attractive and spacious three-bedroom period house offers generous accommodation arranged over two floors, combining classic character with bright, modern interiors.

The ground floor features a welcoming entrance hallway leading to a well-proportioned living room with a large bay window, high ceilings and a feature fireplace, creating a light and elegant reception space. To the rear is a separate dining room, ideal for entertaining or family use, which flows through to a fitted kitchen with appliances and direct access to the rear garden. A contemporary ground-floor shower room completes the downstairs accommodation.

Upstairs, the property continues to impress with a large master bedroom, two further bedrooms offering flexible use, and a modern bathroom. The layout provides excellent space throughout, with tall ceilings and large windows enhancing the sense of light and openness.

Externally, the property benefits from a large, long enclosed rear garden, providing an excellent outdoor space for relaxing, dining, or gardening.

This well-presented home is ideally suited to families or professional tenants seeking a characterful property with generous living space and outdoor accommodation.

Available NOW  
Permit parking only from Canterbury





City Council.  
Unfurnished.  
Rent £1,350 per month is EXCLUSIVE  
of all utilities.  
Deposit is equal to 5 weeks rent  
£1,557  
This can be paid anytime, until your  
tenancy begins (EXCLUDING Holding  
Deposit)  
Council Tax Band D (Canterbury City  
Council)  
Viewings strictly by appointment only

Please refer to the fee`s tab on our  
website ([www.sallyhatcher.co.uk](http://www.sallyhatcher.co.uk)) for all  
information on fee`s and deposit  
options



## Floor Plan

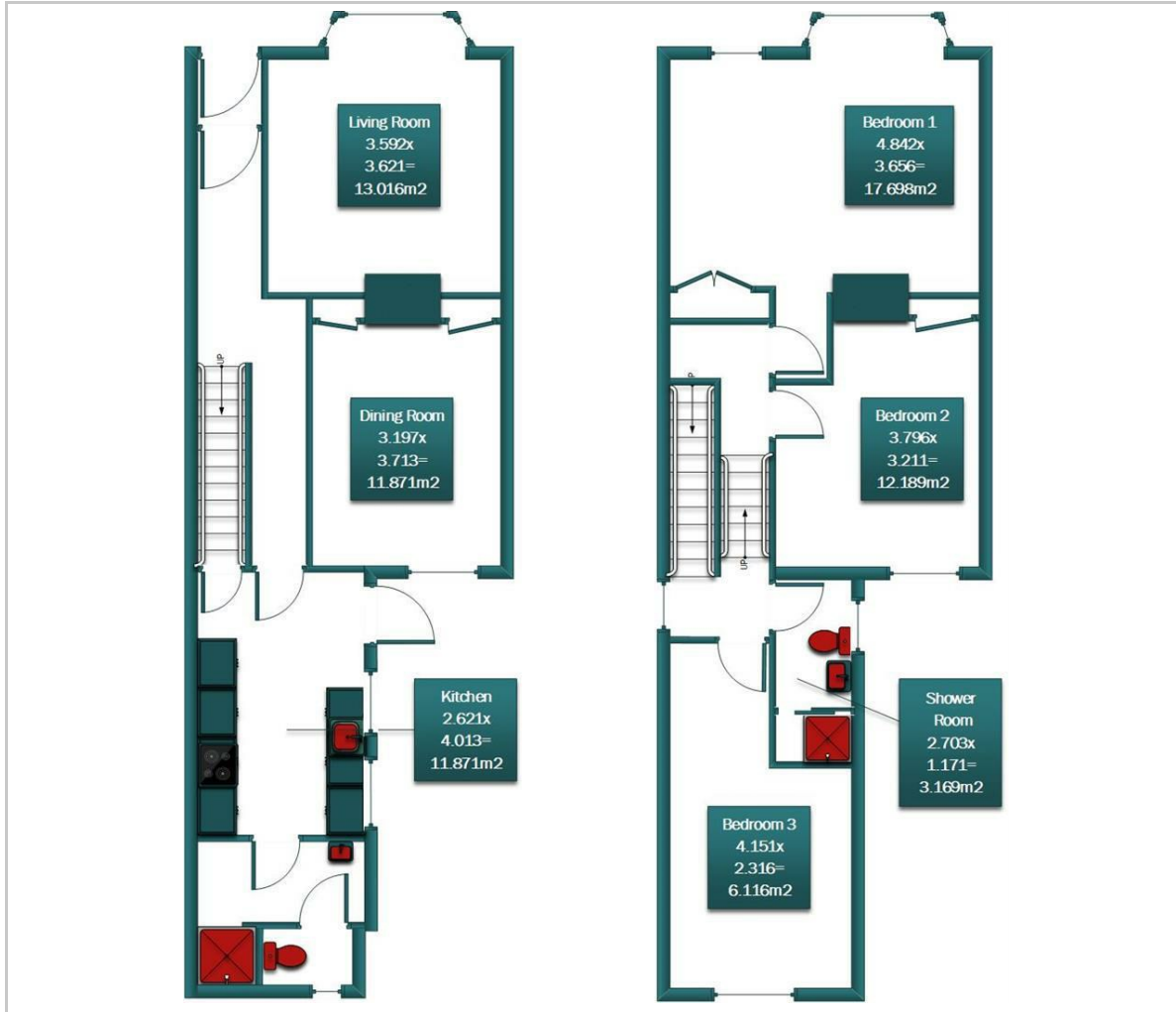

## Viewing

Please contact us on 01227 733888 if you wish to arrange a viewing appointment for this property or require further information.

These particulars, whilst believed to be accurate are set out as a general outline only for guidance and do not constitute any part of an offer or contract. Intending purchasers should not rely on them as statements of representation of fact, but must satisfy themselves by inspection or otherwise as to their accuracy. No person in this firm's employment has the authority to make or give any representation or warranty in respect of the property.

## Area Map

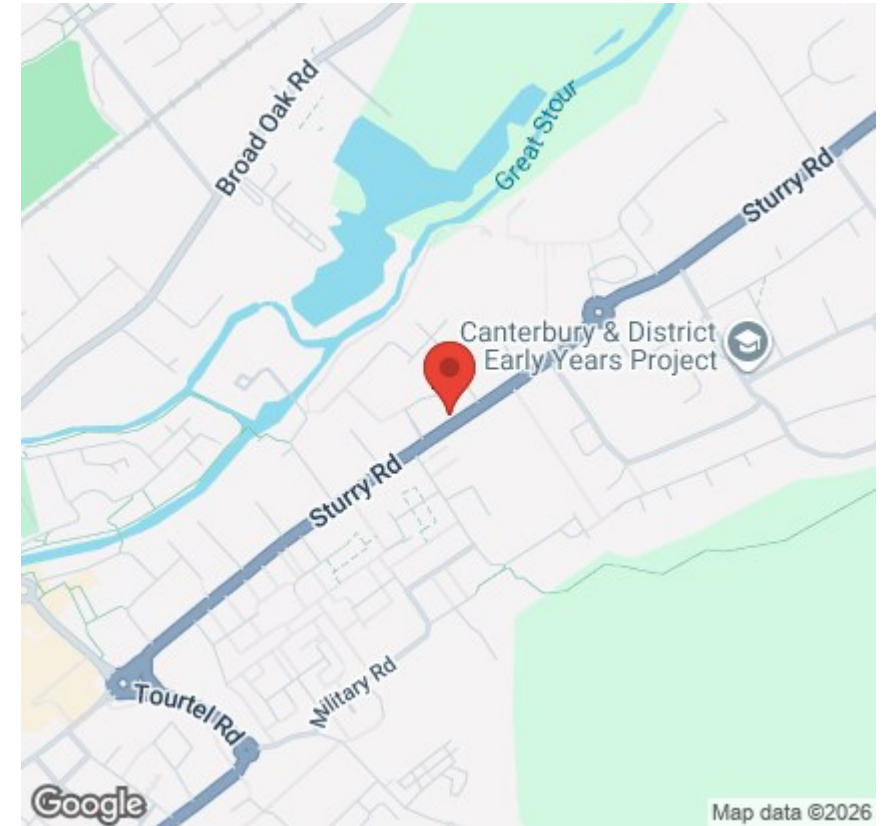

## Energy Efficiency Graph

