



## SHOOT UP HILL, NW2

£2,800 per month

This spacious three bedroom mansion flat is ideally situated on the borders of West Hampstead and Cricklewood. The property has three double bedrooms, one with an en suite shower room, a well-sized

Three Bedrooms  
Spacious Reception  
Separate Kitchen

Two Bathrooms  
Good Storage  
Off Street Permit Parking

@marshandparsons  
marshandparsons.co.uk

MARSH &  
PARSONS

# STEP INSIDE SHOOT UP HILL

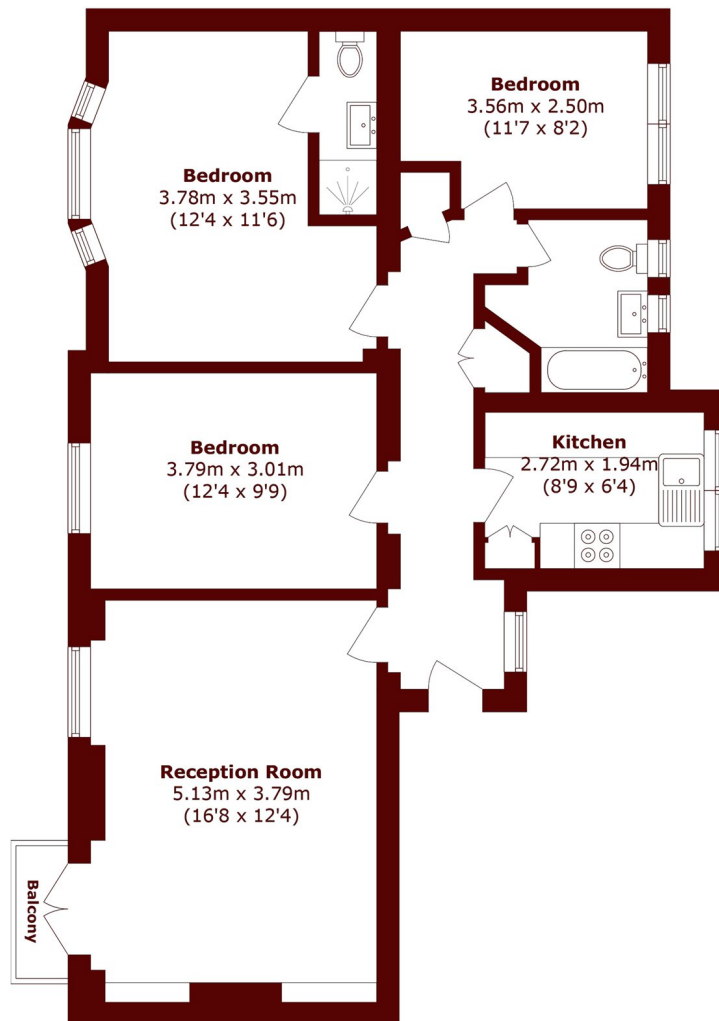

Total area (approx.): 77.9 sq. m (838.5 sq. ft)

Balcony area (approx.): 1.2 sq. m (12.9 sq. ft)

**Willesden Green**  
020 8939 1780

Energy Rating: We aim to make our particulars both accurate and reliable. However, they are not guaranteed; nor do they form part of an offer or contract. If you require clarification on any points then please contact us, especially if you're traveling some distance to view. Please note that appliances and heating systems have not been tested and therefore no warranties can be given as to their good working order

**MARSH &  
PARSONS**