

for sale

£295,000



Deane Way Tatworth Chard TA20 2TD

Enjoying an ENVIABLE corner plot within the sought-after village of Tatworth, this fabulous link-detached home benefits from a SOUTHERLY-FACING enclosed garden. Located just two miles outside the market town of Chard, this incredible property boasts an IMMACULATE arrangement of accommodation.



Deane Way Tatworth Chard TA20 2TD

Front Door

Leading to...

Entrance Hall

Obscured double glazed side aspect window.

Downstairs Cloakroom

Low-level WC, corner wash hand basin, partial tiling.

Lounge

Dual aspect double glazed side and front aspect windows, recessed under-stairs cupboard. Archway through to the...

Dining Area

Double glazed side aspect window with double glazed sliding patio doors to rear opening to outside. Obscured single glazed door through to the...

Kitchen

Double glazed window and door to rear opening to outside. Wall-mounted combination boiler. The kitchen itself is equipped with a range of wall and base mounted units with roll-top work surfaces including a 1 and a half bowl sink and drainer with mixer tap. Recesses include plumbing for an automatic washing machine. Integrated electric oven with gas hob and cooker hood over.



Landing

Bedroom 1

Double glazed side aspect bay window. Built in wardrobes.

Bedroom 2

Double glazed front aspect window. Built in wardrobes.

Bedroom 3

Double glazed rear aspect window. Built in wardrobes.

Sower Room

Obscure double glazed side aspect window. A well-equipped suite including twin shower cubicle with electric shower with 'waterfall feature', low level WC, wash hand basin with vanity surface and cupboard.

Rear Garden

A real feature of this property is the generous nature of this enclosed and southerly facing garden, which is initially laid to patio and predominantly laid to lawn. The garden is canvassed by a wonderful array of plants, shrubs, flowers, and bushes. On the lower tier, there is a further patio and a useful wooden storage shed. Gated side pedestrian access.

Garage

Located alongside the property with an up-and-over door, power, and light.

Parking

Driveway in front of the garage for up to two cars.



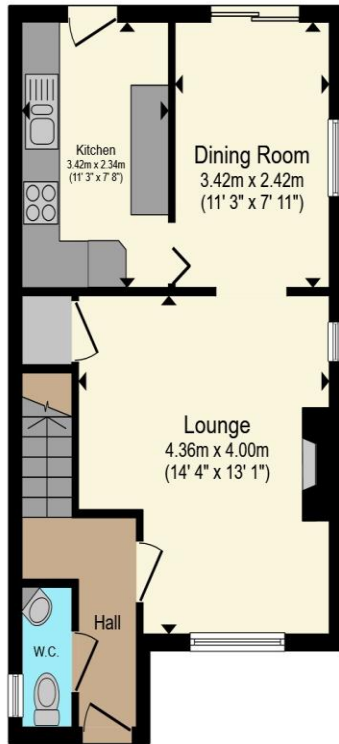

Ground Floor

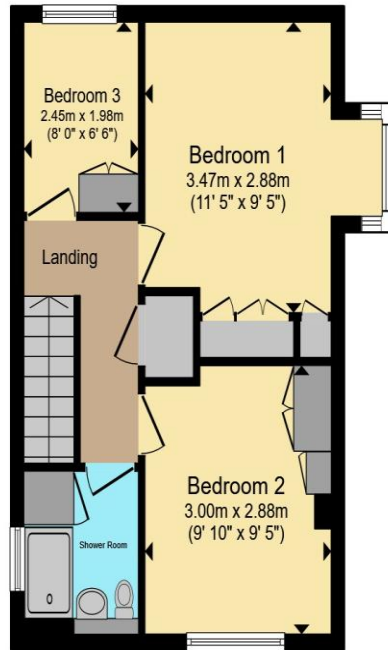

First Floor

Total floor area 80.4 m² (866 sq.ft.) approx

This floor plan is for illustrative purposes only. It is not drawn to scale. Any measurements, floor areas (including any total floor area), openings and orientation are approximate. No details are guaranteed, they cannot be relied upon for any purpose and they do not form part of any agreement. No liability is taken for any error, omission or misstatement. A party must rely upon its own inspection(s). Powered by www.propertybox.io



To view this property please contact Connells on

T 01823 334 433
E taunton@connells.co.uk

53 High Street
 TAUNTON TA1 3PR

Property Ref: TTN313751 - 0007

Tenure:Freehold EPC Rating: Awaited

Council Tax Band: D

view this property online
connells.co.uk/Property/TTN313751



1. MONEY LAUNDERING REGULATIONS Intending purchasers will be asked to produce identification documentation at a later stage and we would ask for your co-operation in order that there will be no delay in agreeing the sale. 2. These particulars do not constitute part or all of an offer or contract. 3. The measurements indicated are supplied for guidance only and as such must be considered incorrect. Potential buyers are advised to recheck measurements before committing to any expense. 4. We have not tested any apparatus, equipment, fixtures, fittings or services and it is in the buyers interest to check the working condition of any appliances.

Connells Residential is registered in England and Wales under company number 1489613, Registered Office is Cumbria House, 16-20 Hockliffe Street, Leighton Buzzard, Bedfordshire, LU7 1GN. VAT Registration Number is 500 2481 05.

see all our properties at www.connells.co.uk | www.rightmove.co.uk | www.zoopla.co.uk