





****GUIDE PRICE: £400,000 - £425,000****

Situated within the highly sought-after Glenleigh Park development in Havant, this impressive three-bedroom detached home offers spacious and well-presented accommodation, perfectly suited to modern family living. Benefiting from a private driveway, garage and a convenient location close to local amenities, schools and transport links, this property presents an excellent opportunity for a growing family or those seeking additional space.

The ground floor accommodation comprises a welcoming entrance hall, a generous lounge filled with natural light and a modern kitchen/dining room providing the ideal space for everyday living and entertaining, benefitting from the huge added bonus of a separate utility room. The layout offers a practical flow throughout with ample storage and direct access to the rear garden and driveway/garage.

To the first floor, the property boasts three well-proportioned bedrooms, including a spacious principal bedroom with en-suite bathroom, alongside a contemporary family bathroom. Each room has been thoughtfully designed to maximise comfort and functionality, creating a wonderful environment for family life.

Externally, the property enjoys a private rear garden ideal for outdoor dining and relaxation. The driveway provides off-road parking and leads to the garage, offering further parking, storage or workshop potential.

- DETACHED HOUSE
- GUIDE PRICE: £400,000 - £425,000
- EN-SUITE TO MASTER BEDROOM
- GARAGE
- DRIVEWAY
- KITCHEN/DINER
- UTILITY ROOM
- POPULAR LOCATION



Glenleigh Park, Denvilles

Approximate Gross Internal Area = 113.6 sq m / 1223 sq ft

(Excluding Reduced Headroom / Eaves)

Reduced Headroom = 0.6 sq m / 6 sq ft

Total = 114.2 sq m / 1229 sq ft

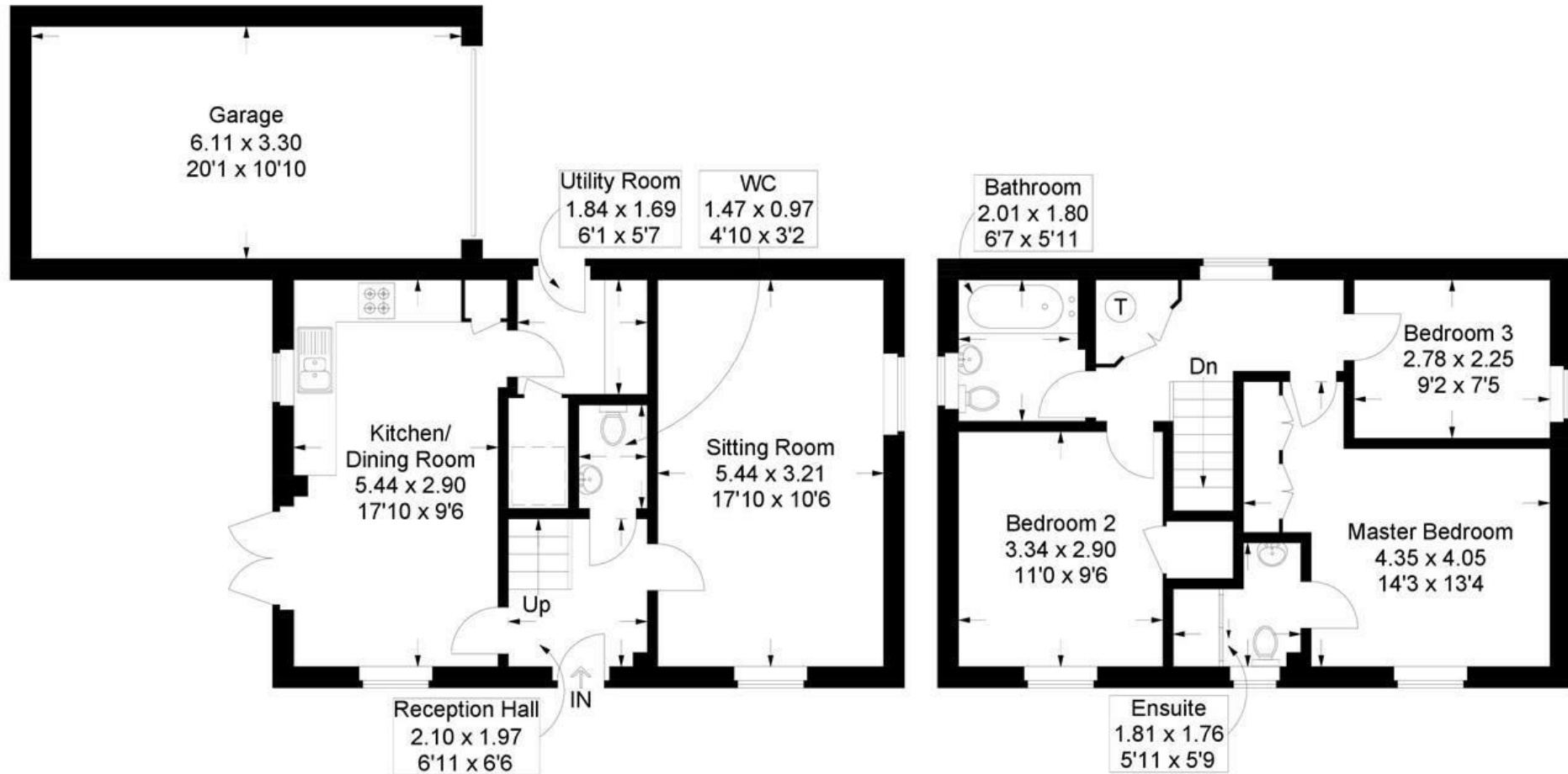

Ground Floor

First Floor

 = Reduced headroom below 1.5m / 5'0

This plan is for layout guidance only. Not drawn to scale unless stated. Windows and door openings are approximate. Whilst every care is taken in the preparation of this plan, please check all dimensions, shapes and compass bearings before making any decisions reliant upon them.