

PAYNE & Co



Littlemoor Road, Ilford

Ilford

Guide Price £450,000 Co

Guide Price: £450,000 – £475,000. This three-bedroom terraced house is for sale in Ilford and requires modernising, offering scope for buyers to update and tailor the accommodation to their own needs. The property includes two reception rooms, providing separate areas for living and dining, along with a single kitchen and one bathroom. There is noted potential to extend, subject to planning permission, which may appeal to first-time buyers and families looking for additional space in the future. The property has an EPC rating of D. Located in Ilford, the house is well placed for access to local amenities. Ilford town centre offers a range of shops, cafés and restaurants, as well as everyday services. Nearby open spaces such as Valentines Park provide opportunities for walking, sports and play areas. Ilford Station, on the Elizabeth Line, offers direct services into central London, including Liverpool Street in around 15–20 minutes and onward connections to the West End and Heathrow. Local bus routes operate through the area, linking Ilford with neighbouring districts and retail centres. A selection of primary and secondary schools can be found within the wider Ilford area, making the location practical for households needing access to education and transport connections.

Council Tax: London Borough of Redbridge

Tax Band D – **£2,294.58 per annum (2025/2026)**

Tenure: Freehold

EPC Energy Efficiency Rating: D

EPC Environmental Impact Rating: D

- No Onwards Chain
- Potential for Extensions (STPP)
- Three Bedrooms
- Two Receptions
- Scope for Modernisation
- Good access to local Schools
- Ideal for first-time buyers
- Close to Ilford town centre



Ground Floor

Porch

Hallway

Reception

16' 9" x 11' 2" (5.11m x 3.40m)

Reception

16' 10" x 8' 2" (5.13m x 2.49m)

Kitchen

15' 6" x 9' 1" (4.72m x 2.77m)

First Floor Landing

Bedroom

11' 2" x 10' 5" (3.40m x 3.18m)

Bedroom

11' 8" x 10' 0" (3.56m x 3.05m)

Bedroom

7' 8" x 6' 0" (2.34m x 1.83m)

Bathroom







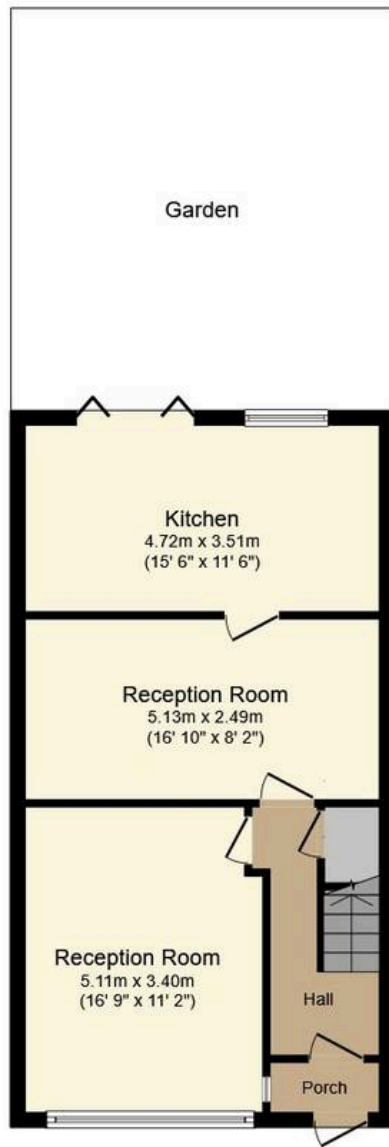

Ground Floor

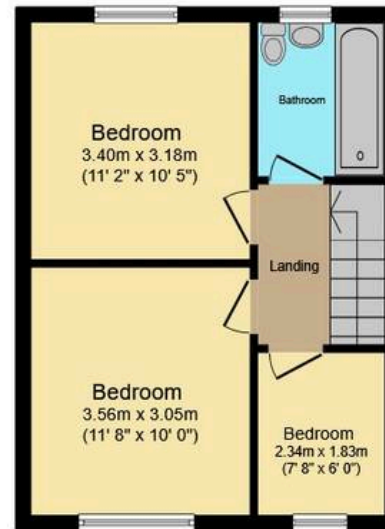

First Floor

This floor plan is for illustrative purposes only. It is not drawn to scale. Any measurements, floor areas (including any total floor area), openings and orientations are approximate. No details are guaranteed, they cannot be relied upon for any purpose and do not form any part of any agreement. No liability is taken for any error, omission or misstatement. A party must rely upon its own inspection(s). Powered by www.Propertybox.io

PAYNE & Co



PAYNE & Co

Payne & Co

Payne & Co, 151 Cranbrook Road - IG1 4TA

020 8518 3000 • ilford@payneandco.co.uk • payneandco.co.uk

A private rental licensing scheme applies to some properties in this area, please contact us before proceeding. Legal advice should be taken to verify fixtures/fittings, planning, alterations and/or lease details. Appliances & services are untested, dimensions are approximate, and floor plans are not to scale.