



Stanley Road, TW11

£259,950

Dexters



Stanley Road, TW11

This one bedroom apartment is located in an imposing Victorian building. There is no onward chain and the property is immaculately presented throughout.

Enter into the reception room which has a floor to ceiling storage until, the living room opens up onto the kitchen with an island and space for all appliances. There are large windows throughout that make this apartment light and airy.

The double bedroom, which has high ceilings and has a floor to ceiling fitted wardrobe. In addition there is a modern shower room.

To the rear of the property there is a large communal garden and there is an allocated parking space along with a share of the freehold.

Stanley Road is located 0.6 miles from Teddington mainline station and just moments from Stanley Road's local shops and restaurants as well as Teddington High Street being 0.4 miles away

Features

- Double Bedroom
- Allocated Parking
- Share Of Freehold
- No Onward Chain
- Immaculate Presentation
- Fitted Storage



Stanley Road, Teddington, TW11

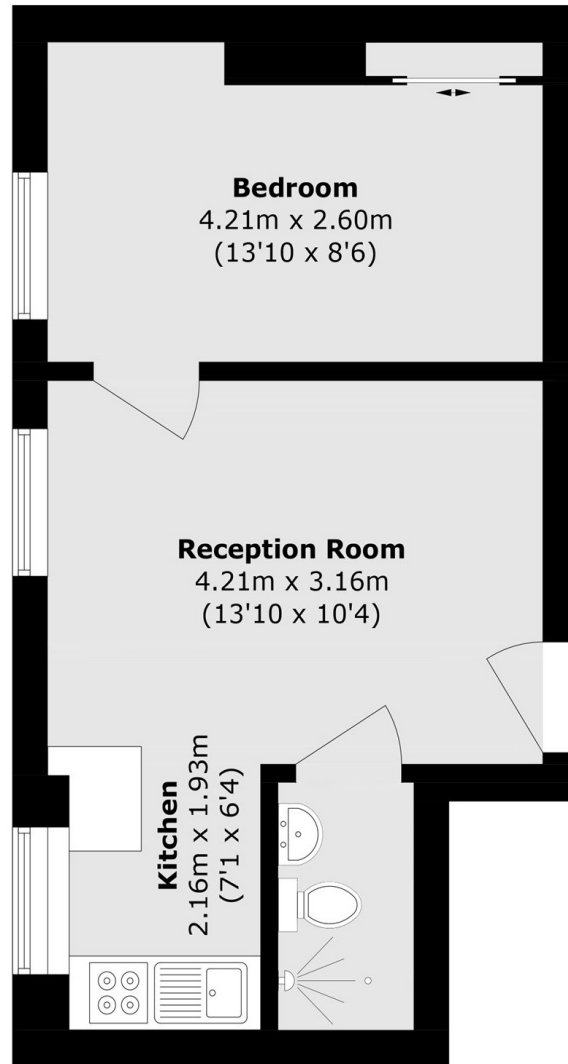

Total area (approx.): 31.4 sq. m (337.9 sq. ft)