

Towers Wills

Town & Country

📞 01935 577 032 | 01460 298 530 | ✉ info@towerswills.co.uk



10, Welbeck Road, Yeovil, Somerset BA21 5PH

£170,000

Towers Wills are pleased to present to the market this spacious and generously proportioned mid-terrace home, situated within a popular residential area close to Yeovil Town centre and its excellent range of local amenities, whilst enjoying an edge of town position.

Accommodation:

Offering well-balanced accommodation throughout, the property presents an excellent opportunity for refurbishment and modernisation, allowing a prospective purchaser to create a home tailored to their own tastes and requirements.

The accommodation briefly comprises a spacious entrance hallway leading through to a comfortable lounge. From the lounge, there is useful understairs storage together with access to the generous kitchen/diner, providing ample space for both cooking and dining. Beyond the kitchen/diner is a rear lobby with access to a convenient ground floor WC.

To the first floor, the property benefits from two well-proportioned double bedrooms, both served by a family bathroom and a separate WC.

Outside:

Externally, the front garden is predominantly laid to lawn and enclosed by walling. Subject to the necessary consents, there is potential for the creation of off-road parking. To the rear, the garden enjoys a small patio terrace ideal for outdoor seating, leading onto a lawned area interspersed with a variety of mature flowers and shrubs. The garden is enclosed by timber fencing and benefits from gated access at the rear.

This property offers tremendous potential for a future owner to put their own stamp on it and is likely to appeal to first-time buyers, investors and downsizers alike seeking a well-located home within a popular area.

Key Features

- Mid-Terrace
- Two Double Bedrooms
- Front & Rear Gardens
- NO ONWARD CHAIN

Contact Us

Towers Wills Estate Agents - Yeovil

114, Hendford Hill

Yeovil

Somerset

BA202RF

T: 01935 577032

E: info@towerswills.co.uk



Floor Plan

GROUND FLOOR

1ST FLOOR

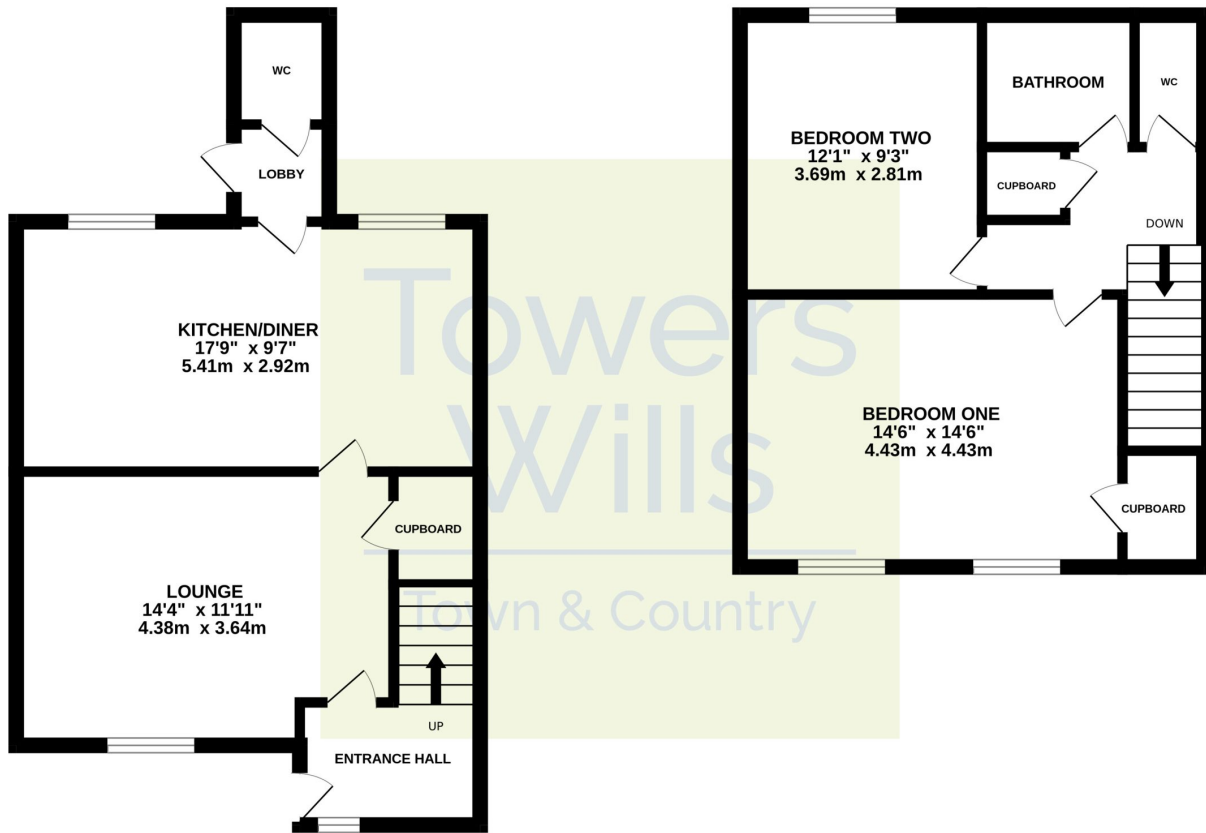

Whilst every attempt has been made to ensure the accuracy of the floorplan contained here, measurements of doors, windows, rooms and any other items are approximate and no responsibility is taken for any error, omission or mis-statement. This plan is for illustrative purposes only and should be used as such by any prospective purchaser. The services, systems and appliances shown have not been tested and no guarantee as to their operability or efficiency can be given.
Made with Metropix ©2026

Please Note No tests have been undertaken of any of the services and any intending purchasers should satisfy themselves in this regard. Towers Wills Ltd for themselves and for the vendor of this property whose agents they are, give notice that, (i) these particulars do not constitute any part of an offer or contract, (ii) all statements contained within these particulars are made without responsibility on the part of Towers Wills or the vendor, (iii) whilst made in good faith, none of the statements contained within these particulars are to be relied upon as a statement of representation or fact, (iv) any intending purchaser must satisfy him/herself by inspection or otherwise as to the correctness of each of the statements contained within these particulars, (v) the vendor does not make or give either Towers Wills or any person in their employment any authority to make or give representation or warranty whatsoever in relation to this property.

Photographs / Floor Plans Photographs are reproduced for general information and it must not be inferred that any item is included for sale with this property. Please note floor plans are not to scale and are for identification purposes only. The photographs used in these particulars may have been taken with the use of a wide angle lens. If you have any queries as to the size of the accommodation or plot, please address these with the agent prior to making an appointment to view

Towers Wills

The White House, 114 Hendford Hill, Yeovil BA20 2RF

Yeovil 01935 577032 / South Petherton 01460 298530

info@towerswills.co.uk | www.towerswills.co.uk