

FREEHOLD



Flat - Purpose Built (EPC Rating: B)

# 5 FULLER GATE, COATBRIDGE, ML5 4FX

Offers over

# £154,495

## FEATURES

- First floor apartment
- Modern 2-bedroom flat
- 2 bathrooms, master en-suite
- 2 x Double door balcony
- Open-plan lounge/kitchen
- Large hall, room access
- Easy access to amenities
- Viewing recommended



**SWEET  
HOME**



# 2 Bedroom Flat - Purpose Built located in Coatbridge

Caroline Morrison of Sweet Home Scotland is delighted to present this exquisite modern apartment in the highly sought-after area of Coatbridge. This first-floor flat seamlessly combines comfort and contemporary living, making it the perfect choice for your next home.

Upon entering, you'll find a spacious hallway that provides access to all rooms, ensuring a practical and inviting layout. The apartment boasts two generously sized double bedrooms, with the master featuring an en-suite bathroom for your convenience and privacy. The family bathroom is tastefully designed, catering to both residents and guests alike.

The highlight of this home is undoubtedly the open-plan lounge and kitchen area, thoughtfully designed for relaxation and entertaining. Bathed in natural light, this inviting space includes double doors that open onto a charming balcony—ideal for enjoying a morning coffee or unwinding in the evening.

With modern finishes and a functional layout, this apartment not only exudes style but also meets your everyday needs. The prime location in Coatbridge offers easy access to local amenities, transport links, and beautiful green spaces, making it a wonderful place to call home.

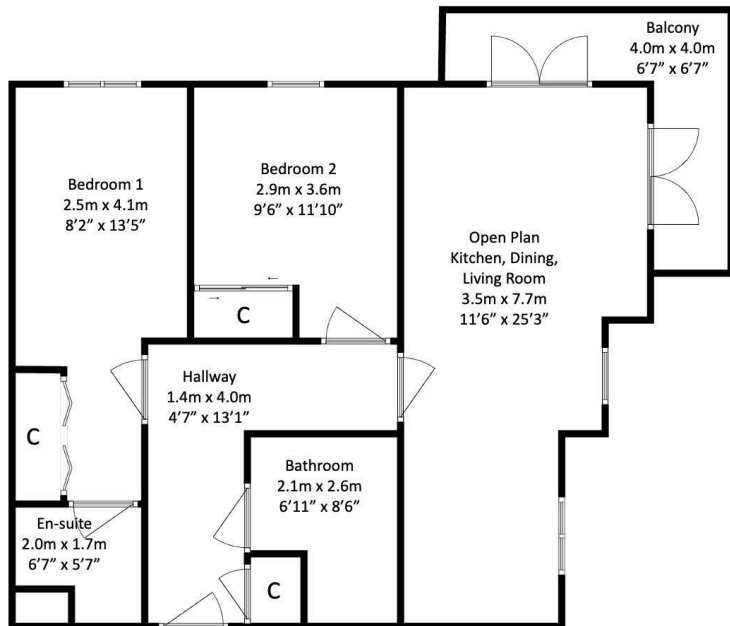

Call us on

**01236 677500**

[sales@sweet-home.co.uk](mailto:sales@sweet-home.co.uk)

<https://sweet-home.co.uk/>

**Council Tax Band**

**C**

Energy Efficiency Rating		Current	Potential
<i>Very energy efficient - lower running costs</i>			
(92 plus)	A		
(81-91)	B	83	83
(69-80)	C		
(55-68)	D		
(39-54)	E		
(21-38)	F		
(1-20)	G		
<i>Not energy efficient - higher running costs</i>			
<b>Scotland</b>		EU Directive 2002/91/EC	

Agents Note: Whilst every care has been taken to prepare these particulars, they are for guidance purposes only. All measurements are approximate and are for general guidance purposes only and whilst every care has been taken to ensure their accuracy, they should not be relied upon and potential buyers are advised to recheck the measurements.

**SWEET HOME**

