



Threipland Drive,  
Heath, Cardiff,  
CF14 4PW



PCM  
£1,100 PCM

2 Bedrooms  
Flat - Third Floor

An impressive two bedroom apartment on the top floor of this popular modern development in The Heath. Newly decorated throughout, this spacious property enjoys open plan kitchen/living arrangement and allocated off road parking. Unfurnished with kitchen appliances and fitted wardrobes. Gas central heating. Favourably located between the villages of Rhiwbina, Birchgrove and Llanishen, there is added convenience with an Aldi and Lidl superstore nearby. UHW and Heath Park within 1.5km. EPC rating C. Council Tax band D. Available July 2026 for initial twelve month term.

## Features

- Impressive Top Floor Apartment on Modern Development
- Two Double Bedrooms/Open Plan Kitchen/Living Room
- Unfurnished with Kitchen Appliances/Fitted Wardrobes
- Newly Decorated Throughout/Gas Central Heating
- Allocated Off Road Parking/Bicycle Storage
- Favourable Location with Villages of Rhiwbina, Birchgrove and Llanishen Nearby
- UHW and Heath Park Within 1.5km/Aldi and Lidl Superstore Very Nearby



## Information

- Tenure:
- Council Tax Band: D
- Floor Area: 674.70 sq ft
- Current EPC Rating: C
- Potential EPC Rating: C



2 BEDROOMS



1 BATHROOMS



1 RECEPTION ROOMS



ENERGY RATING: C

**Ground Floor**  
Approx. 674.7 sq. feet

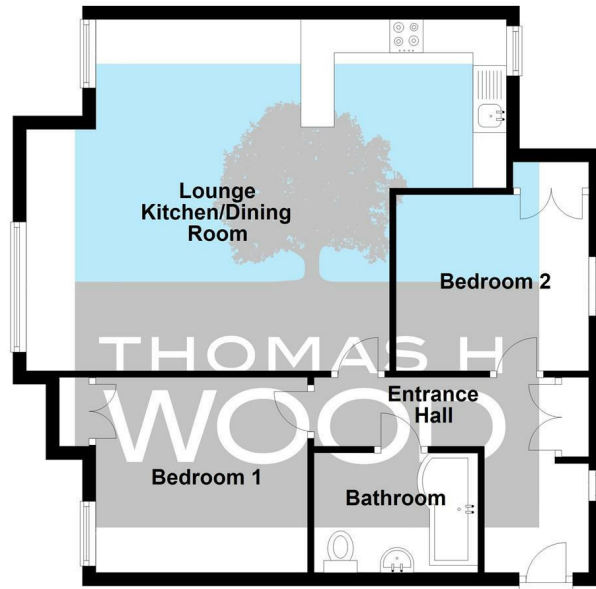

Total area: approx. 674.7 sq. feet



Agents Note: Whilst every care has been taken to prepare these sales particulars, they are for guidance purposes only. All measurements are approximate and for general guidance purposes only and whilst every care has been taken to ensure their accuracy, they should not be relied upon and potential buyers are advised to recheck the measurements

Energy Efficiency Rating		
	Current	Potential
Very energy efficient - lower running costs		
(92 plus) <b>A</b>		
(81-91) <b>B</b>		
(69-80) <b>C</b>	78	79
(55-68) <b>D</b>		
(39-54) <b>E</b>		
(21-38) <b>F</b>		
(1-20) <b>G</b>		
Not energy efficient - higher running costs		
<b>England &amp; Wales</b>	EU Directive 2002/91/EC	

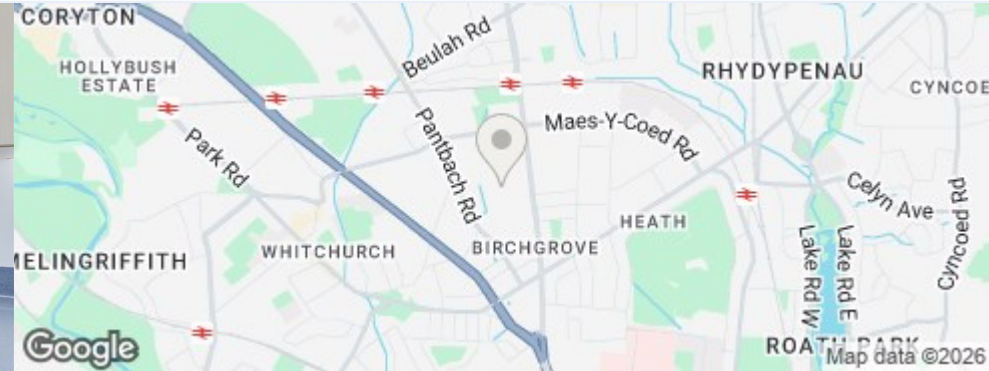

**CONTACT**

sales@thomashwood.com  
02920 626 252  
thomashwood.com

**WHITCHURCH BRANCH**

14 Park Road,  
Whitchurch  
CF14 7BQ

**RADYR BRANCH**

5 Station Road,  
Radyr, Cardiff  
CF15 8AA