



## The Avenue, W13

£345 Per week

An exceptional 772 sq ft one double bedroom garden flat with off-street parking sitting proudly within Ealing's most unique development, The Church of St Stephen's which was converted in 1987.

Situated at the top of The Avenue, St Stephens Church is half a mile to West Ealing Overground and future Crossrail station.

### Features

Church Conversion  
One Bedroom  
Semi Open Plan  
Ground Floor  
Integrated Kitchen  
Off-Street Parking

## The Avenue, London, W13

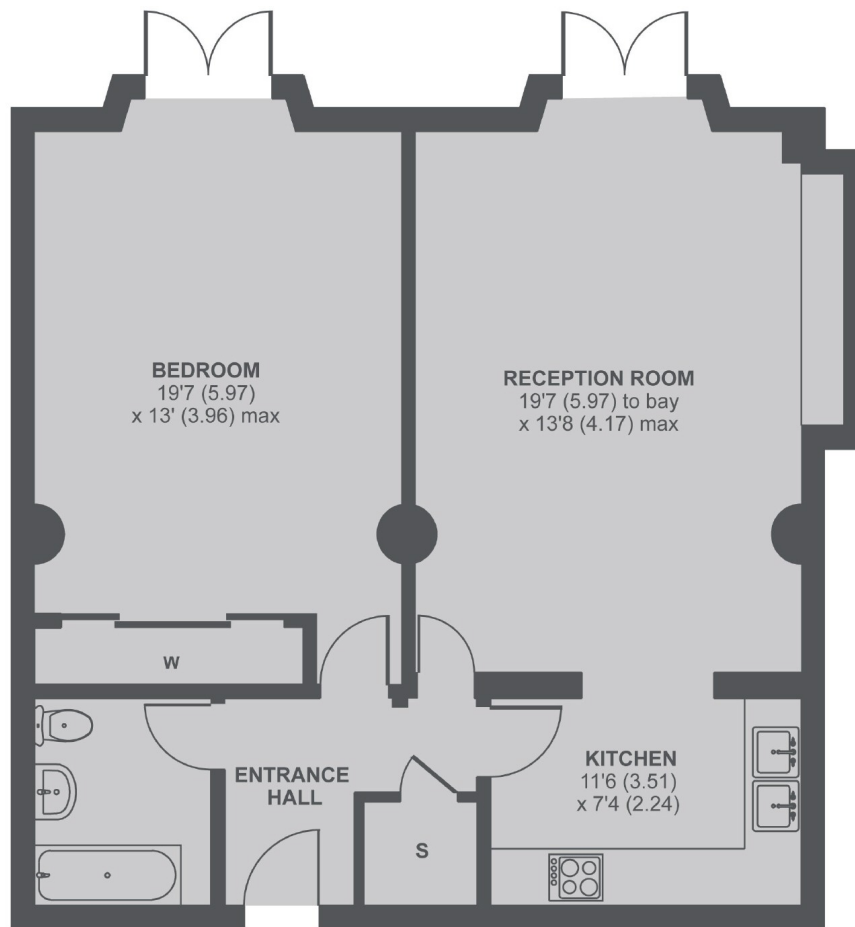

Ground Floor

### The Avenue W13

TOTAL HOUSE APPROX FLOOR AREA 772 SQ.FT 71.6 SQ.M

Copyright nichecom.co.uk 2018 REF : 260557

#### Contact

To arrange a viewing call our office on the number below or visit our website.



Energy Rating: C. We aim to make our particulars both accurate and reliable. However they are not guaranteed; nor do they form part of an offer or contract. If you require clarification on any points then please contact us, especially if you're traveling some distance to view. Please note that appliances and heating systems have not been tested and therefore no warranties can be given as to their good working order.