



 **2**
Bedrooms

 **1**
Bathroom

**Tenure :
Freehold**



Offered for sale with no onward chain is this immaculately presented two bedroom terraced home, ideally located on Tatefield Place in Kippax. Perfectly suited for first time buyers, the property offers a modern and well maintained interior throughout.

The accommodation briefly comprises:

Ground Floor – A contemporary kitchen and a welcoming lounge.

First Floor – Landing, two good-sized bedrooms, and a stylish bathroom.

Additional benefits include gas central heating and double glazed windows throughout.

Externally, the home enjoys a neat buffer garden to the front and a generous, low maintenance garden to the rear, ideal for relaxing or entertaining.

Don't miss out, contact Tudor Sales & Lettings today for further information or to arrange your viewing!

Kitchen 2.72m x 4.61m (8' 11" x 15' 1")

With a range of wall and base units. Laminated worktops. Sink and tap. Integrated oven, hob and an extractor over. Tiled splashbacks. Plumbing for a washing machine. Two double glazed windows. Tiled flooring. Central heating radiator.

Lounge 3.65m x 4.23m (12' x 13' 11")

Double glazed window. Central heating radiator. Access to first floor.

Bedroom 1 3.64m x 4.64m (11' 11" x 15' 3")

Two double glazed windows and a central heating radiator.

Bedroom 2 3.35m x 2.43m (11' x 8')

Central heating radiator and a double glazed window.

Bathroom 2.50m x 2.10m (8' 2" x 6' 11")

Fully tiled modern bathroom with a bath and shower over, wash hand basin and wc. Heated towel rail. Double glazed window.

GROUND FLOOR

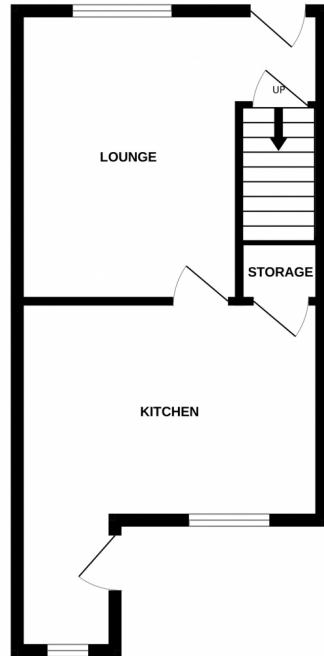

1ST FLOOR

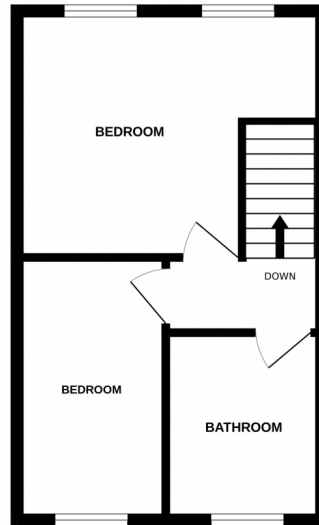

Whilst every attempt has been made to ensure the accuracy of the floorplan contained here, measurements of doors, windows, rooms and any other items are approximate and no responsibility is taken for any error, omission or mis-statement. This plan is for illustrative purposes only and should be used as such by any prospective purchaser. The services, systems and appliances shown have not been tested and no guarantee as to their operability or efficiency can be given.
Made with Metropix C2025

