

## **22 UZELLA PARK, LOSTWITHIEL, PL22 0BB**



**A two bedroom mid-terrace house with no ongoing chain, situated within a popular cul-de-sac development just a short level walk from the town centre.**

**Accommodation Comprises:- Lounge/diner, kitchen, landing, two double bedrooms, shower room, wood effect uPVC double glazing, gas fired central heating, enclosed rear garden and an allocated parking space.**

# **£210,000**

## SITUATION

The ancient stannary town of Lostwithiel is steeped in history and renowned for its vibrant community, offering a good range of amenities including a variety of shops, cafes, restaurants, public houses, professional services, two primary schools, dentist and health centre. There is also a main line train station on the Penzance to London line and a purpose-built community centre. Lostwithiel lies just a few miles from the south coast and about a fifteen-minute drive from the world renowned 'Eden Project'.

## ACCOMMODATION (All sizes approximate):-

### GROUND FLOOR

#### Entrance

Composite front entrance door opening into:-



#### Lounge/Diner

18' 8" x 12' 0" (5.69m x 3.65m) uPVC double glazed window to front elevation. Radiator. TV aerial and telephone points. Turning staircase to first floor. Door into:-



#### Kitchen

12' 0" x 9' 4" (3.65m x 2.85m) Matching range of shaker style wall, base and drawer units with rolled edge worktops. Inset stainless steel sink and drainer with mixer tap. Space and plumbing for washing machine. Space for electric cooker. Space for fridge/freezer. Part tiled walls. Radiator. Deep under stairs cupboard with electric meter and consumer unit. uPVC double glazed window to rear elevation. Obscure uPVC double glazed door to rear garden.

### FIRST FLOOR

#### Landing

Access to loft space. Doors to bedrooms and shower room.

#### Bedroom One

12' 7" x 12' 0" (3.83m x 3.65m) Two uPVC double glazed windows to front elevation. Radiator.

#### Bedroom Two

11' 11" x 9' 4" (3.64m x 2.85m) uPVC double glazed window to rear elevation. Radiator. Built-in cupboard housing a Worcester Greenstar 1000 gas fired condensing combi boiler (Installed in 2025 with a 5 year warranty).

#### Shower Room

8' 11" x 5' 0" (2.71m x 1.53m) Single shower cubicle with mains fed shower and tiled surround. White low level W.C and pedestal wash hand basin. Part tiled walls. Radiator.

### OUTSIDE

The property is approached to the front via a wooden gate, opening to a pathway and a small garden. To the rear is an enclosed garden with fenced and hedge boundaries. An allocated parking space is located within the nearby residents parking area.

### COUNCIL TAX

Cornwall Council. Tax Band 'B'.

### DIRECTIONS

Approaching Lostwithiel from the west on the A390, continue down the hill into the town and take the first left-hand turning into Tanhouse Road. Proceed until Uzella Park is identified on the right-hand side and No.22 is located within the front terrace that faces the stream.

Energy Efficiency Rating		
	Current	Potential
Very energy efficient - lower running costs		
(92-100) <b>A</b>		91
(81-91) <b>B</b>		
(69-80) <b>C</b>	73	
(55-68) <b>D</b>		
(39-54) <b>E</b>		
(21-38) <b>F</b>		
(1-20) <b>G</b>		
Not energy efficient - higher running costs		
England, Scotland & Wales		
EU Directive 2002/91/EC		

### ENERGY RATING





**LOUNGE/DINER**



**OVERVIEW OF GARDEN FROM FIRST FLOOR**



**KITCHEN**



**SHOWER ROOM**



**BEDROOM ONE**



**REAR GARDEN**



**BEDROOM TWO**



**REAR ELEVATION**



GROUND FLOOR

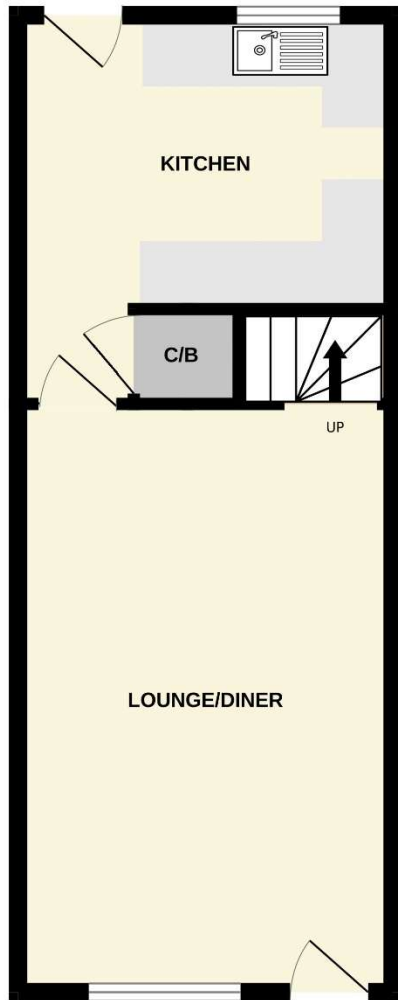

1ST FLOOR

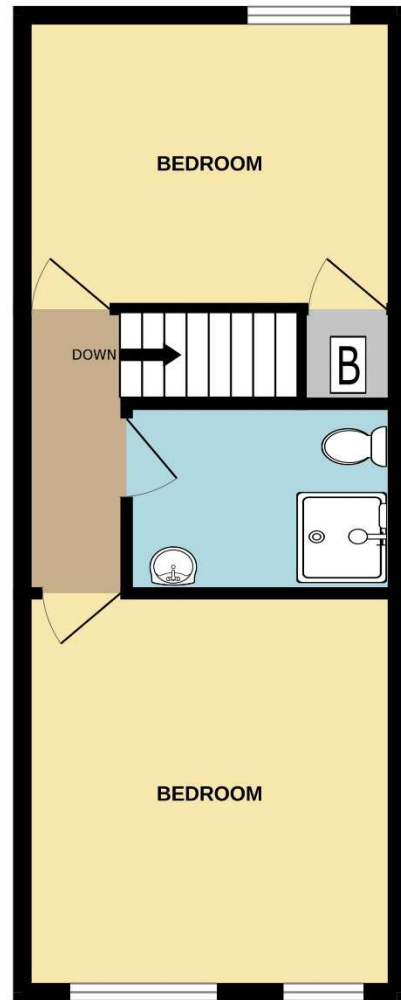

Measurements are approximate. Not to scale. Illustrative purposes only.  
Made with Metropix ©2023

## FLOOR PLAN (FOR ILLUSTRATION PURPOSES ONLY, NOT TO SCALE)

### Members of the NAEA



#### St Austell

18 Duke St, St Austell  
PL25 5PH  
01726 73483  
staustell@jefferys.uk.com

#### Lostwithiel

5 Fore St, Lostwithiel  
PL22 0BP  
01208 872245  
lostwithiel@jefferys.uk.com

#### Liskeard

17 Dean St, Liskeard  
PL14 4AB  
01579 342400  
liskeard@jefferys.uk.com

ESTABLISHED 1865  
**Jefferys**

CONSUMER PROTECTION FROM UNFAIR TRADING REGULATIONS 2008: The Agent has not tested any apparatus, equipment, fixtures and fittings or services and so cannot verify that they are in working order or fit for the purpose. A Buyer is advised to obtain verification from their Solicitor or Surveyor. References to the Tenure of a Property are based on information supplied by the Seller. The Agent has not had sight of the title documents. A Buyer is advised to obtain verification from their Solicitor. Items shown in photographs are not included unless specifically mentioned within the sales particulars. They may however be available by separate negotiation. Buyers must check the availability of any property and make an appointment to view before embarking on any journey to see a property. IN ACCORDANCE WITH GDPR (GENERAL DATA PROTECTION REGULATION): Please note that all personal information provided by customers wishing to receive information and/or services from the estate agent and the "Experts in Property" of which Jeffery's is a member for the purpose of providing services associated with the business of an estate agent but specifically excluding mailings or promotions by a third party. If you do not wish your personal information to be used for any of these purposes, please notify your estate agent.