

**ALLDAY
& MILLER**



Wheatley Crescent, Hayes, UB3 2JF
£475,000

 2  1  1  D



Wheatley Crescent, Hayes, UB3 2JF

£475,000

- Two Bedrooms
- Double Fronted
- Chain Free Sale
- Walking Distance To Hayes Town Centre
- Driveway
- Freehold House
- Plans For 4M Rear Extension
- Good Schools Nearby
- Private Rear Garden
- Easy Reach To An Elizabeth Line Station

Description

This well-presented family home offers a practical and comfortable layout, perfect for everyday living.

The ground floor comprises a bright reception room and a fitted kitchen, providing functional living space for both relaxing and dining.

To the first floor, the property enjoys three bedrooms and a family bathroom.

Externally, the home benefits from a front driveway with off-street parking and a private rear garden, offering a pleasant outdoor space for dining and entertainment.

Situation

Wheatley Crescent a perfectly located residential road in the heart of Hayes. The town centre just moments away with a variety of local cafes, coffee shops, Botwell leisure centre and supermarkets. Hayes and Harlington station 0.6 miles away with the Elizabeth line giving easy links to central London and back towards Heathrow and Reading. Also benefits from being close to multiple bus links connecting you to all local areas such as Uxbridge, Northolt, Greenford, Heathrow, Ealing and Harrow The M25, M4 motorways are just a short drive away. A number of highly regarded schools in the local area including Botwell House Catholic Primary School and Harlington secondary school.



Floor Plans

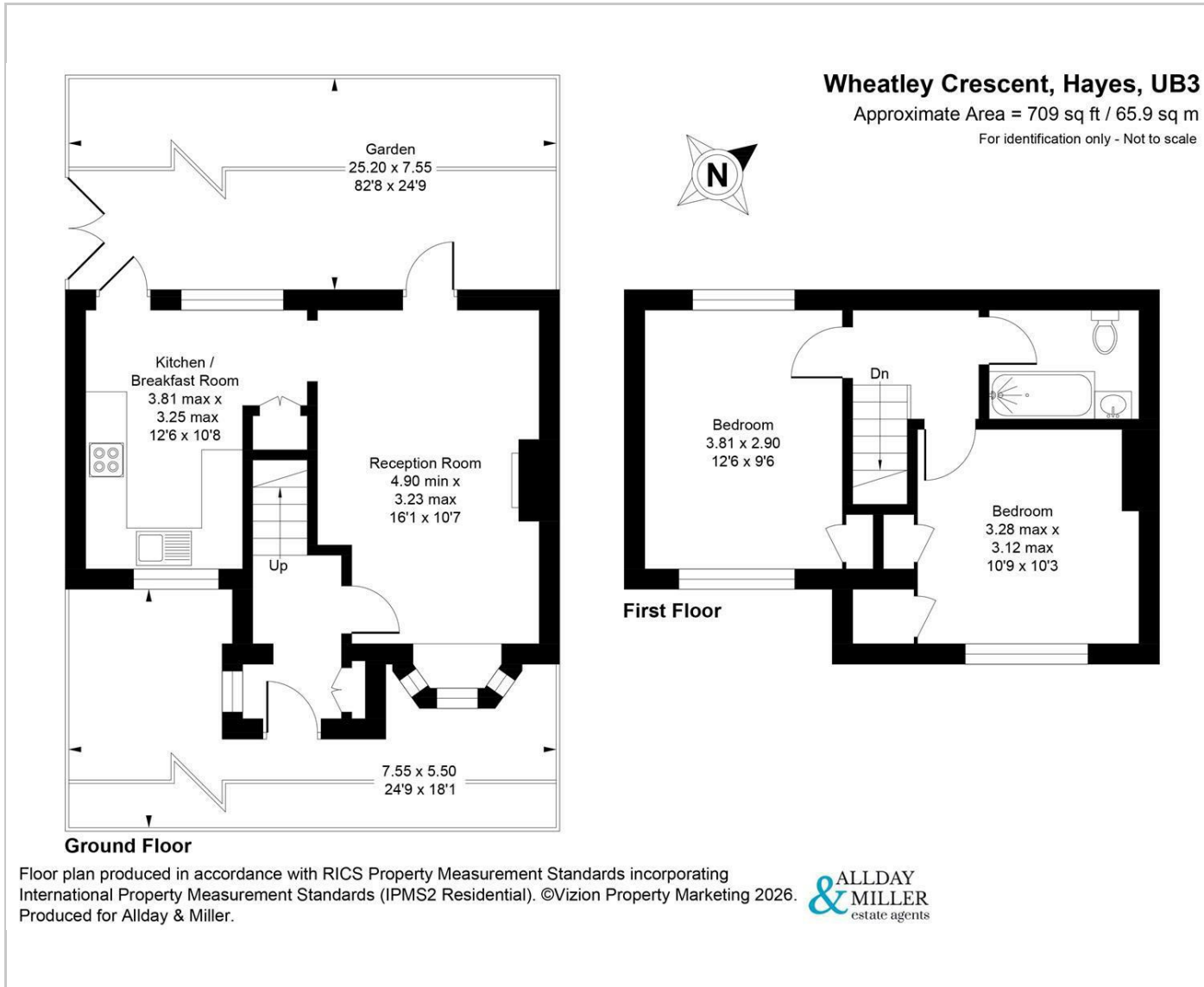

Area Map

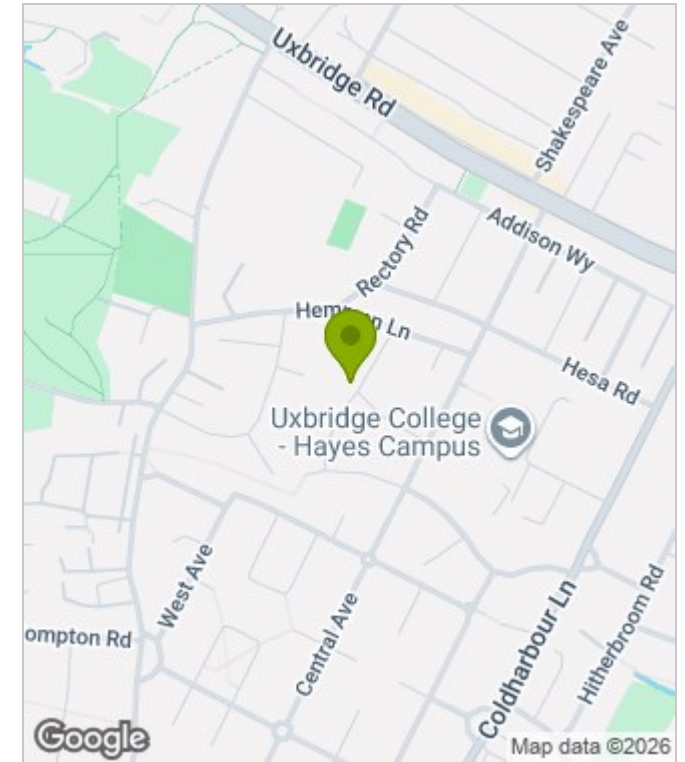

Energy Performance Graph

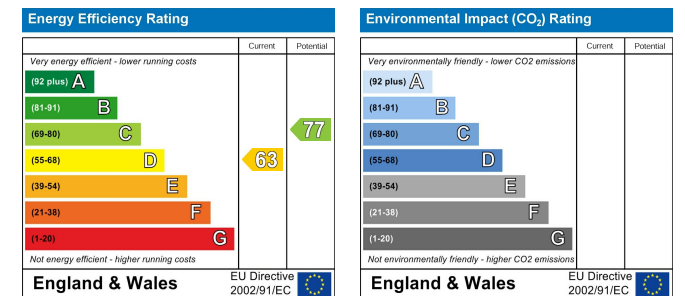

These particulars, whilst believed to be accurate are set out as a general outline only for guidance and do not constitute any part of an offer or contract. Intending purchasers should not rely on them as statements of representation of fact, but must satisfy themselves by inspection or otherwise as to their accuracy. No person in this firm's employment has the authority to make or give any representation or warranty in respect of the property.