



13 Wordsworth Court, Byron Crescent, Bedford, MK40 2EJ



13 Wordsworth Court
Byron Crescent
Bedford
MK40 2EJ

Price £160,000

Ground floor apartment

Two bedrooms

Living room

Kitchen

Bathroom

Gas central heating

Communal parking

No chain

Leasehold



- Council Tax Band B
- Energy Efficiency Rating C

Ideal first time buy or buy to let purchase...



This modern purpose-built apartment forms part of a development of similar homes and could make an ideal first-time purchase, or perhaps, someone looking for a buy to let.

The property is situated on the ground floor and is approached via a communal hallway with security door, serving just four homes.

The accommodation is well presented throughout and includes a spacious living/dining room, a fitted kitchen, two bedrooms and a bathroom.

Benefits include gas central heating, double glazing and communal parking.

The location is very convenient for Bedford's town centre facilities and is a short walk from a Sainsbury's and an Aldi. The mainline railway station is approximately 0.7 miles away, for fast and frequent connections to the capital and beyond.

There is no chain, so a quick completion is available.

Lease term: 125 years from 1st April 1982 (approx. 81 years remaining)

Ground rent: £10 per annum

Service charge: Estimated £1850.16 from 1 April 2025 to 31 March 2026.

These details should be verified by your own legal advisor.



Byron Crescent, Bedford, MK40

Approximate Area = 652 sq ft / 60.5 sq m

For identification only - Not to scale

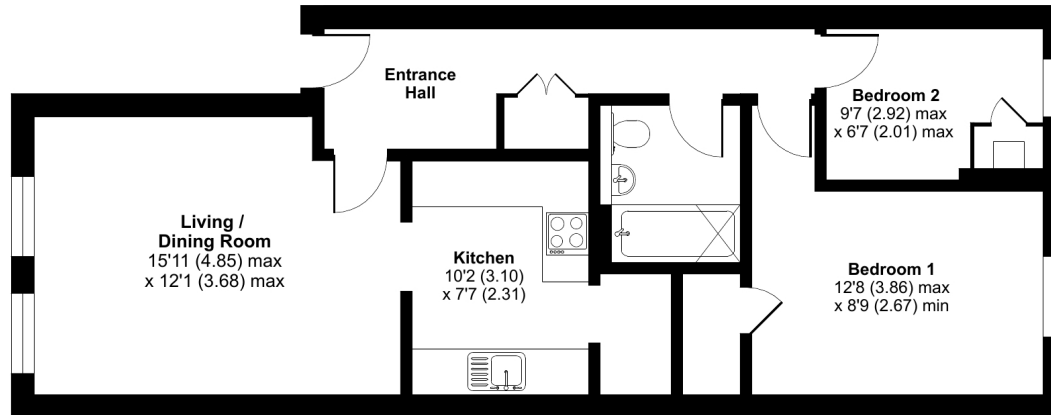

GROUND FLOOR

 Floor plan produced in accordance with RICS Property Measurement 2nd Edition, Incorporating International Property Measurement Standards (IPMS2 Residential). © nichecom 2026. Produced for Lane & Holmes. REF: 1408279



01234 327744 | sales@laneandholmes.co.uk | www.laneandholmes.co.uk | 66-68 St Loyes Street, Bedford, Bedfordshire, MK40 1EZ

Agents Notes: The agent has not tested any apparatus, equipment, fixtures & fittings or services and so cannot verify that they are in working order or fit for the purpose. A buyer is advised to obtain verification from their solicitor or surveyor. All photographs shown are for illustration only and may depict items that are not for sale or included in the sale of the property. Please note that we have not checked the situation with regards to planning consents, building regulation consents and any other relevant consent relating to this property and therefore, any interested applicant should carry out their own enquiries with the appropriate authorities. All measurements are approximate and for guidance only. The particulars do not form part of any contract and all properties are offered subject to contract.

