

## Lynton Terrace, W3

£2,200 Per calendar month

A beautifully presented ground floor maisonette located on a quiet residential road, benefits from two spacious double bedrooms, a separate kitchen and direct access to a low maintenance garden.

Lynton Terrace is a quiet residential road, conveniently located just off of Horn Lane, with easy access to local Shops, Cafe's and Acton Main Line (Elizabeth Line)

### Features

- Two Double Bedroom
- Wood Floors
- Separate Kitchen
- Private Garden
- Private Entrance
- Off Street Parking Space

Lynton Terrace,  
London, W3

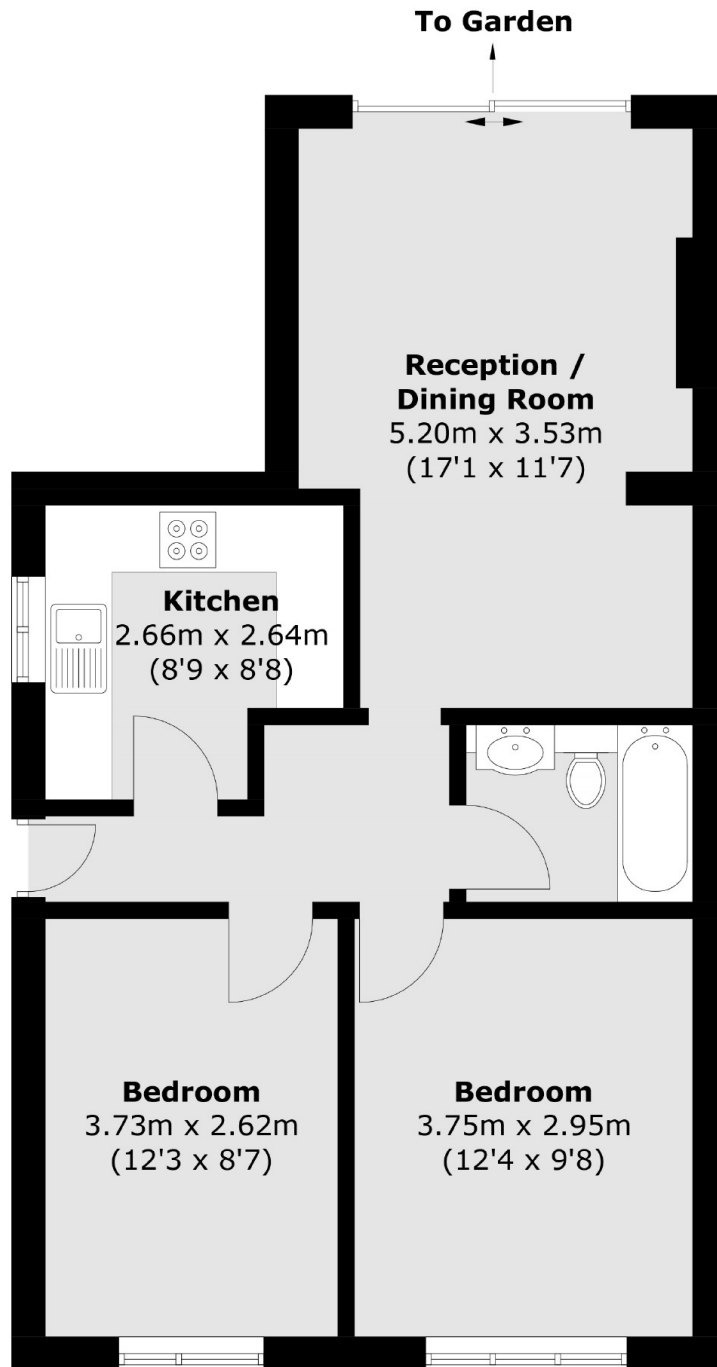

Total area (approx.): 55.7 sq. m (599.5 sq. ft)