



Brondesbury Park, NW6

£2,500 pcm



- Two Double Bedrooms
- Open Plan

- Modern
- First Floor

- Off Street Parking
- Queens Park

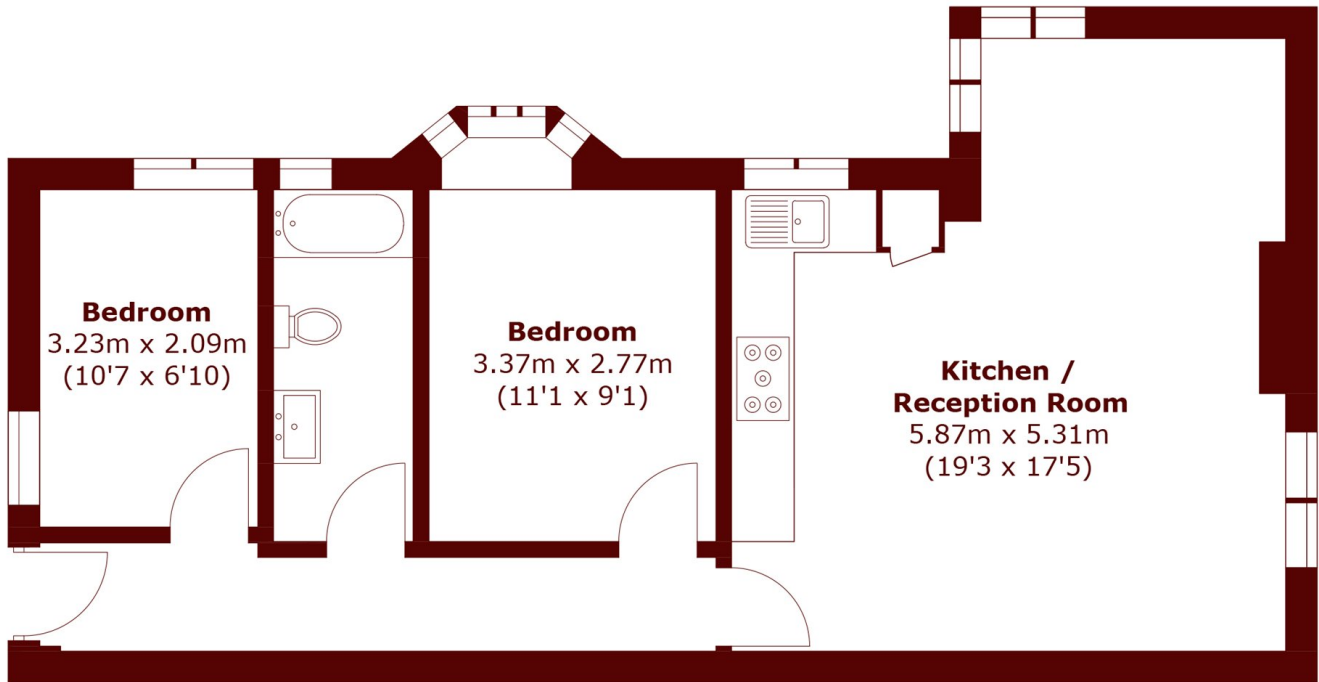

Total area (approx.): 57.1 sq. m (614.6 sq. ft)

Marsh & Parsons Queen's Park

56 Salisbury Road, London,
NW6 6NN
020 7624 4513