



Goddard Way, Saffron Walden **Freehold** £325,000



Kevin  
Henry

# Key Features



- Three-bedroom family house
- Good size living space
- Large kitchen/diner
- Living room
- Stylish bathroom

Well presented family home with excellent living space and only minutes walk from the town centre. The property benefits from a good size living room, open plan kitchen/diner and downstairs cloakroom. Upstairs are three good size bedrooms and modern bathroom plus access to the part boarded loft and airing cupboard.

The rear garden offers both a lawn area and patio area with rear access to further parking.

This is a great opportunity to secure a ready to move into home close to all local amenities.

Saffron Walden is a fine old market town with a good range of shopping, schooling and recreational facilities, including the renowned



Saffron Hall, which is situated at the County High School. The town also boasts an independent, award-winning cinema showing mainstream and art house films, a museum and art galleries. There are several sports facilities, including The Lord Butler Fitness and Leisure Centre, with its two swimming pools, squash and tennis courts, health suite, gym and creche. Audley End mainline station (with fast trains to Liverpool Street and Cambridge) is just two miles distance and the M11 access point at Stump Cross 4 miles.

Hallway

Lounge  
4.40m x 3.60m  
14'5" x 11'10"

Kitchen/Diner  
6.00m x 2.60m  
19'7" x 8'6"

Cloakroom

Landing  
Airing cupboard and access to partly boarded loft.



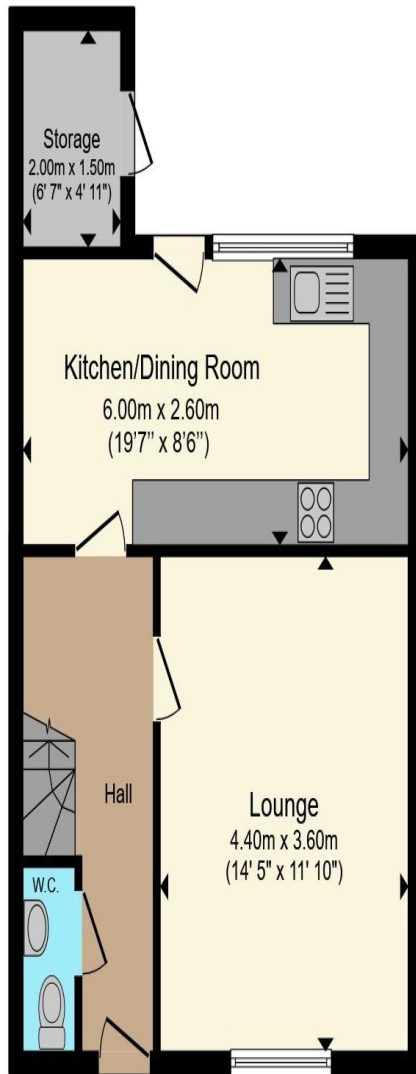

**Ground Floor**

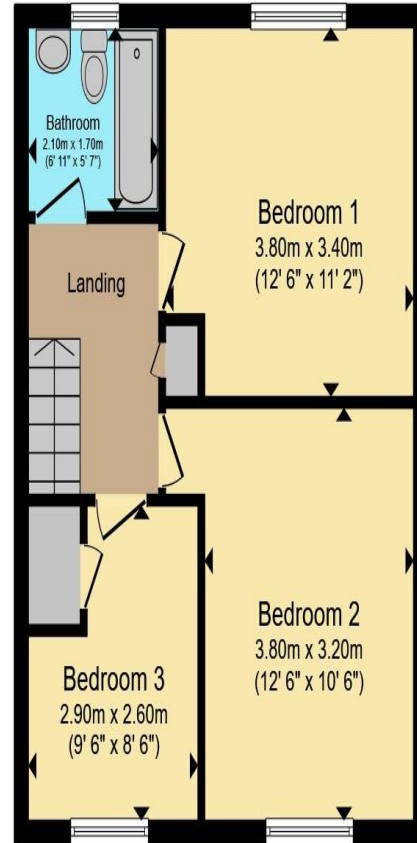

**First Floor**

Total floor area 89.3 sq.m. (961 sq.ft.) approx

This floor plan is for illustrative purposes only. It is not drawn to scale. Any measurements, floor areas (including any total floor area), openings and orientation are approximate. No details are guaranteed, they cannot be relied upon for any purpose and they do not form part of any agreement. No liability is taken for any error, omission or misstatement. A party must rely upon its own inspection(s). Powered by [www.propertybox.io](http://www.propertybox.io)



**Bedroom One**  
3.80m x 3.40m  
12'6" x 11'2"

**Bedroom Two**  
3.80m x 3.20m  
12'6" x 10'6"

**Bedroom Three**  
2.90m max x 2.60m max  
9'6" max x 8'6" max  
Built in over stair storage cupboard.

**Bathroom**  
**Garden**  
Private rear garden with lawn and patio and rear access to parking.

To view this property call Kevin Henry on:  
01799 513632

# Selling your property?

Contact us to arrange a FREE home valuation.

 01799 513632

 1 Market Street, SAFFRON WALDEN, Essex, CB10 1JB

 [sales@kevinhenry.co.uk](mailto:sales@kevinhenry.co.uk)

 [www.Kevinhenry.co.uk](http://www.Kevinhenry.co.uk)



 SCAN ME



Kevin Henry is a trading name of Sharman Quinney Holdings Limited which is registered in England and Wales under company number 4174227, Registered Office is Cumbria House, 16-20 Hockliffe Street, Leighton Buzzard, Bedfordshire, LU7 1GN. VAT Registration Number is 500 2481 05.

1: These particulars do not constitute part or all of an offer or contract. 2: The measurements indicated are supplied for guidance only and as such must be considered incorrect. 3: Potential buyers are advised to recheck the measurements before committing to any expense. 4: Kevin Henry has not tested any apparatus, equipment, fixtures, fittings or services and it is the buyers interests to check the working condition of any appliances. 5: Kevin Henry has not sought to verify the legal title of the property and buyers must obtain verification from their legal representative. 6: Intending purchasers will be asked to produce identification documentation at a later stage and we would ask your co-operation in order that there will be no delay in agreeing the sale. Ref: SAF103854 - 0008

