



Riviera Drive | | Liverpool | L11 4US

£145,000



Riviera Drive |  
 Liverpool | L11 4US  
 £145,000

Nestled in the charming area of Riviera Drive, Liverpool, this delightful three-bedroom house offers a perfect blend of comfort and modern living. Built in 2003, the property spans an inviting 602 square feet, making it an ideal choice for families or individuals seeking a cosy yet spacious home.

Upon entering, you are welcomed into a well-proportioned reception room, which serves as a versatile space for relaxation or entertaining guests. The natural light that floods this area creates a warm and inviting atmosphere, perfect for unwinding after a long day.



- 3 cosy bedrooms
- Spacious reception room
- 602 sq ft of space
- Easy access to transport
- Viewing recommended
- Modern bathroom
- House on Riviera Drive
- Close to local amenities
- Ideal for families

Approx Gross Internal Area  
 57 sq m / 618 sq ft

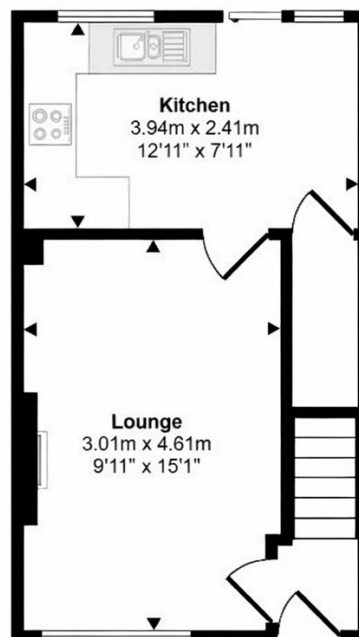

Ground Floor  
 Approx 28 sq m / 306 sq ft

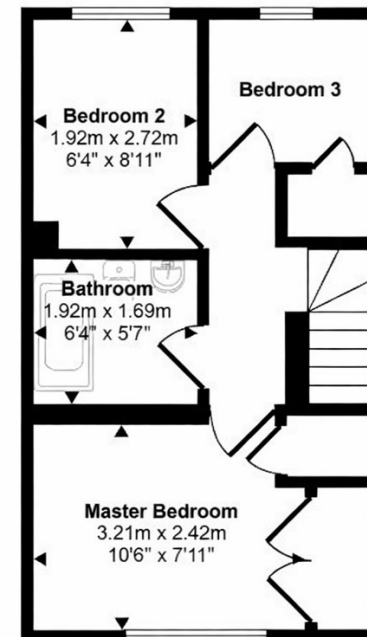

First Floor  
 Approx 29 sq m / 312 sq ft

Energy Efficiency Rating		Current	Potential
<i>Very energy efficient - lower running costs</i>			
(92 plus)	A		
(81-91)	B		
(69-80)	C		
(55-68)	D		
(39-54)	E		
(21-38)	F		
(1-20)	G		
<i>Not energy efficient - higher running costs</i>			
<b>England &amp; Wales</b>		EU Directive 2002/91/EC	

Council Tax Band A  
 EPC Rating C

14 Park Brow Drive  
 Kirkby  
 Merseyside  
 L32 6QP  
 0151 289 8585  
 jodie@dorankennedy.co.uk