



Agate Close, NW10

£2,600 Per calendar month

This executive style apartment with an allocated parking is ideal for a family or three professional sharers looking for a central yet convenient retreat. The entertaining space with open plan kitchen and private balcony is a bonus.

Agate Close is within half a mile of both Hanger Lane and Park Royal stations both of which provide excellent access into town.

Features

- Three Double Bedrooms
- Two Bathrooms
- Open Plan Kitchen
- Private Balcony
- Allocated Parking
- Ample Storage Space

Agate Close,
London, NW10

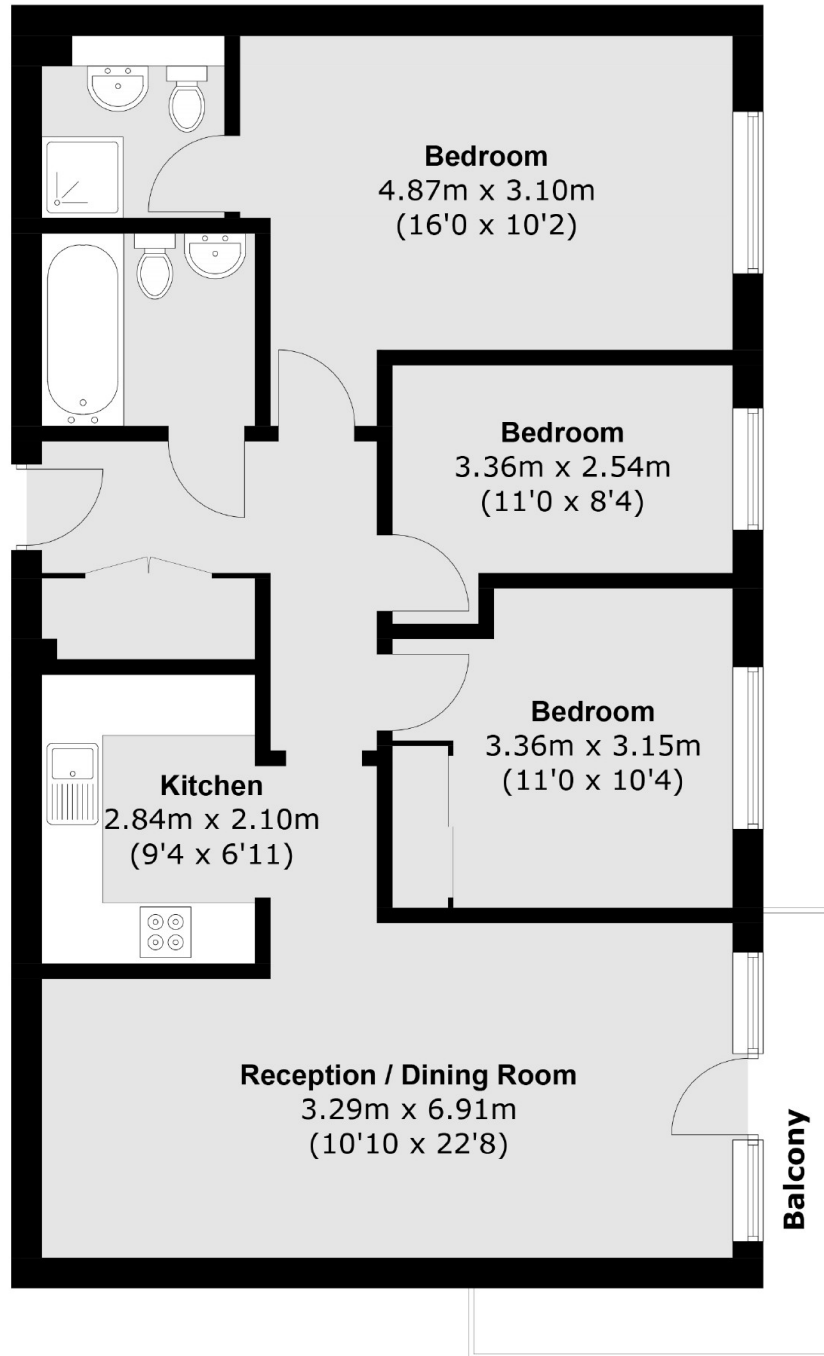

Total area (approx.): 82.2 sq. m (884.8 sq. ft)
Balcony: 4.7 sq. m (50.6 sq. ft)