



Shannon Place

London, NW8

£2,500 per month
(£576.92 per week)

A bright and spacious property located on the fourth floor (lift access) in this purpose building moments from St. John's Wood High Street



Shannon Place

London, NW8

- A Bright and Spacious Property in a Purpose Building
- 2 Bedroom, 1 Bathroom, 1 W/C
- Communal Garden
- Located Moments from St. John's Wood High Street



This bright property comprises 2 double bedrooms, 1 bathroom, 1 W/C, large reception room, separate fully equipped kitchen and communal gardens.

The building is located moments from St John's Wood High Street, St. John's Wood Underground (Jubilee Line) and Regent's Park.

Minimum Term: 6 months
Deposit Required: £2,884.62
Local Authority: City Of Westminster
Council Tax Band: E
EPC Rating: D
Furnished

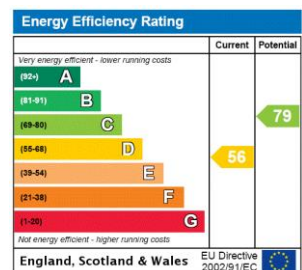

Chestertons St John's Wood Lettings

122 St John's Wood High Street
 St John's Wood
 London
 NW8 7SG
 lettings.stjohnswood@chestertons.co.uk
 02030408622
 chestertons.co.uk

Additional tenant charges apply (fees apply to non-AST tenancies only)
 Tenancy Agreement Fee: £300
 References per Tenant/Guarantor: £60
 Inventory check (approx. £100 – £250 inc. VAT)
chestertons.co.uk/property-to-rent/applicable-fees

Eamont Court, NW8

Approximate Gross Internal Area

702 sq ft / 65.21 sq m

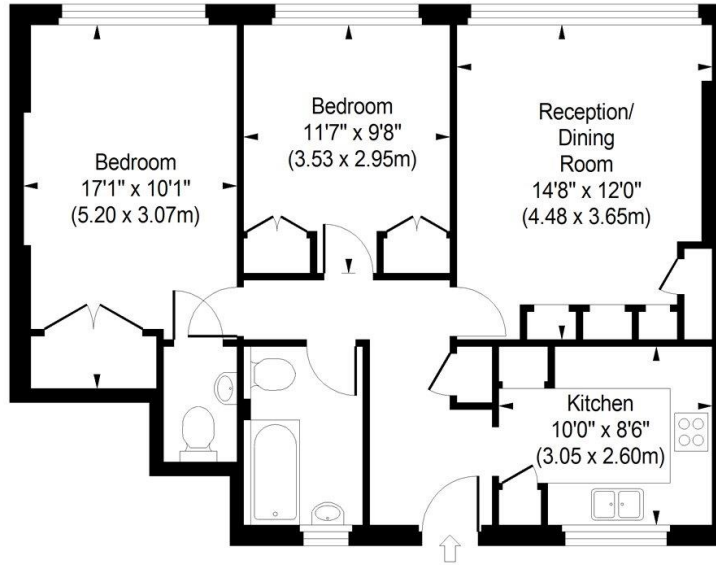

Fourth Floor

ILLUSTRATION FOR IDENTIFICATION PURPOSES ONLY

ALL MEASUREMENTS ARE MAXIMUM, AND INCLUDE WINDOW BAYS AND WARDROBES WHERE APPLICABLE
THIS PLAN MUST NOT BE REPRODUCED BY ANY OTHER PERSON WITHOUT PERMISSION

