



Oriel Court, Didcot, Oxfordshire. OX11 8UG



Hodsons
...your move, our passion
Sales | Lettings

Oriel Court, Didcot.

A well presented two bedroom mid terrace property situated on Oriel Court in Didcot. With a welcoming entrance with useful understairs storage cupboard, the kitchen has ample storage and space for white goods with integrated oven and hob. The bright and airy comfortable lounge offers a lovely family space with a door leading out into the garden.

The first floor offers the comfortable main bedroom with fitted wardrobes and a second double bedroom with two useful storage cupboards.

The garden is mainly laid to lawn with a covered patio area, perfect for entertaining.

There is an allocated parking space in the nearby parking area. Viewing is highly recommended.

Situated within easy walking distance of the town centre and Didcot Train Station. The property is close to local primary and secondary schools and has excellent links to the A34, M4 and M40.



- Welcoming entrance with useful understairs storage
- Kitchen has ample storage and space for white goods
- Comfortable bright and airy lounge with door leading into the garden
- Generous main bedroom with fitted wardrobes
- Second double bedroom with two useful storage cupboards
- Modern family bathroom with shower over the bath
- Garden is mainly laid to lawn with a covered patio area perfect for entertaining
- One allocated parking space in the nearby parking area

2		bedrooms	Council Tax Band: C
1		receptions	Tenure: Freehold
1		bathrooms	EPC Rating:



The bright and airy comfortable lounge offers a lovely family space with a door leading out into the garden



The first floor offers the comfortable main bedroom with fitted wardrobes and a second double bedroom with two useful storage cupboards







The garden is mainly laid to lawn with a covered patio area, perfect for entertaining. There is an allocated parking space in the nearby parking area

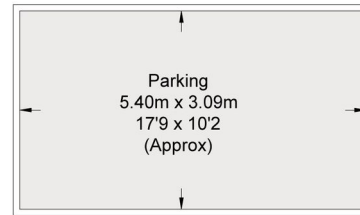

(Not Shown In Actual Location / Orientation)

Oriel Court, OX11
Approximate Gross Internal Area = 55.7 sq m / 600 sq ft
Parking = 16.7 sq m / 180 sq ft
Total = 72.4 sq m / 779 sq ft
For identification only - Not to scale

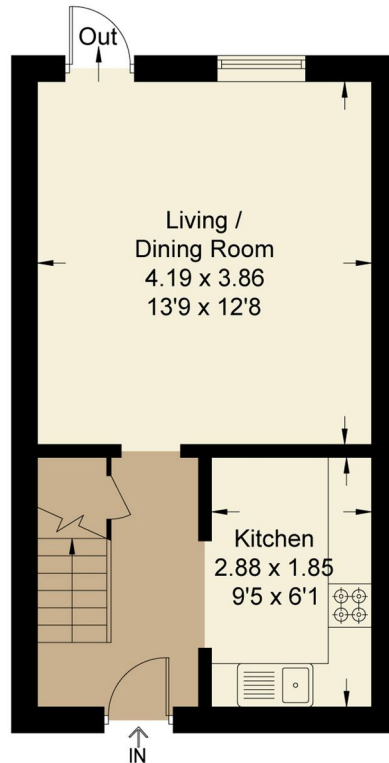

Ground Floor

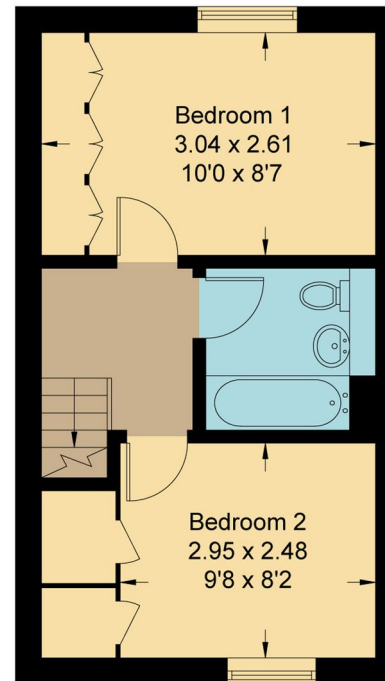

First Floor

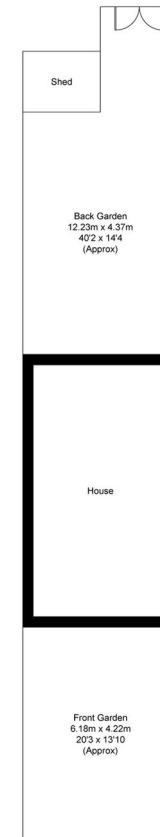

Not to scale, for illustration and layout purposes only.
© Mortimer Photography. Produced for Hodsons.
Unauthorised reproduction prohibited

220 Broadway, Didcot, Oxon,
OX11 8RS

T: 01235 511406
E: didcot@hodsons.co.uk

www.hodsons.co.uk

 **Hodsons**
...your move, our passion
Sales | Lettings