



## SOMERFIELD ROAD, LONDON, N4

### 2 BED APARTMENT

£2,150 PCM

NO LIVING ROOM - A two bedroom, second floor period conversion set moments from Finsbury Park station. The property comprises of two double bedrooms, separate kitchen, private garden and a modern tiled bathroom. The apartment has wood flooring throughout.

Well located for easy access to Finsbury Park tube (3 mins walk) servicing the Victoria Line, with the vibrant local shops and amenities located moments away

**Hemmingfords**

Somerfield Road, N4

Approximate Gross Internal Area = 34.4 sq m / 370 sq ft

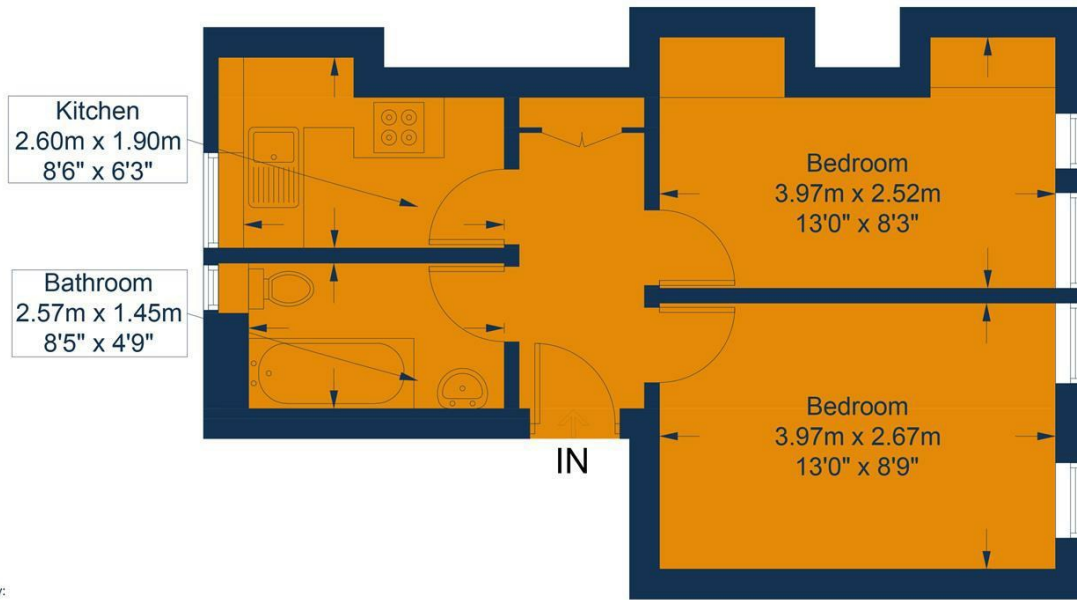

**First Floor**

Brought to you by:

**Hemmingfords**

This plan is for layout guidance only and is not to scale unless stated. All dimensions, including windows, doors, fittings, and the total area, are approximate measurements. Produced by a



Energy Efficiency Rating		
	Current	Potential
Very energy efficient - lower running costs		
(92 plus) <b>A</b>		
(81-91) <b>B</b>		
(69-80) <b>C</b>	75	79
(55-68) <b>D</b>		
(39-54) <b>E</b>		
(21-38) <b>F</b>		
(1-20) <b>G</b>		
Not energy efficient - higher running costs		
<b>England &amp; Wales</b>	EU Directive 2002/91/EC	

Agents Note: Whilst every care has been taken to prepare these particulars, they are for guidance purposes only. All measurements are approximate and are for general guidance purposes only and whilst every care has been taken to ensure their accuracy, they should not be relied upon and potential buyers/tenants are advised to recheck the measurements

Hemmingfords Lettings  
 34 Upper Street  
 London  
 N1 0PN

020 3890 7470  
 info@hemmingfords.co.uk  
 www.hemmingfords.co.uk

**Hemmingfords**