



152A Portland Road

Hove, BN3 5QL

Price £350,000

Pearson Keehan are delighted to present this well-proportioned three-bedroom maisonette, ideally positioned in the heart of the ever-popular West Hove. Offering generous and versatile accommodation arranged over two floors, the property will appeal to a wide range of buyers including first-time purchasers, professionals and investors alike.

Occupying the first and second floors of an attractive period building, the first floor comprises a spacious and bright living room, a separate fitted kitchen, a contemporary bathroom and a well-sized double bedroom. The second floor offers two further double bedrooms which includes the 16' principle room which enjoys views towards the church.

Located on Portland Road, the maisonette enjoys immediate access to a vibrant and diverse range of local amenities including independent shops, cafés, restaurants and popular bars. The area is well known for its strong community feel and excellent transport links, with Aldington train station just a five-minute walk away and Hove mainline railway station just over half a mile away, providing convenient connections to London and beyond. The seafront, green open spaces and the wider attractions of Hove and Brighton are also within easy reach, making this a highly desirable location for both lifestyle and convenience.

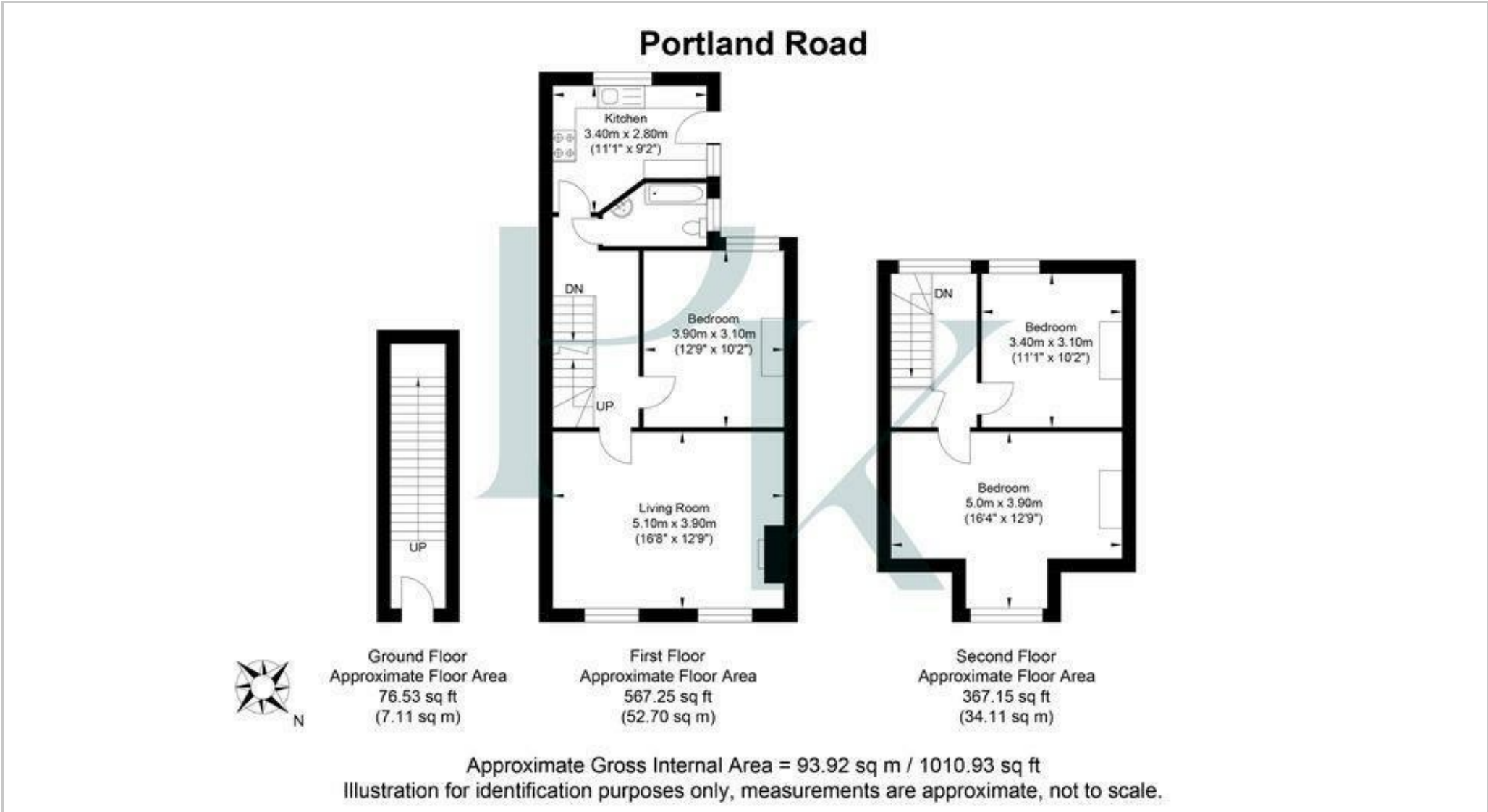

Energy Efficiency Rating	
Current	Potential
Very energy efficient - lower running costs	
(92 plus) A	
(81-91) B	
(69-80) C	
(55-68) D	
(39-54) E	
(21-38) F	
(1-20) G	
Not energy efficient - higher running costs	
68	74
England & Wales	
EU Directive 2002/91/EC	

Environmental Impact (CO ₂) Rating	
Current	Potential
Very environmentally friendly - lower CO ₂ emissions	
(92 plus) A	
(81-91) B	
(69-80) C	
(55-68) D	
(39-54) E	
(21-38) F	
(1-20) G	
Not environmentally friendly - higher CO ₂ emissions	
England & Wales	
EU Directive 2002/91/EC	

Pearson
Keehan