

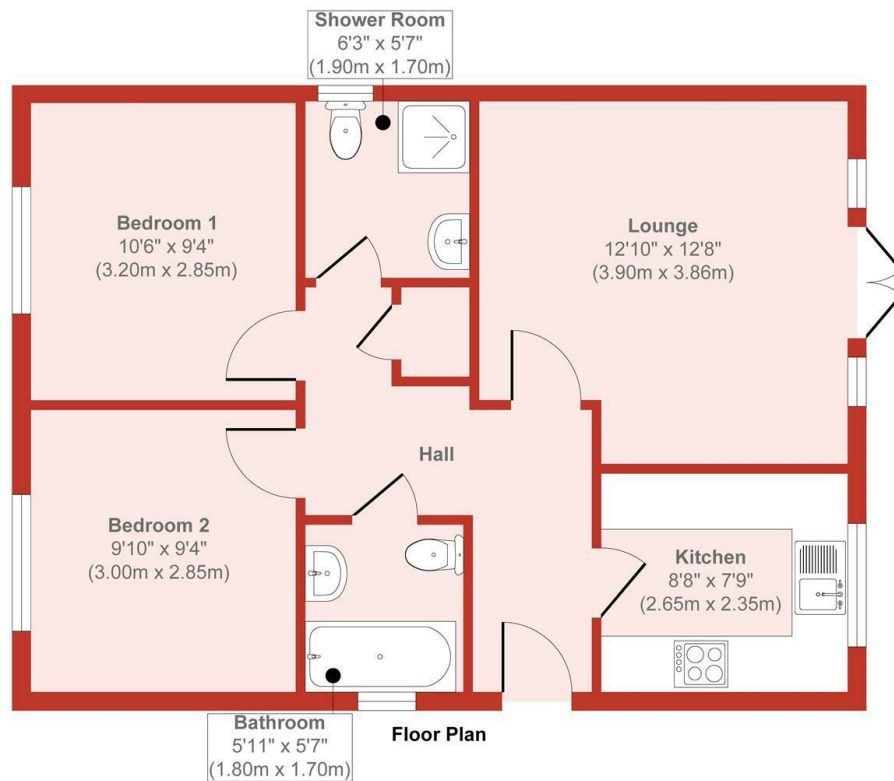

5 Emma Close, The Broadway, Northborne, Dorset, BH10 7AB

£325,000

- Two Double Bedrooms
- UPVC Double Glazing
- Detached Modern Bungalow
- No Forward Chain
- Spacious Open Plan Lounge / Dining Room
- Gas Central Heating
- Driveway & Garage
- En-suite To Bedroom One
- Well Presented
- Secluded Location



Approx. Gross Internal Floor Area 600 sq. ft / 55.75 sq. m
Produced by Elements Property

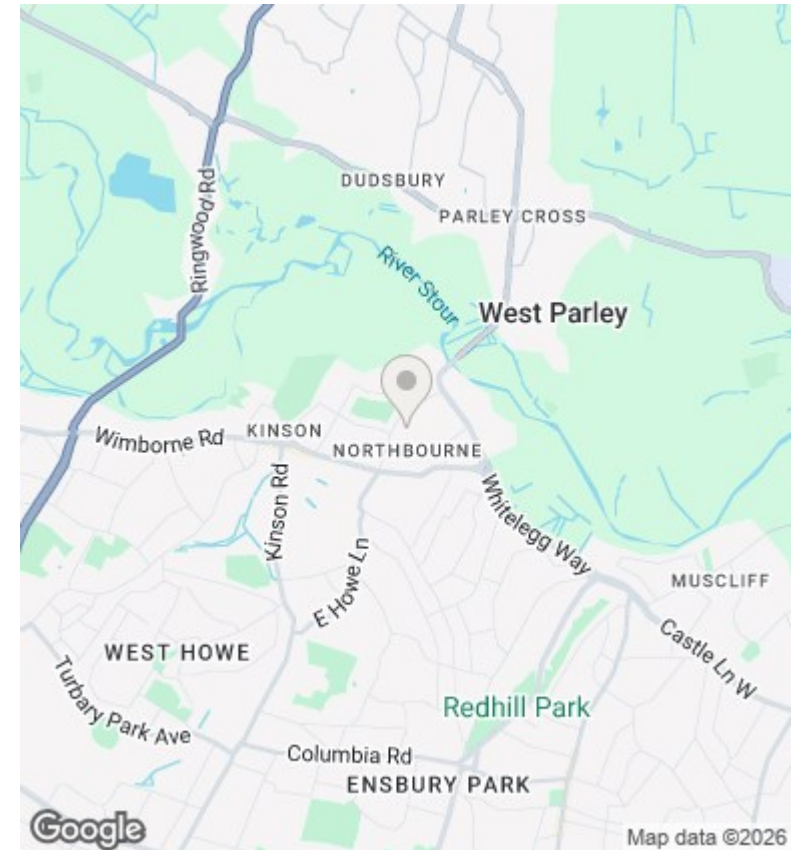

Directions

Viewings

Viewings by arrangement only. Call 01202 749390 to make an appointment.

Council Tax Band

EPC Rating:

C

Energy Efficiency Rating		Current	Potential
Very energy efficient - lower running costs			
(92 plus)	A		92
(81-91)	B		
(69-80)	C	75	
(55-68)	D		
(39-54)	E		
(21-38)	F		
(1-20)	G		
Not energy efficient - higher running costs			
England & Wales		EU Directive 2002/91/EC	