



Moorland Place, Stannington, S6 6BU

£290,000

3 1 1



Why You'll Love It

Stepping through the front door, you're welcomed into a bright and functional kitchen positioned at the front of the property. Thoughtfully designed with a range of fitted units, generous worktop space, and room for essential appliances, this is a space that caters effortlessly to both day-to-day living and more sociable occasions. Whether it's a quick breakfast before work or preparing meals for friends and family, the layout is both practical and inviting.

Moving through the hallway, the home continues to impress with its clever use of space. There is ample built-in storage for coats, shoes, and household essentials, helping to keep the home organised and clutter-free. A convenient ground floor W.C. adds to the functionality, an essential feature for modern family living.

To the rear, the property truly comes into its own. The main living room is a warm and welcoming retreat, perfect for relaxing evenings, and flows seamlessly into the extended dining area. This additional space enhances the overall footprint of the home, creating a light-filled and sociable hub that's ideal for entertaining or enjoying family time. Doors open directly onto the rear garden, allowing natural light to flood in and creating a seamless connection between indoor and outdoor living.

The garden itself has been designed with low maintenance in mind, offering a stylish yet practical outdoor space that can be enjoyed year-round without the need for constant upkeep. This flexible space is perfect for remote working, hobbies, or fitness, and adds a valuable dimension to the home.

Upstairs, the property offers well-proportioned accommodation comprising two generous double bedrooms and a comfortable single bedroom, ideal as a nursery, guest room, or dedicated home office. The family bathroom is well-appointed with a clean, modern finish, completing the internal layout. Throughout, the home is presented to a good standard, allowing a buyer to move straight in and make it their own over time.

Why We Love It

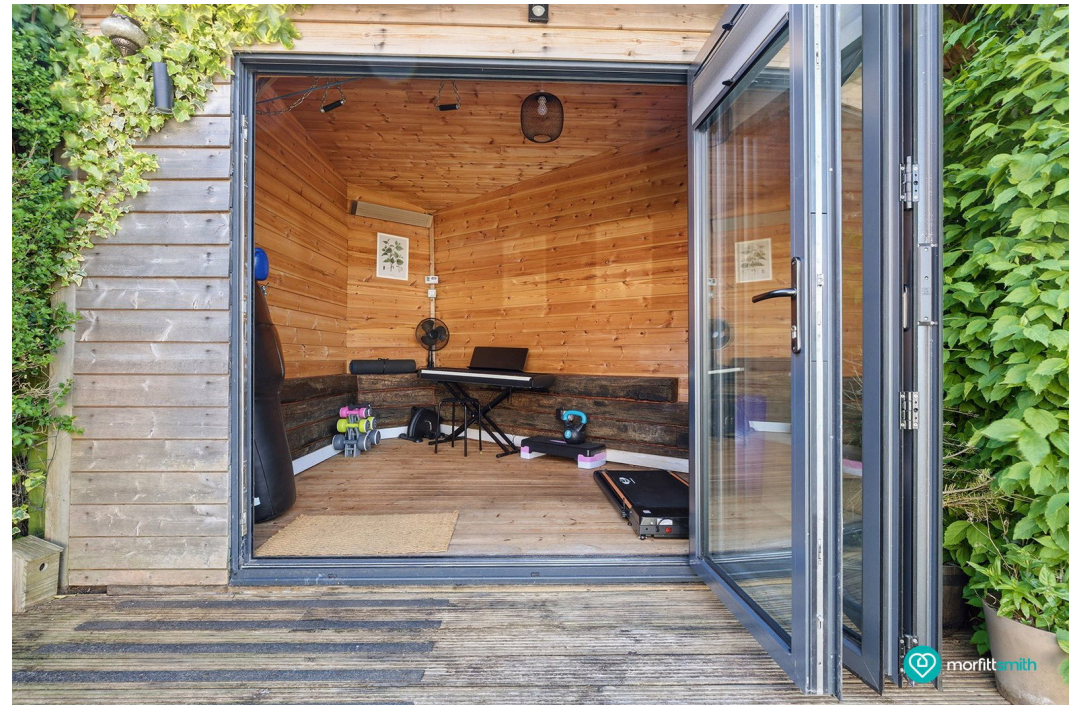

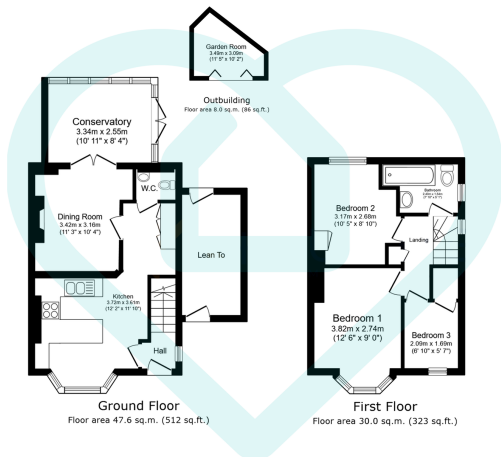

Total floor area: 85.6 sq.m. (921 sq.ft.)

This floor plan is for illustrative purposes only. All measurements and layouts are approximations and do not necessarily capture the precise specifications of the property. No responsibility is taken for any error, omission, or misstatement. We always recommend viewing in person to confirm the exact floor plan of a property. Made with Metropix.



- Popular Stannington Location
- Set In A Quiet Cul-De-Sac
- Three Bedroom Semi Detached Home
- Low Maintenance Rear Garden - With Garden Room/ Office Space
- Plenty Of Storage Throughout
- Well Presented Throughout
- Good Transport Links
- Edge Of The Peak District
- Private Driveway
- Close To Local Shops, Pubs and Cafe's

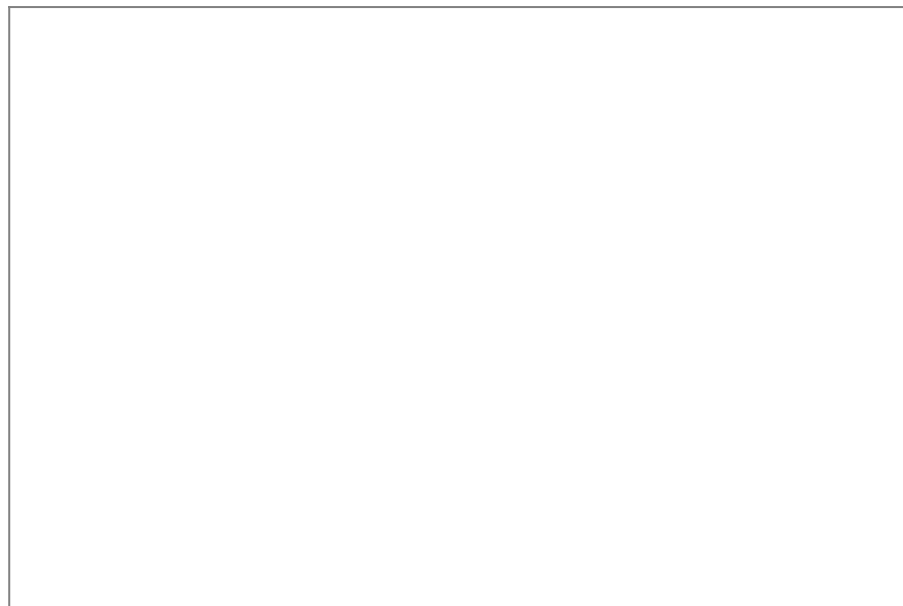

Sales | Lettings | New Homes

VAT Reg Number: 191 3588 84
 Company Reg Number: 08610489
 Company Reg Address: 67 Middlewood Road, Hillsborough, Sheffield, S6 4GX.

The MorfittSmith Building
 67 Middlewood Road
 Hillsborough
 Sheffield
 S6 4GX

Get in touch - arrange an appointment

0114 232 1764
 sales@morfittsmith.co.uk
 lettings@morfittsmith.co.uk
 newhomes@morfittsmith.co.uk
 www.morfittsmith.co.uk

@MorfittSmith
 @MorfittSmith
 MorfittSmith Estate & Letting Agent