



Norwood Road, March
£220,000 Freehold

**Sharman
Quinney**

Key Features



- No Onward Chain
- Walking Distance to Train Station and Town Centre
- Generous and Private Rear Garden
- Garage and Ample Off-Road Parking to Rear
- Beautifully Presented Throughout

Lounge/Diner -

Solid wood door to front, original hard flooring, windows to front and rear, feature fireplace and wood beams, access to understairs storage, stairs to first floor and kitchen.

Kitchen -

Hard flooring from lounge/diner continued. Window to side. A range of base and wall units with worktop space over and tiled splashbacks, integrated oven with electric hob and overhead extractor fan, stainless steel sink, access into rear lobby/utility space.

Rear Lobby/Utility Room -

Hard flooring, space and plumbing for washing machine, tumble dryer, dishwasher and fridge. Access into bathroom.



Bathroom -

Window to rear, tiled flooring and tiled wet zones. Panelled bath with over head shower, built in vanity with sink and low rise WC.

First Floor

Bedroom One -

Hard flooring, window to rear and storage cupboard housing combi boiler.

Bedroom Two -

Hard flooring, window to front.

Bedroom Three -

Hard flooring, window to front.

Outside -

The front of the property is gravelled and walled off from the pavement, accessed via a gate with a stone path leading to the front door.

The rear of the property can be accessed via a private road which is shared with neighbouring properties. To the rear there is a private courtyard garden with immediate access into the rear lobby/utility room. There is also an additional and generously sized private garden which is separated from the courtyard garden by the private off road parking area in front of the single garage. The off road parking area is gravelled and being located at the end of row resulting in no



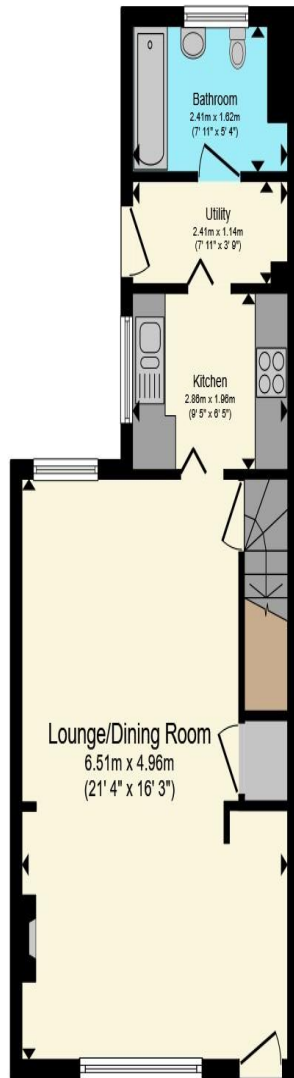

Ground Floor

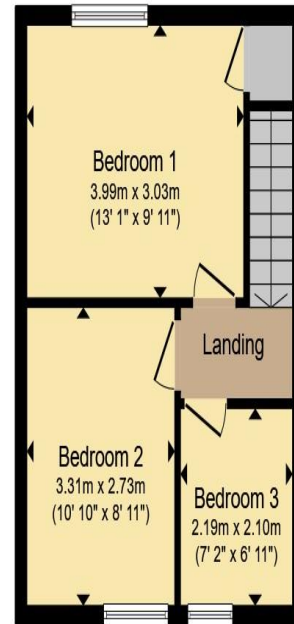

First Floor

Total floor area 77.5 m² (834 sq.ft.) approx

This floor plan is for illustrative purposes only. It is not drawn to scale. Any measurements, floor areas (including any total floor area), openings and orientation are approximate. No details are guaranteed, they cannot be relied upon for any purpose and they do not form part of any agreement. No liability is taken for any error, omission or misstatement. A party must rely upon its own inspection(s). Powered by www.propertybox.io

**Sharman
Quinney**

passing traffic. The main garden is mostly laid to lawn and is decorated with various shrubs and flowers, there is a patio area to the rear and a timber shed.

To view this property call Sharman Quinney on:
01354 661166

Selling your property?

Contact us to arrange a **FREE** home valuation.

 01354 661166

 8 Broad Street, MARCH, Cambridgeshire, PE15 8TG

 march@sharmanquinney.co.uk

 www.sharmanquinney.co.uk



 SCAN ME



Sharman Quinney Holdings Limited is registered in England and Wales under company number 4174227, Registered Office is Cumbria House, 16-20 Hockliffe Street, Leighton Buzzard, Bedfordshire, LU7 1GN. VAT Registration Number is 500 2481 05.

1: These particulars do not constitute part or all of an offer or contract. 2: The measurements indicated are supplied for guidance only and as such must be considered incorrect. 3: Potential buyers are advised to recheck the measurements before committing to any expense. 4: Sharman Quinney has not tested any apparatus, equipment, fixtures, fittings or services and it is the buyers interests to check the working condition of any appliances. 5: Sharman Quinney has not sought to verify the legal title of the property and buyers must obtain verification from their legal representative. 6: Intending purchasers will be asked to produce identification documentation at a later stage and we would ask your co-operation in order that there will be no delay in agreeing the sale. Ref: MRC207087 - 0003

