



Guide Price
£260,000

Freehold

2x  1x  2x 

**Bank Street, Faversham,
Kent, ME13**

OVER 60?

Secure this property
for up to **59% less!**

Wards
Helping you move forwards



Main features

- Popular location as only a short walk into Faversham town centre
- No onward chain
- Great investment or perfect for a first time buyer
- Modern kitchen and exposed floorboards
- Courtyard rear garden with side access

Accommodation

GROUND FLOOR

Lounge: 12'3 x 10'6 (3.74m x 3.20m)

Dining Area: 12'7 x 11'5 (3.84m x 3.48m)

Kitchen: 9'11 x 5'9 (3.02m x 1.75m)

FIRST FLOOR

Bedroom 1: 12'3 x 10'6 (3.74m x 3.20m)

Bedroom 2: 11'5 x 4'9 (3.48m x 1.45m)

Bathroom

OUTSIDE

Courtyard Rear Garden

Split Level Ground Floor

Approx. 28.5 sq. metres (306.6 sq. feet)

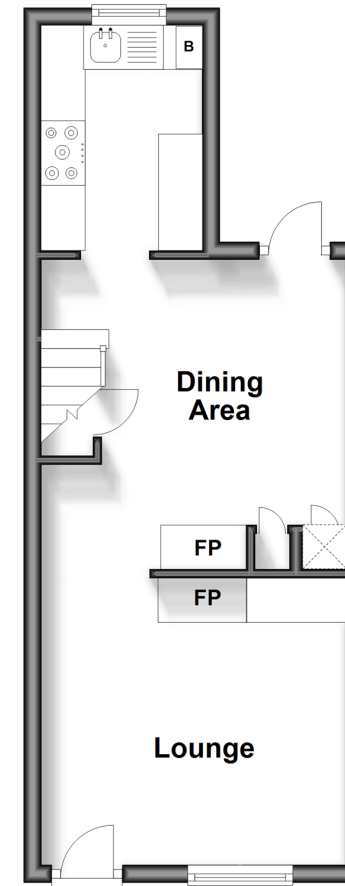

First Floor

Approx. 23.5 sq. metres (252.8 sq. feet)

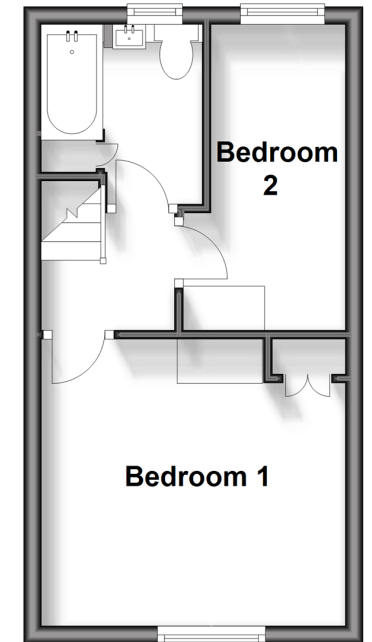

Call Faversham - 01795 535517 ■ wardsofkent.co.uk

■ Through a Homewise Home For Life Plan people aged 60+ can secure this property for up to 59% less, by purchasing a Lifetime Lease



10831965/20260401/JB/PJ