



JOSHUA JAMES

ESTATE AGENTS

Dartmoor Way, Biggleswade SG18 0FL

Asking Price £340,000

🛏 2 🚿 1 🛋 1

- Beautifully Presented End Terrace Home
- Lounge / Diner with Oak Flooring
- Comprehensively Fitted Kitchen
- Downstairs Cloakroom
- Spacious First Floor Landing
- Two Double Bedrooms
- Re-Fitted Family Bathroom
- Enclosed Low Maintenance Rear Garden
- Allocated Parking
- Popular Location



Beautifully presented end-of-terrace home, built in 2012, offering modern comforts and a thoughtful layout. This property, located in a sought-after area, features allocated parking and a delightful, low-maintenance garden, perfect for relaxation and entertaining. The accommodation comprises lounge / dining room with Oak flooring, comprehensively fitted kitchen with built in appliances and downstairs cloakroom. To the first floor are two large double bedrooms and re-fitted family bathroom. In addition there is a purpose built studio / home office with power and light set to the rear of the garden.





GROUND FLOOR
457 sq.ft. (42.4 sq.m.) approx.

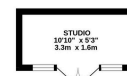

1ST FLOOR
400 sq.ft. (37.2 sq.m.) approx.

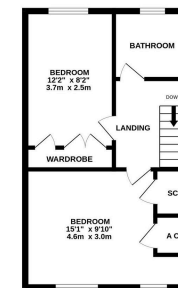
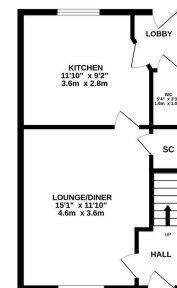

TOTAL FLOOR AREA: 857 sq.ft. (79.6 sq.m.) approx.
We warrant that the above information is true to the best of our knowledge and belief at the time of completion of the contract. We do not warrant that the information is complete or that it is accurate in all respects. The information is provided for your information only and should not be relied upon for any purpose other than that for which it is provided. We accept no liability for any loss or damage arising from the use of the information.