



**Connells**

Kenilworth Drive  
Eastleigh



## Property Description

Situated in a highly desirable residential area of Eastleigh, this spacious four-bedroom detached home offers excellent family accommodation, a driveway, garage, and attractive gardens to both the front and rear.

The welcoming entrance hall provides access to a convenient downstairs cloakroom, a formal dining room, and a generous separate lounge featuring a fireplace and bay window, creating a warm and inviting living space.

The fitted kitchen/diner offers ample room for family dining and entertaining, complemented by a useful utility room with direct access to the rear garden and an internal door leading to the garage.

Upstairs, the property boasts four well-proportioned bedrooms, all benefiting from fitted wardrobes, together with a stylish modern family bathroom.

Outside, the beautifully maintained rear garden provides a wonderful space to relax and enjoy the outdoors, featuring a patio seating area, well-kept lawn, established flower beds, a garden shed, and side access.

To the front, an attractive landscaped garden enhances the property's kerb appeal, while the driveway and garage provide ample parking for three cars (one garaged and two driveway spaces)

Conveniently located close to Eastleigh town centre, local parks, highly regarded schools, and excellent transport links, this fantastic home is perfectly suited to growing families seeking both space and convenience.

Offered to the market with no onward chain, an early viewing is highly recommended

## Entrance Hall

Radiator. Airing cupboard.

## Cloakroom

Toilet. Radiator. Vanity sink. Extractor fan.

## Lounge

Double glazed bay window to rear aspect. Gas fireplace. Radiator. TV port.

## Dining Room

Double glazed window to front aspect. Radiator. Stairs to first floor.

## Kitchen

Double glazed window to rear and side aspect. Fitted kitchen with wall and base units. Gas hob and oven. Radiator.

## Utility Room

Double glazed window to rear aspect. Double glazed door to rear aspect. Space and plumbing for washing machine. Work top space with sink.

## Bedroom 1

Large double bedroom with double glazed window to rear aspect. Built in wardrobes x2. Radiator.

## Bedroom 2

Double glazed window to front aspect. Built in wardrobes x2. Built in dresser. Radiator.

## Bedroom 3

Double glazed window to rear aspect. Radiator. Built in wardrobes.

## Bedroom 4

Double glazed window to front aspect. Radiator. Fitted wardrobes.

## Bathroom

Double glazed window to side aspect. Electric shower over bath. Vanity sink. Toilet. Heated towel rail.

## Outside

To the front. Driveway. Garage. lawn area and flower beds. Side access.

To the rear. Patio area. Lawn. Outside tap. Flower beds. Shed.

## Garage

Electric roller door. Gas meter. Loft space with ladder.





**Ground Floor**

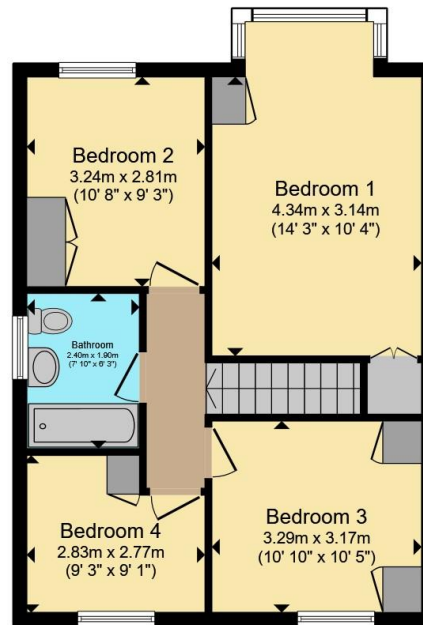

**First Floor**

Total floor area 112.0 m<sup>2</sup> (1,205 sq.ft.) approx

This floor plan is for illustrative purposes only. It is not drawn to scale. Any measurements, floor areas (including any total floor area), openings and orientation are approximate. No details are guaranteed, they cannot be relied upon for any purpose and they do not form part of any agreement. No liability is taken for any error, omission or misstatement. A party must rely upon its own inspection(s). Powered by [www.propertybox.io](http://www.propertybox.io)



To view this property please contact Connells on

**T 02380 618 343**  
**E [eastleigh@connells.co.uk](mailto:eastleigh@connells.co.uk)**

19 Market Street  
 EASTLEIGH SO50 5RH

EPC Rating: D Council Tax Band: E

**view this property online [connells.co.uk/Property/EGH309643](http://connells.co.uk/Property/EGH309643)**

Tenure: Freehold



1. MONEY LAUNDERING REGULATIONS Intending purchasers will be asked to produce identification documentation at a later stage and we would ask for your co-operation in order that there will be no delay in agreeing the sale. 2. These particulars do not constitute part or all of an offer or contract. 3. The measurements indicated are supplied for guidance only and as such must be considered incorrect. Potential buyers are advised to recheck measurements before committing to any expense. 4. We have not tested any apparatus, equipment, fixtures, fittings or services and it is in the buyers interest to check the working condition of any appliances.

Connells Residential is registered in England and Wales under company number 1489613, Registered Office is Cumbria House, 16-20 Hockliffe Street, Leighton Buzzard, Bedfordshire, LU7 1GN. VAT Registration Number is 500 2481 05.

**See all our properties at [www.connells.co.uk](http://www.connells.co.uk) | [www.rightmove.co.uk](http://www.rightmove.co.uk) | [www.zoopla.co.uk](http://www.zoopla.co.uk)**

Property Ref: EGH309643 - 0003