

7 Sawley Close , Darlington, DL3 9TX

Welcome to this charming end-terrace house located in the desirable area of Cockerton, Darlington. This delightful property boasts a generous 797 square feet of living space, making it an ideal home for families or those seeking a comfortable living environment.

£120,000

7 Sawley Close

, Darlington, DL3 9TX

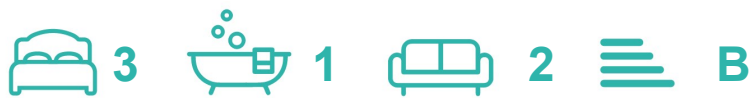

- Quiet residential area
- Solar panels & Storage Batteries
- West facing
- Sunroom

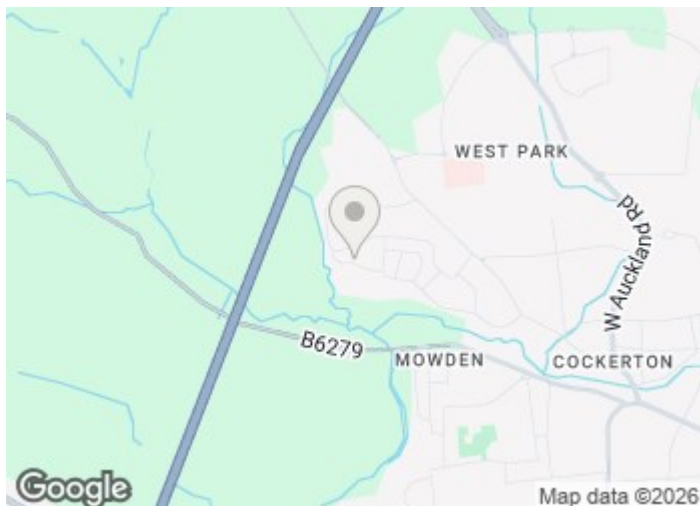

[Directions](#)



Floor Plan

GROUND FLOOR
390 sq.ft. (36.3 sq.m.) approx.

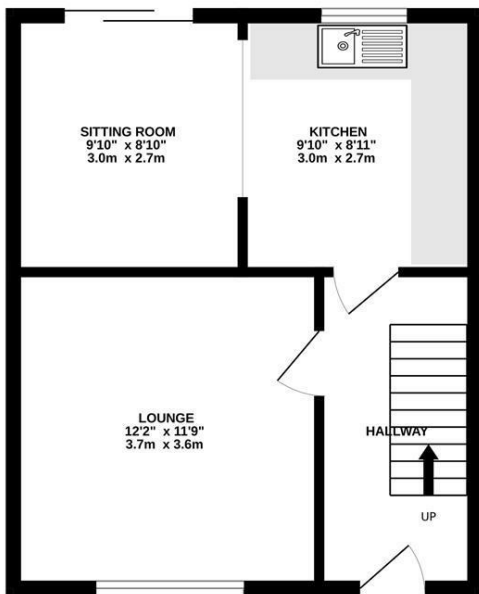

1ST FLOOR
390 sq.ft. (36.3 sq.m.) approx.

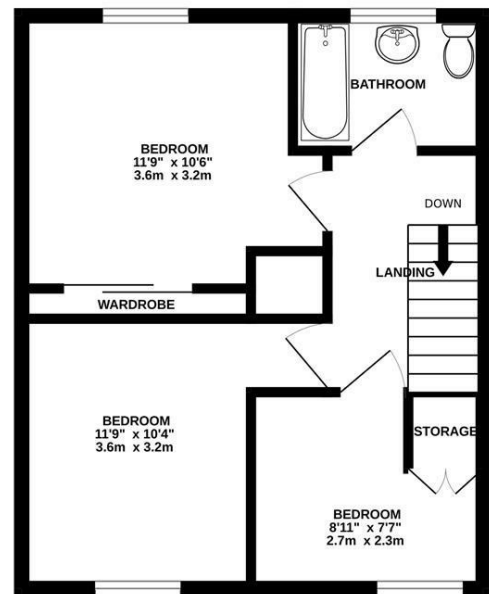

TOTAL FLOOR AREA : 781 sq.ft. (72.5 sq.m.) approx.

Whilst every attempt has been made to ensure the accuracy of the floorplan contained here, measurements of doors, windows, rooms and any other items are approximate and no responsibility is taken for any error, omission or mis-statement. This plan is for illustrative purposes only and should be used as such by any prospective purchaser. The services, systems and appliances shown have not been tested and no guarantee as to their operability or efficiency can be given.
Made with Metropix ©2026

These particulars, whilst believed to be accurate are set out as a general outline only for guidance and do not constitute any part of an offer or contract. Intending purchasers should not rely on them as statements of representation of fact, but must satisfy themselves by inspection or otherwise as to their accuracy. No person in this firm's employment has the authority to make or give any representation or warranty in respect of the property.

