



1 BEDROOM, 2ND FLOOR  
APARTMENT WITH ALLOCATED  
PARKING.

GUIDE PRICE £170,000

11 Lyndale Court, London Road, Redhill, RH1 2JQ

Well-positioned on the second floor, this bright and airy 1-bedroom apartment offers comfortable living with the bonus of allocated parking. The property features gas central heating, double glazing, a generous double bedroom, spacious sitting room, fitted kitchen, and bathroom. Residents can also enjoy access to a shared garden—ideal for relaxing outdoors. Conveniently offered chain free, this low-maintenance home is perfect for first-time buyers, investors or those looking to downsize. 1 allocated parking space, EPC C. Council tax C. 125 year lease. Service charge £2,040. ground rent £150 per year.



lewis  
white



## Second Floor

Approx. 39.6 sq. metres (425.8 sq. feet)

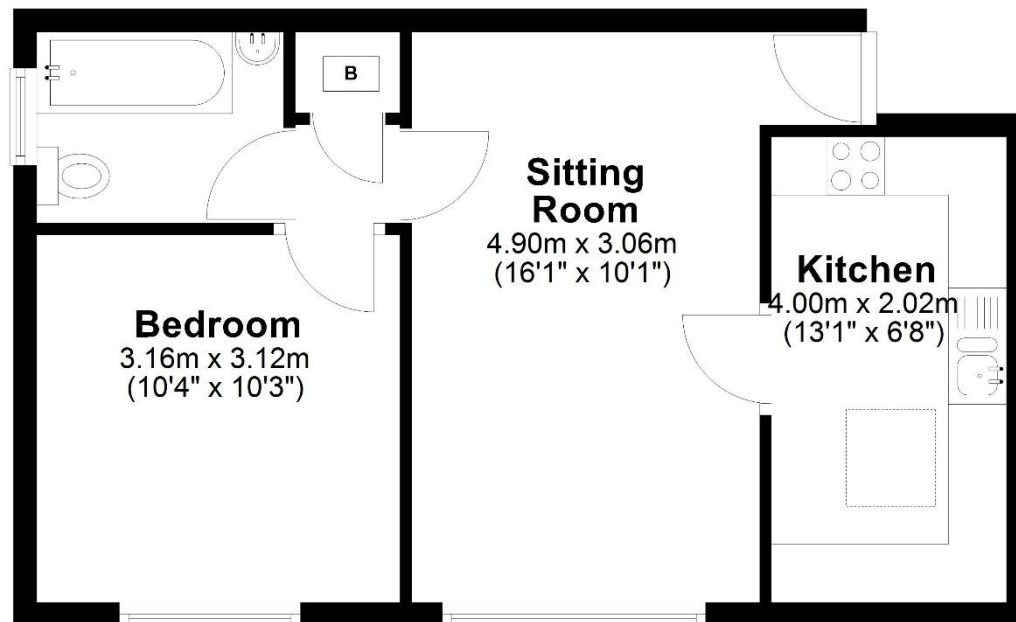

Total area: approx. 39.6 sq. metres (425.8 sq. feet)



125 year lease. Council tax band: C. EPC: C. Service charge £2,040 per year, ground rent £150 per year.

Lewis White Estate Agents, Somers House, Linkfield Corner, RH1 1BB. 01737 245779 info@lewiswhite.net www.lewiswhite.net