



**Stanley Road, Oldbury B68 0EH**

**welcome to**

## **Stanley Road, Oldbury**

\*\*\*THREE BEDROOM SEMI DETACHED HOME\*\*\*PERFECT FOR GROWING FAMILIES OR FIRST TIME BUYERS\*\*\*TWO RECEPTION ROOMS\*\*\*UTILITY AND DOWNSTAIRS CLOAKROOM\*\*\*EXCELLENT SIZE REAR GARDEN\*\*\*DOUBLE DRIVEWAY AND GARAGE\*\*\*

### **Agent Note**

This property is council tax band C.

### **Dining Room**

14' 3" into bay window. x 9' to chimney breast. ( 4.34m into bay window. x 2.74m to chimney breast. )  
Double glazed bay window to front.

### **Lounge**

12' 1" x 11' 3" to chimney breast. ( 3.68m x 3.43m to chimney breast. )  
Double glazed french doors to garden, central heating radiator.

### **Downstairs W/C**

Low level flush w/c, wash hand basin.

### **Kitchen**

8' 4" x 6' 7" ( 2.54m x 2.01m )  
Double glazed window, range of wall & base units, integrated hob, oven, extractor, pantry space.

### **Utility Room**

12' 7" x 4' 8" ( 3.84m x 1.42m )  
Off kitchen, access to garden.

### **Bedroom 1**

10' 9" into bay window. x 9' 1" to chimney breast. ( 3.28m into bay window. x 2.77m to chimney breast. )  
Double glazed bay window to front, central heating radiator.

### **Bedroom 2**

12' 2" x 8' to wardrobe front. ( 3.71m x 2.44m to wardrobe front. )  
Double glazed window to rear, wardrobe with space both sides.

### **Bedroom 3**

7' 3" x 6' 1" ( 2.21m x 1.85m )  
Double glazed window.

### **Bathroom**

Modern shower over bath, separate w/c.

### **Rear Garden**

Patio & lawn area.





***check out more properties at*** [shipways.co.uk](https://shipways.co.uk)





welcome to

## Stanley Road, Oldbury

- Three Bedroom Family Home
- Sought After Location in Oldbury
- Driveway and Garage
- Two Reception Rooms
- Excellent Size Rear Garden

Tenure: Freehold EPC Rating: D  
Council Tax Band: C

offers over  
**£290,000**

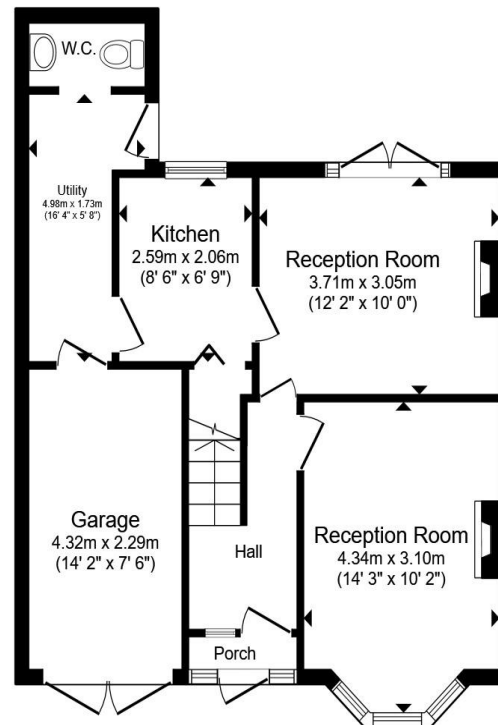

Ground Floor

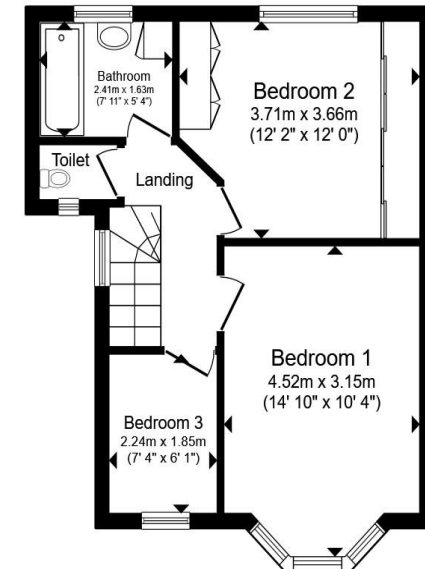

First Floor

Total floor area 91.6 m<sup>2</sup> (986 sq.ft.) approx

This floor plan is for illustrative purposes only. It is not drawn to scale. Any measurements, floor areas (including any total floor area), openings and orientation are approximate. No details are guaranteed, they cannot be relied upon for any purpose and they do not form part of any agreement. No liability is taken for any error, omission or misstatement. A party must rely upon its own inspection(s). Powered by [www.propertybox.io](http://www.propertybox.io)



check out more properties at [shipways.co.uk](http://shipways.co.uk)



Property Ref:  
HBN112054 - 0003

1. MONEY LAUNDERING REGULATIONS Intending purchasers will be asked to produce identification documentation at a later stage and we would ask for your co-operation in order that there is no delay in agreeing the sale. 2. These particulars do not constitute part or all of an offer or contract. 3. The measurements indicated are supplied for guidance only and as such must be considered incorrect. Potential buyers are advised to recheck measurements before committing to any expense. 4. We have not tested any apparatus, equipment, fixtures or services and it is in the buyers interest to check the working condition of any appliances. 5. Where an EPC, or a Home Report (Scotland only) is held for this property, it is available for inspection at the branch by appointment. If you require a printed version of a Home Report, you will need to pay a reasonable production charge reflecting printing and other costs. 6. We are not able to offer an opinion either written or verbal on the content of these reports and this must be obtained from your legal representative. 7. Whilst we take care in preparing these reports, a buyer should ensure that his/her legal representative confirms as soon as possible all matters relating to title including the extent and boundaries of the property and other important matters before exchange of contracts.

Not for marketing purposes INTERNAL USE ONLY



**0121 427 3264**



[harborne@shipways.co.uk](mailto:harborne@shipways.co.uk)



172 High Street, Harborne, BIRMINGHAM,  
West Midlands, B17 9PP



[shipways.co.uk](http://shipways.co.uk)