



106 West End, Street
Street

Guide Price £230,000

106 West End

Street, Street

*No Chain * This charming 2 bedroom cottage has heaps of character and comes complete with log burner, feature stone walls, off street parking and a 35m long rear garden. Redecorated and re-carpeted throughout. Ideal for first time buyers and investors alike.

Council Tax band: B

Tenure: Freehold

EPC Energy Efficiency Rating: C

EPC Environmental Impact Rating: C

- ** NO CHAIN **
- Newly Installed Log Burner
- Two Double Bedrooms
- Long Rear Garden with Large Shed
- Parking Space at Rear
- GCH and Double Glazing Throughout
- Newly Redecorated and Recarpeted
- Close to Schools and Local Amenities
- Ideal First Time Buyer or Investment
- Book to View Now





Ground Floor

Approx. 33.7 sq. metres (362.4 sq. feet)

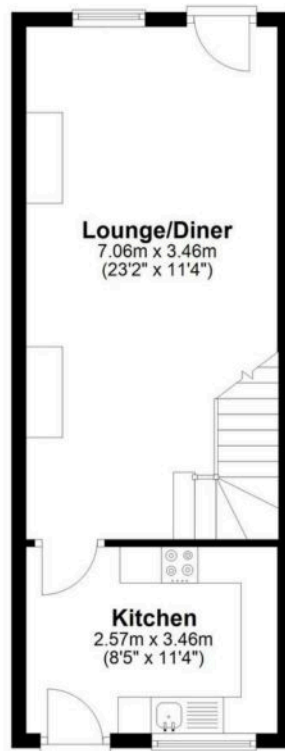

First Floor

Approx. 33.7 sq. metres (362.4 sq. feet)

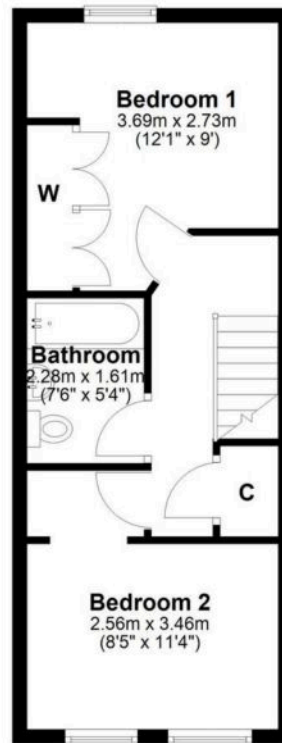

Total area: approx. 67.3 sq. metres (724.7 sq. feet)

GARDEN

Long rear garden with wooden shed

OFF STREET

1 Parking Space

Off street parking for one vehicle at the rear, although this can be extended into the garden for a second vehicle if required.



Ground Floor

Approx. 33.7 sq. metres (362.4 sq. feet)

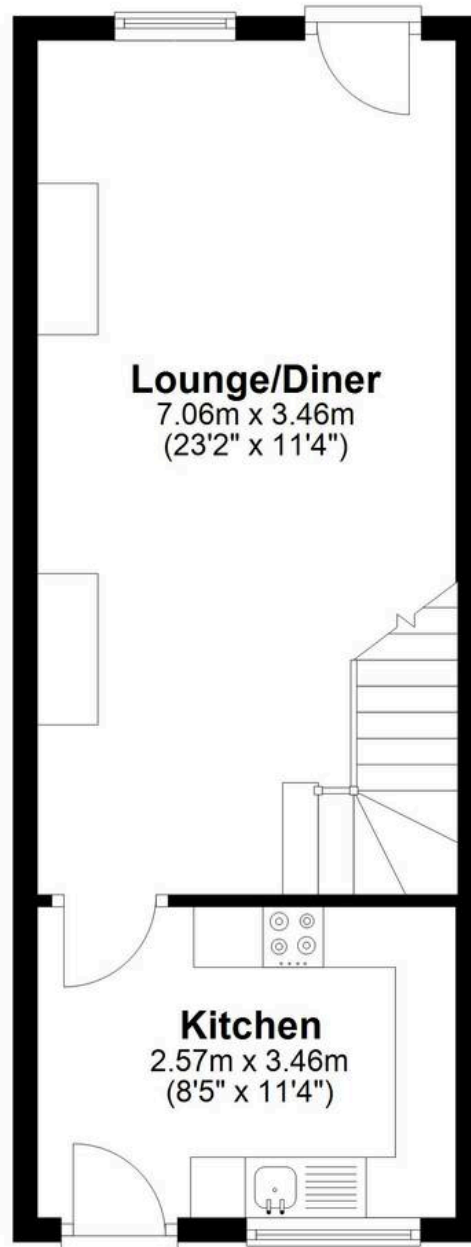

First Floor

Approx. 33.7 sq. metres (362.4 sq. feet)

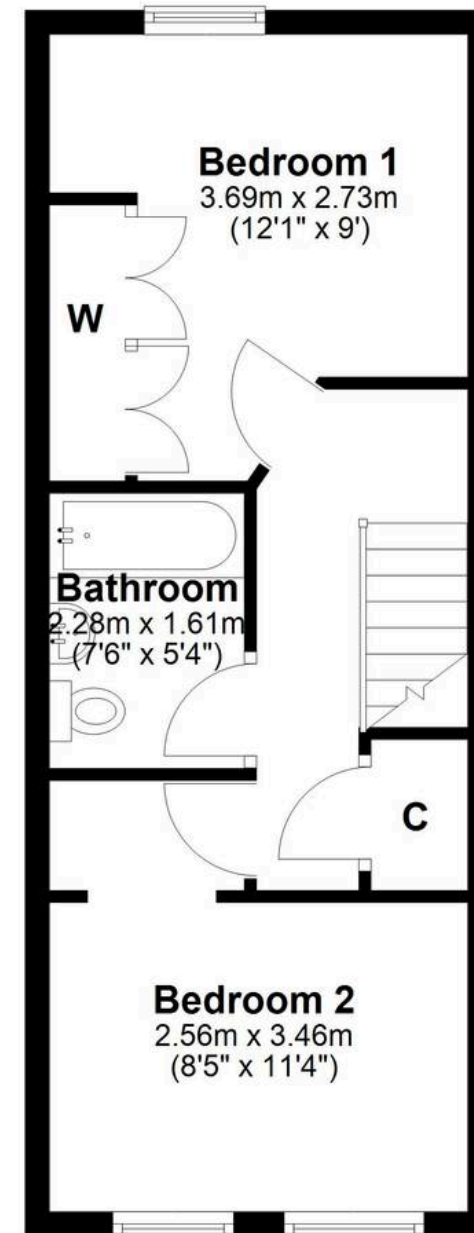

Total area: approx. 67.3 sq. metres (724.7 sq. feet)



Homely Bespoke Estate Agents

68 Burley Grove, Bristol - BS16 5PZ

07566756699

anne@homelyproperties.co.uk

www.homelyproperties.co.uk/