



LONG MEADOW, BEDGROVE, AYLESBURY

PRICE £135,000

LEASEHOLD

This one bedroom ground floor flat is located in a highly sought-after area. It is offered with no upper chain, making for a smooth and quick purchase process. The property is within walking distance to Jansel Square shops, providing easy access to local amenities. It also comes with allocated parking.



LONG MEADOW

- BEDGROVE • ONE BEDROOM GROUND FLOOR FLAT • ALLOCATED PARKING SPACE IN COMMUNAL CAR PARK • WALKING DISTANCE TO JANSEL SQUARE SHOPS • NO UPPER CHAIN • IDEAL FOR FIRST-TIME BUYERS, INVESTORS OR DOWNSIZERS



LOCATION

Bedgrove is a highly regarded development situated on the south side of Aylesbury. At the heart of the estate is Jansel Square Centre which has a range of shops, pub, post office and hairdressers. Additional benefits include a doctor's surgery, two churches and a large recreation park with many sports clubs and activities. An ideal location for families the estate is served by the well regarded Bedgrove Infant and Junior schools and is within walking distance of the Aylesbury Grammar and Aylesbury High School. There is a frequent bus service to the town centre, good road links towards London on the A41 and A413 and the choice of Aylesbury Central or Stoke Mandeville Train Stations offering mainline services into London Marylebone.

ACCOMMODATION

A one bedroom ground floor flat, ideally suited for first-time buyers, investors, or those looking to downsize. The property offers comfortable and practical living space, including a bright lounge, a separate kitchen with space for appliances, a bedroom and bathroom. Additional benefits include a convenient storage cupboard and allocated parking within a communal car park. Situated in a quiet residential area, the flat provides easy access to local amenities and transport links.

NOTES

LEASE INFO - 999 year lease with 950 years left.
Service Charge £1065 p/a. Ground Rent £15 p/a.

LONG MEADOW



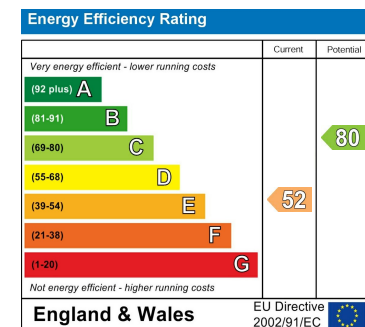
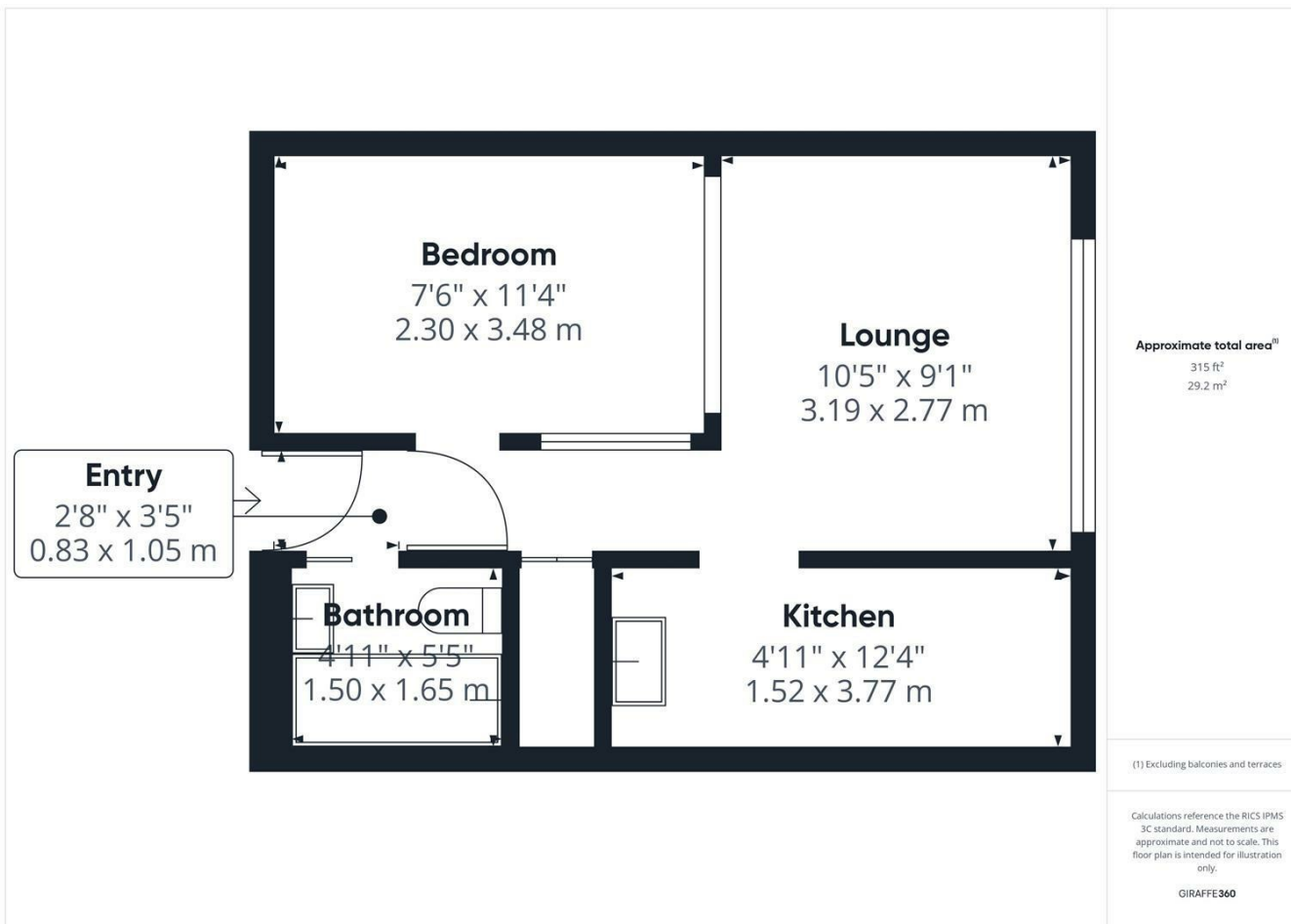

Agents Note: Whilst every care has been taken to prepare these particulars, they are for guidance purposes only. All measurements are approximate and are for general guidance purposes only and whilst every care has been taken to ensure their accuracy, they should not be relied upon and potential buyers/tenants are advised to recheck the measurements

George David & Co
46 High Street
Aylesbury
HP20 1SE

01296 393 393
info@georgedavid.co.uk
www.georgedavid.co.uk

