



CLIVEPEARCE
Now you're moving

3 Bedrooms

House - Detached

Asking Price

£550,000

Located in

Truro



www.clivepearceproperty.com



Tremayne Close

Truro | Cornwall | TR3 6QE



In an exclusive cul de sace in the waterside village of Devoran. this detached home offers superb space inside and out.

Tremayne Close

£550,000 Freehold



- Outstanding Detached Family Home
- Beautiful Family Bathroom & Ensuite
- Replacement Kitchen & Separate Utility
- Double Garage & Established Gardens
- Three Bedrooms, (Originally Four)
- Open Plan Living
- Gas Central Heating & Double Glazing
- Sought After Creekside Village

1st Floor
Area (approx): 61.2 m² ... 659 ft²

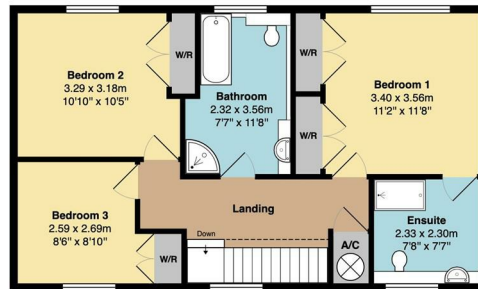

Ground Floor
Area (approx): 90.1 m² ... 969 ft²



Total Area: 151.3 m² ... 1628 ft² (excluding external porch)

Whilst every attempt has been made to ensure the accuracy of the floorplan contained here, measurements of doors, windows, rooms and any other items are approximate and no responsibility is taken for any error, omission or mis-statement. This plan is for illustrative purposes only and should be used as such by any prospective purchaser. The services, systems and appliances shown have not been tested and no guarantee as to their operability or efficiency can be given.

Council Tax Band E

Local Authority

Agents Note: Whilst every care has been taken to prepare these particulars, they are for guidance purposes only. All measurements are approximate and are for general guidance purposes only and whilst every care has been taken to ensure their accuracy, they should not be relied upon and potential buyers/tenants are advised to recheck the measurements.

Energy Efficiency Rating		
	Current	Potential
Very energy efficient - lower running costs		
(92 plus) A		
(81-91) B		
(69-80) C		
(55-68) D		
(39-54) E		
(21-38) F		
(1-20) G		
Not energy efficient - higher running costs		
England & Wales	EU Directive 2002/91/EC	

31 Lemon Street
Truro
Cornwall
TR1 2LS



CLIVEPEARCE
Now you're moving

hello@clivepearceproperty.com

01872 272622

www.clivepearceproperty.com