



1 Bedroom
Flat - Purpose Built
located in Spa
Court, Kings
Esplanad

Asking price £500,000



TAYLOR
MICHAEL

Spa Court, Kings Esplanade, Hove, BN3 2WS

Approximate Gross Internal Area = 65.6 sq m / 706 sq ft

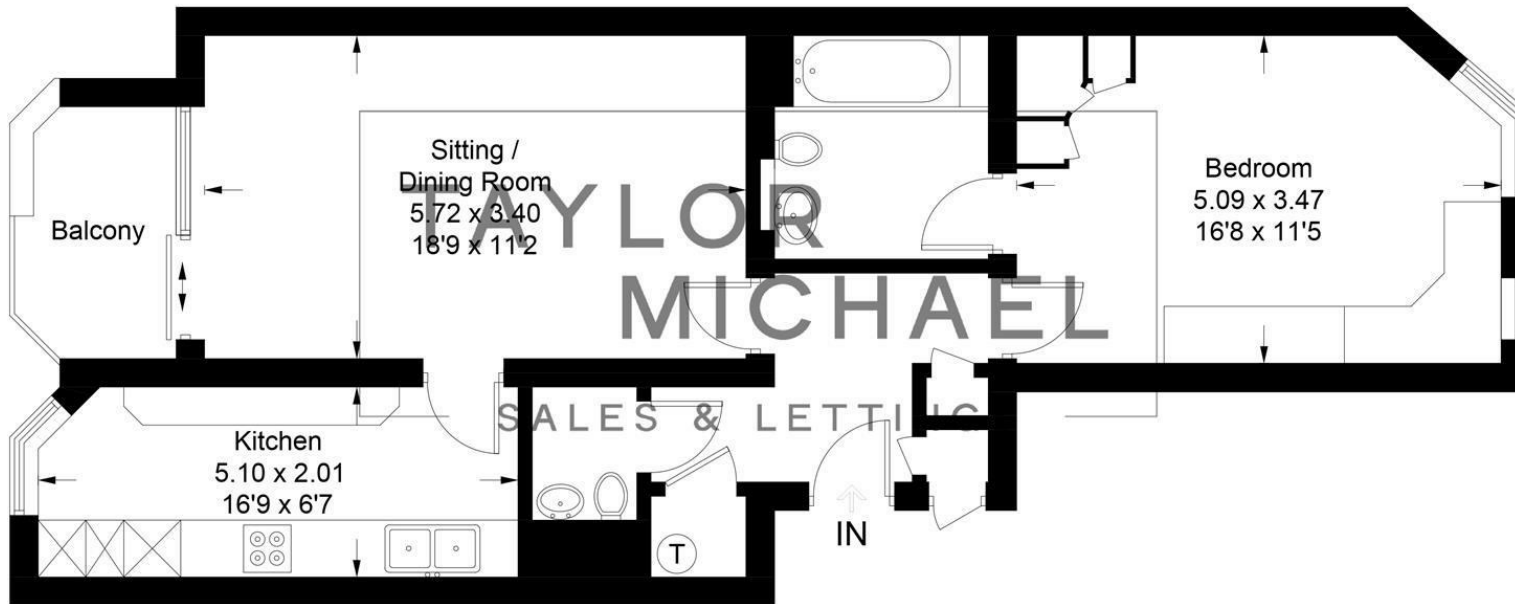

Sixth Floor

Illustration for identification purposes only, measurements are approximate, not to scale.
Imageplansurveys @ 2025

DESCRIPTION

Positioned on the sixth floor of this highly regarded purpose-built seafront development, this exceptional one-bedroom apartment enjoys uninterrupted, direct sea views that are quite simply unrivalled. With a private balcony, allocated parking, lift access, and a share of freehold, this property represents a rare opportunity to acquire a premium coastal home in one of Hove's most sought-after locations.

CONTACT

62 Church Road
Hove
East Sussex
BN3 2FP

T: 01273 600 100
<https://taylormichael.agency/>

TAYLOR
MICHAEL