



Entry Hill,

Offers Over £325,000

FOR SALE



- Garden Apartment
- Kitchen Diner
- Spacious
- One Bedroom
- High Ceilings and Character
- Private Garden and Summer House

Approx Gross Internal Area
54 sq m / 579 sq ft

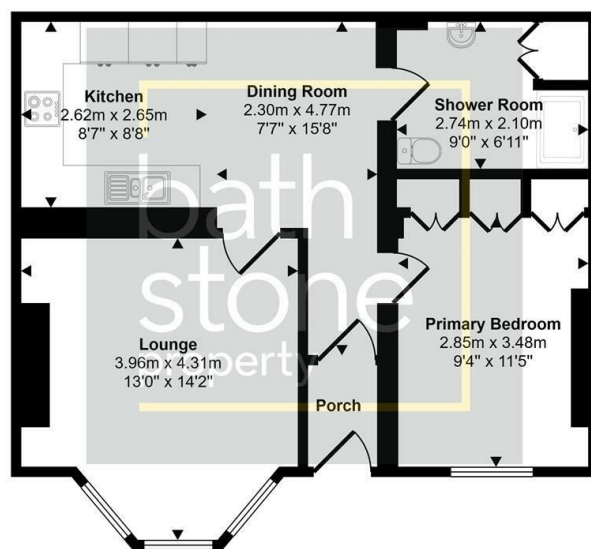

Floorplan

This floorplan is only for illustrative purposes and is not to scale. Measurements of rooms, doors, windows, and any items are approximate and no responsibility is taken for any error, omission or mis-statement. Icons of items such as bathroom suites are representations only and may not look like the real items. Made with Made Snappy 360.

THE PROPERTY

Entry Hill apartment is a wonderful one-bedroom apartment, which offers a perfect blend of character and modern living. The property boasts a spacious layout of 579 square feet, featuring high ceilings that enhance the sense of space and light throughout.

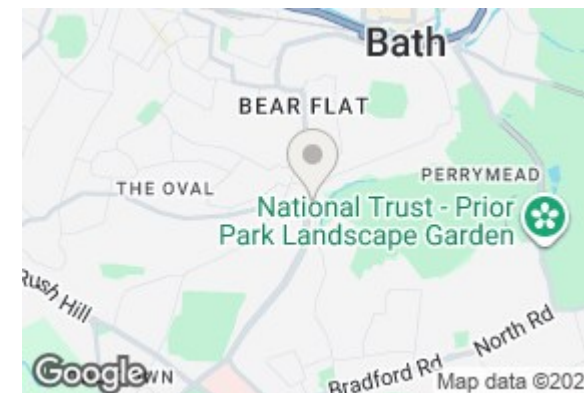

Energy Efficiency Rating

	Current	Potential
Very energy efficient - lower running costs		
(92 plus) A		
(81-91) B		
(69-80) C		78
(55-68) D		
(39-54) E		
(21-38) F	31	
(1-20) G		
Not energy efficient - higher running costs		
England & Wales	EU Directive 2002/91/EC	

1 Hayes Place, Bath, BANES, BA2 4QW

Tel: 01225422224 Email: sales@bathstoneproperty.com <https://www.bathstoneproperty.com>