

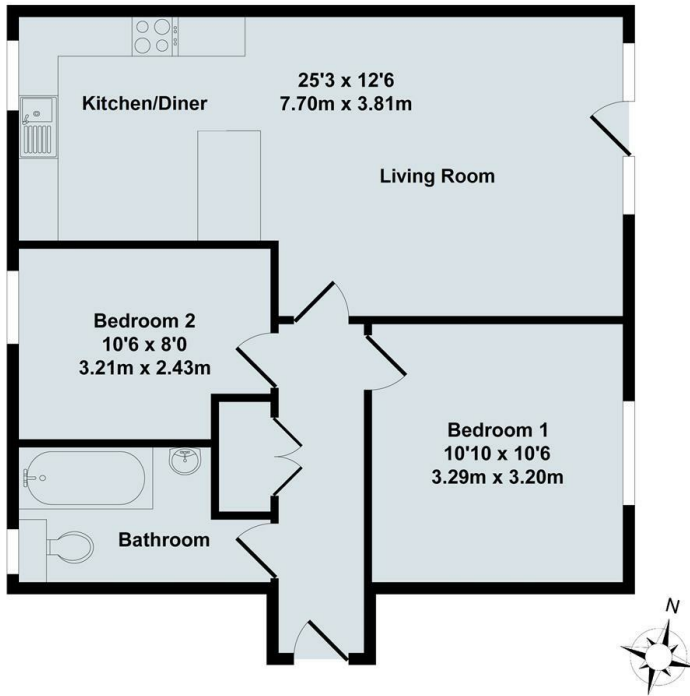

## 21 Willow Brook, Abingdon, Oxfordshire, OX14 1TD

£1,450 Per Month - 24th August 2026.

- COMPLETELY RENOVATED THROUGHOUT
- ALLOCATED PARKING
- 607 SQ FOOT
- 2 DOUBLE BEDROOMS
- COUNCIL TAX BAND C
- UNFURNISHED
- GAS CENTRAL HEATING
- EPC BAND C
- 2ND FLOOR APARTMENT



Total Approx. Floor Area 607 Sq.Ft. (56.40 Sq.M.)  
 All items illustrated on this plan are included in the "Total Approx Floor Area"

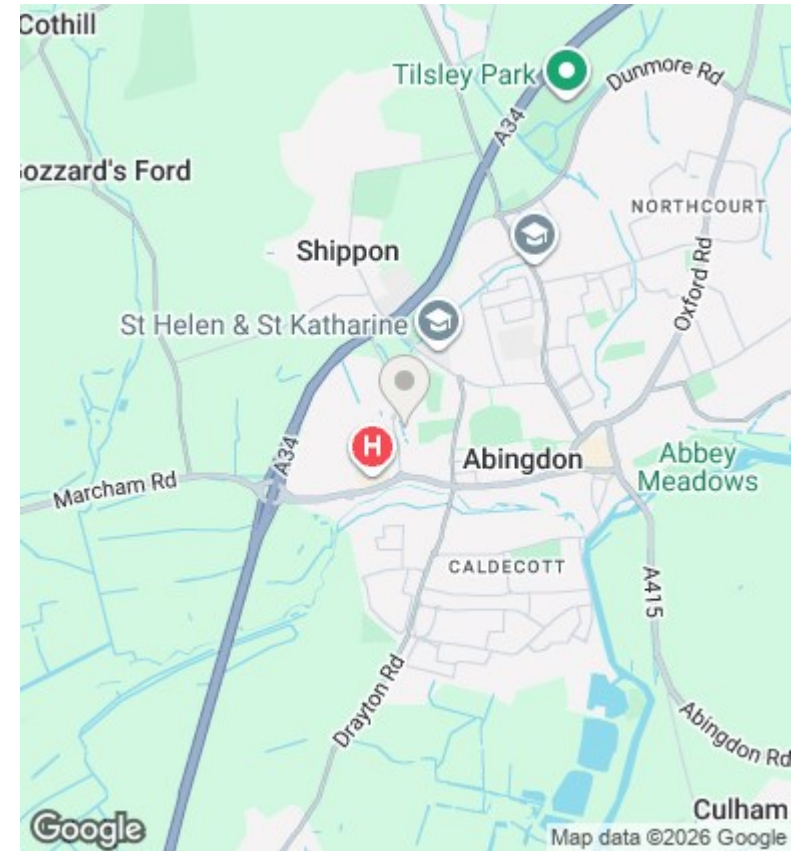

## Directions

## Viewings

Viewings by arrangement only. Call 01235 554950 to make an appointment.

## Council Tax Band

C

## EPC Rating:

Energy Efficiency Rating		
	Current	Potential
<i>Very energy efficient - lower running costs</i>		
(92 plus) <b>A</b>		
(81-91) <b>B</b>		
(69-80) <b>C</b>		
(55-68) <b>D</b>		
(39-54) <b>E</b>		
(21-38) <b>F</b>		
(1-20) <b>G</b>		
<i>Not energy efficient - higher running costs</i>		
<b>England &amp; Wales</b>	EU Directive 2002/91/EC	