

Frank Harris & Co.



Mast House Terrace, E14

£3,500 Per week

A recently refurbished four double bedroom town house arranged over three floors. This property has a semi open-plan reception, four double bedrooms, two modern bathrooms, a private garden and is offered unfurnished.

Located at the southern tip of the Isle of Dogs, on a quiet side street, the property is close to the Thames and Mudchute DLR station for a short commute to Canary Wharf and Bank.

- Four Double Bedrooms • Two Bathrooms • Town House •
- Unfurnished • Private Garden • On Street Parking •

Frank Harris & Co.

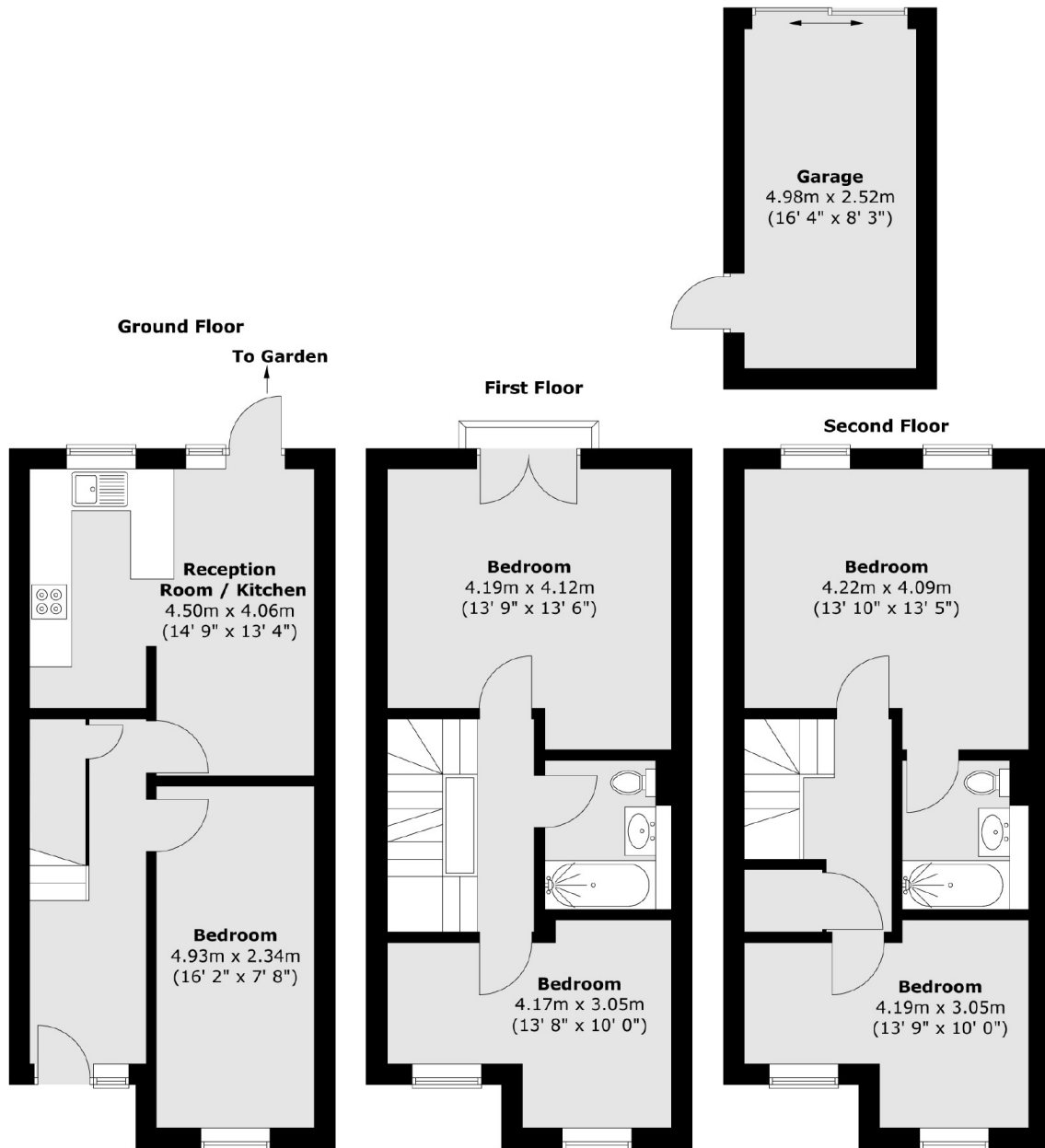

Total area (approx.) : 115.9 sq. m (1247 sq. ft)
Total garage area (approx.) : 13.2 sq. m (142 sq. ft)

Frank Harris & Co. Tower Bridge
205 Tooley Street, London, SE1
2JX
020 7234 0880
towerbridgelettings@frankharris.co.uk

Energy Rating: . We aim to make our particulars both accurate and reliable. However they are not guaranteed; nor do they form part of an offer or contract. If you require clarification on any points then please contact us, especially if you're traveling some distance to view. Please note that appliances and heating systems have not been tested and therefore no warranties can be given as to their good working order.

