



Chapel Lane, Chatteris PE16 6RJ

welcome to

Chapel Lane, Chatteris

** NO ONWARD CHAIN ** Semi Detached House - Three Bedrooms - En Suite to Bedroom One - Underfloor heating to the Ground Floor
Kitchen/ Dining Room - Utility Room - Enclosed Rear Garden - Off Road Parking



Please Note

The ground floor benefits from underfloor heating.

Entrance Door Hall

Laminate floor. Storage cupboard. Stairs leading off.

Ground Floor W.C.

Window to rear. Low level w.c. Vanity wash hand basin. Extractor fan. Gas central heating boiler.

Living Room

Windows to front. French doors to garden. TV point. Telephone point. Laminate floor.

Kitchen / Dining Room

Two windows to front. French doors to garden. Electric double oven, gas hob and cooker hood above. Laminate floor. Integrated dishwasher. Integrated microwave. Single drainer sink with mixer taps. Integrated fridge and freezer.

Utility Room

Single drainer sink with mixer taps. Integrated washing machine.

Stairs To First Floor Landing

Window to rear. Radiator. Smoke alarm.

Bedroom One

Two windows to front. Radiator. TV point. Loft access (which is boarded with light and has ladder).

En Suite

Window to front. Low level w.c. Pedestal wash hand basin. Shower cubicle. Radiator. Extractor fan.

Bedroom Two

Two windows to front. Radiator.

Bedroom Three

Window to rear. Radiator.

Bathroom

Window to rear. Panel bath. Pedestal wash hand basin. Low level w.c. Heated towel rail.

Outside

Front garden is open plan with block pave drive for multi vehicle parking.

Rear garden is enclosed with patio area and laid to grass. Timber store with electric. Outside tap. Outside light.



view this property online williamhbrown.co.uk/Property/MCH114754



welcome to

Chapel Lane, Chatteris

- Semi Detached House
- Three Bedrooms
- En Suite to Bedroom One
- Underfloor Heating to the Ground Floor
- Kitchen / Dining Room PLUS Utility Room
- Enclosed Rear Gardens
- Off Road Parking
- NO ONWARD CHAIN

Tenure: Freehold
EPC Rating: B
Council Tax Band: C

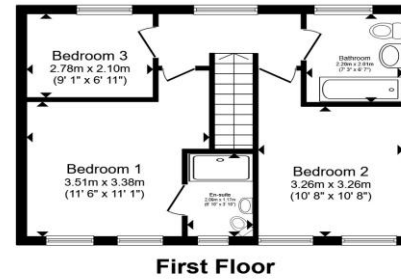
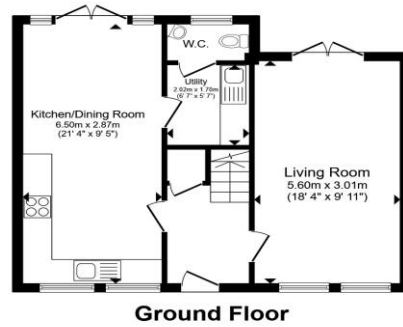

Total floor area 91.0 m² (980 sq.ft.) approx
This floor plan is for illustrative purposes only. It is not drawn to scale. Any measurements, floor areas (including any total floor area), openings and orientation are approximate. No details are guaranteed, they cannot be relied upon for any purpose and they do not form part of any agreement. No liability is taken for any error, omission or misstatement. A party must rely upon its own inspection(s). Powered by www.propertybox.io



£270,000



Please note the marker reflects the postcode not the actual property

view this property online williamhbrown.co.uk/Property/MCH114754



Property Ref:
MCH114754 - 0005

1. MONEY LAUNDERING REGULATIONS Intending purchasers will be asked to produce identification documentation at a later stage and we would ask for your co-operation in order that there is no delay in agreeing the sale. 2. These particulars do not constitute part or all of an offer or contract. 3. The measurements indicated are supplied for guidance only and as such must be considered incorrect. Potential buyers are advised to recheck measurements before committing to any expense. 4. We have not tested any apparatus, equipment, fixtures or services and it is in the buyers interest to check the working condition of any appliances. 5. Where an EPC, or a Home Report (Scotland only) is held for this property, it is available for inspection at the branch by appointment. If you require a printed version of a Home Report, you will need to pay a reasonable production charge reflecting printing and other costs. 6. We are not able to offer an opinion either written or verbal on the content of these reports and this must be obtained from your legal representative. 7. Whilst we take care in preparing these reports, a buyer should ensure that his/her legal representative confirms as soon as possible all matters relating to title including the extent and boundaries of the property and other important matters before exchange of contracts.



william h brown



01354 654545



march@williamhbrown.co.uk



34 High Street, MARCH, Cambridgeshire, PE15 9JR



williamhbrown.co.uk