

Mattock Drive
Fleckney
Fleckney
LE8 8EE

£1,350 Per Month



OSCAR JAMES

...expect excellence

FLOOR PLANS

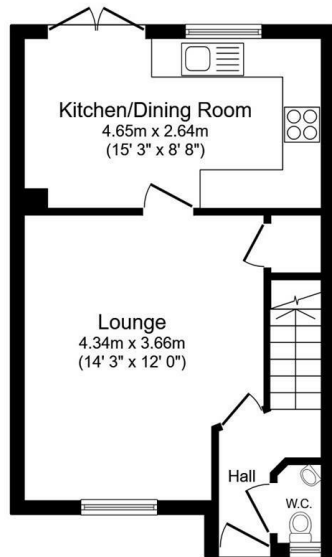

Ground Floor

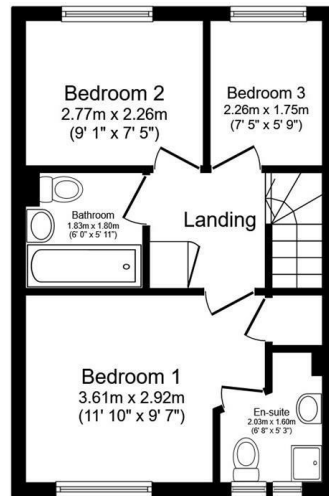

First Floor



Total floor area 67.5 sq.m. (726 sq.ft.) approx

This floor plan is for illustrative purposes only. It is not drawn to scale. Any measurements, floor areas (including any total floor area), openings and orientation are approximate. No details are guaranteed, they cannot be relied upon for any purpose and they do not form part of any agreement. No liability is taken for any error, omission or misstatement. A party must rely upon its own inspection(s). Powered by www.focalagent.com

AT A GLANCE...



custom text 1



custom text 4



custom text 2



custom text 5



custom text 3



custom text 6



WHAT'S GREAT?

Nestled in the charming area of Mattock Drive, Fleckney, this delightful three-bedroom property presents an excellent opportunity for those seeking a comfortable and modern living space.

As you step inside, you are welcomed by a spacious and light-filled lounge, perfect for relaxation or entertaining guests. The open-plan kitchen and dining area is a standout feature, equipped with integrated appliances that make cooking and dining a pleasure.

The property boasts three well-proportioned bedrooms with an en-suite shower to the master, providing ample space for rest and personalisation. The bathroom is conveniently located, ensuring ease of access for all residents. Outside, the low-maintenance garden offers a serene retreat, complete with a storage shed for your gardening tools or outdoor equipment.

Parking is a breeze with space available for one vehicle complete with electric charging point, making this home not only practical but also ideal for families or professionals.

This beautiful example of a three-bedroom property in Fleckney is sure to attract interest, combining modern living with the convenience of local amenities. Don't miss the chance to make this lovely house your new home.

Furniture packages available upon request

*** PROPERTY AVAILABLE NOW ***

Council Tax Band: B
EPC Rating: B

...expect excellence



SELLER'S SECRET



Why we like it....

OSCAR JAMES

1 Newland Street | Kettering | NN16 8JH
01536 415777
www.oscar-james.com

To buy or not to buy....
