



2 Claremont House

London Road, Redhill, RH1 2JP

£900 Per Calendar Month



AVAILABLE MAY- Thomas & May Offers to Market this Newly Sympathetically Converted One Bedroom Apartment Located within 1/2 mile of Redhill Town Centre & Railway Station with Integrated Kitchen



Communal Front Door

Leading to communal entrance hall, stairs leading up to half landing

Own Front Door

Kitchen/Reception Room 13'0" x 11'10" (3.96 x 3.61)

Rear aspect Sash window, radiator, wood flooring, power points, vaulted ceiling, skylight window

Kitchen Area

Comprising a range of wall mounted and base level units, rolltop worksurface, stainless steel sink with mixer tap, built in oven with hob and extractor hood over, integrated fridge/freezer, integrated washer/dryer, entry phone system, fuse box, door to

Bedroom 12'0" x 8'0" (including depth of wardrobes) (3.66 x 2.44 (including depth of wardrobes))

Rear aspect Sash window, radiator, power points, front aspect window, fitted wardrobe with mirror glide doors

Bathroom

Comprising white three piece suite with inset wash hand basin with mixer tap, low level wc with concealed cistern, integrated bath with chrome mixer tap and shower attachment, chrome heated towel rail, tiled floor, tiled walls, wall mounted mirror, extractor fan, skylight, cupboard housing boiler

Area Map

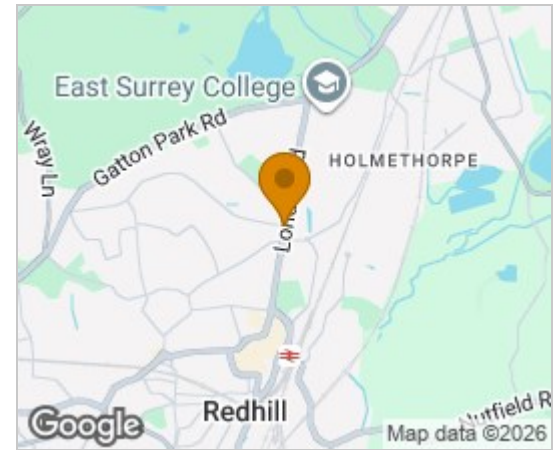

Floor Plans

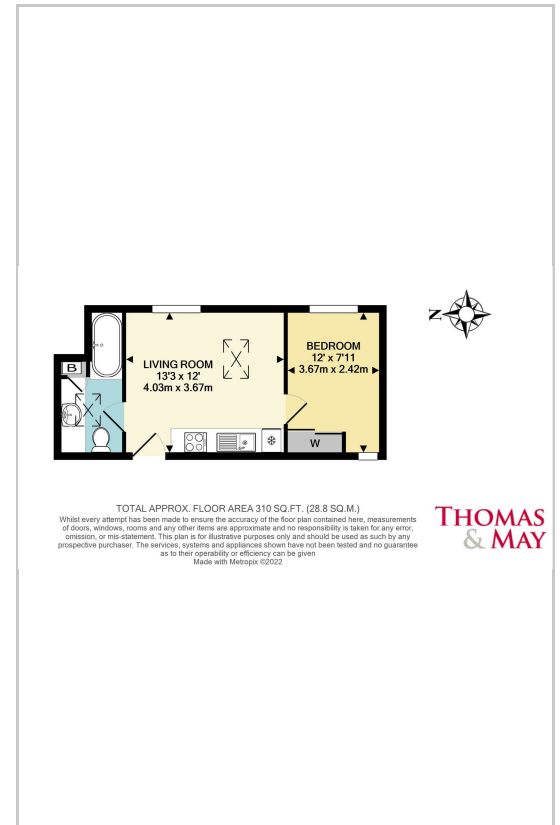

Energy Efficiency Graph

These particulars, whilst believed to be accurate are set out as a general outline only for guidance and do not constitute any part of an offer or contract. Intending purchasers should not rely on them as statements of representation of fact, but must satisfy themselves by inspection or otherwise as to their accuracy. No person in this firm's employment has the authority to make or give any representation or warranty in respect of the property.

2-3 South Parade, School Hill, Merstham, Surrey, RH1 3RA

Tel: 01737 648048 Email: merstham@thomasandmay.com <https://www.thomasandmay.com/>