



Derinton Road, SW17

£650,000



- Two Bedrooms
- Two Reception Rooms

- Southwest Facing Garden
- Open Plan Kitchen/Dining

- Close to Transport Links
- 660 Sq. Ft.





ABOUT THE PROPERTY

A well presented two bedroom house with a private garden located in the popular Totterdown conservation area.

This terraced house comes to the market in great condition and offers a bright and spacious interior. The ground floor has two reception rooms and an open plan kitchen/dining area creating the perfect downstairs living space. There is neat wooden flooring throughout and one reception room benefits from a bay window, typical of a late Victorian property. The fully fitted kitchen is flooded with natural light due to the skylight windows and double doors leading to the south-westerly facing private garden. Both bedrooms are on the first floor, with the master located towards the front of the property. Completing the house is the family style bathroom which has a shower over the bath.



Derinton Road is located in the heart of Tooting and equidistance between both Tooting Bec and Tooting Broadway Underground Station (Northern line, zone 3) with services to the City and West End. Both Tooting Bec and Tooting Broadway boast a wonderful selection of boutique shops, supermarkets, cafes, and pubs and Tooting Bec Common is also just a short stroll away.



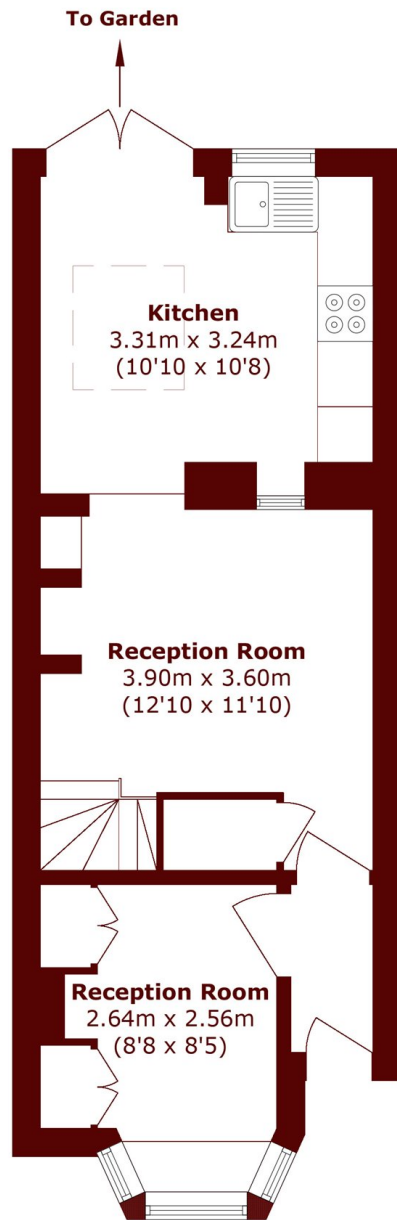

Ground Floor

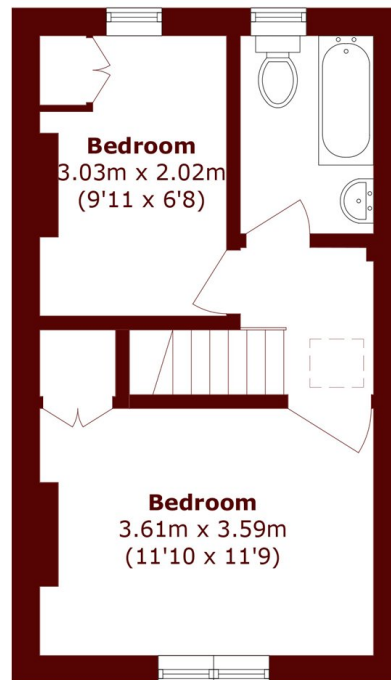

First Floor

Total area (approx.): 61.3 sq. m (659.8 sq. ft)

Marsh & Parsons Tooting
29-31 Upper Tooting Road,
London, SW17 7TS
020 8767 3655

We aim to make our particulars both accurate and reliable. However, they are not guaranteed; nor do they form part of an offer or contract. If you require clarification on any points then please contact us, especially if you're traveling some distance to view. Please note that appliances and heating systems have not been tested and therefore no warranties can be given as to their good working order.