

## Kimber Road, SW18

£1,750 Per calendar month

Situated on the ground floor of a private development is this immaculate one bedroom furnished apartment. The property has been recently renovated to an excellent standard, and has well maintained communal gardens.

Coleman Court is located just off Kimber Road in Southfields, which is moments from the wide variety of shops, bars and restaurants along Garrett Lane, as well the green space of King Georges Park.

### Features

- One Double Bedroom
- Ground Floor Flat
- Excellent Location
- Modern Integrated Kitchen
- Private Development
- Communal Gardens

Kimber Road,  
London, SW18

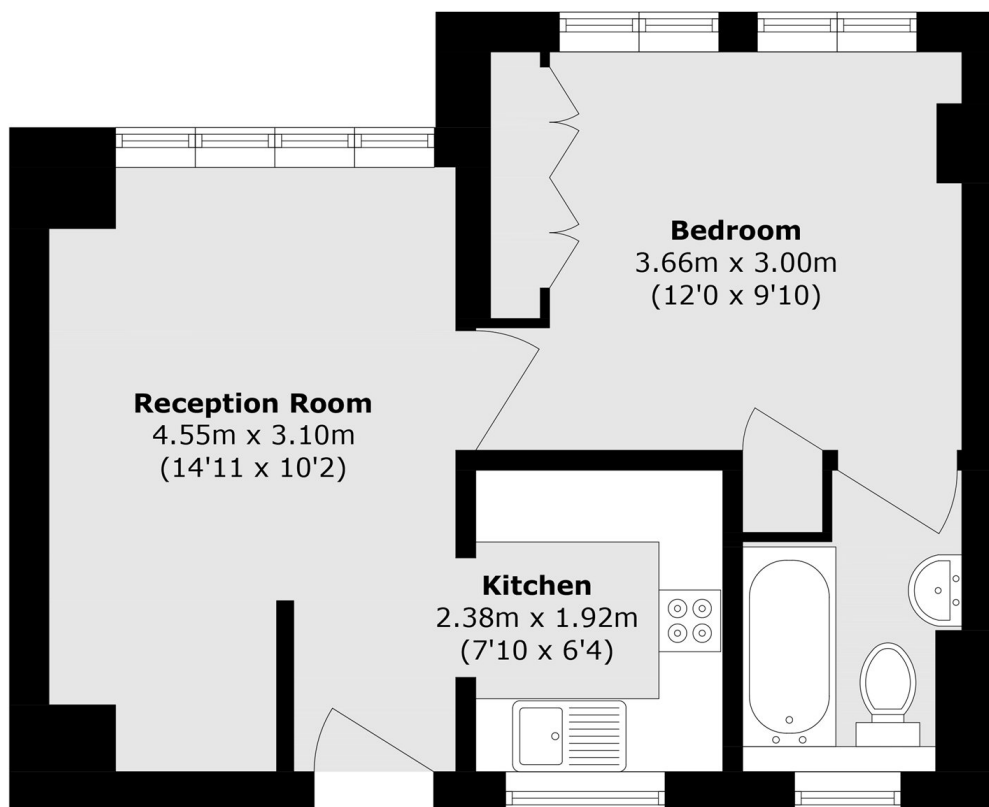

Total area (approx.): 34.4 sq. m (370.2 sq. ft)