



Tentelow Lane, UB2

£375,000

Tucked away amongst the leafy surroundings of Norwood Green, a well-presented two-bedroom flat set within a private development.

Located on the first floor, overlooking the West facing, well maintained large garden and communal swimming pool, the property features an entrance hall with storage, a spacious living room with dual aspect windows, a modern fitted kitchen and contemporary bathroom.

The property comes with Share of Freehold, a garage and is conveniently located close to local shops and transport links, including the Elisabeth Line, Piccadilly Line, Syon Park and Isleworth overground Station, all just a short bus ride away. An extensive sports & leisure centre is also close by, as is Osterley Park and lots of green, recreational spaces.

Features

First Floor Flat
Two Bedrooms
Share of Freehold
Swimming Pool
Garage
No Onward Chain

Tentelow Lane,
Southall, UB2

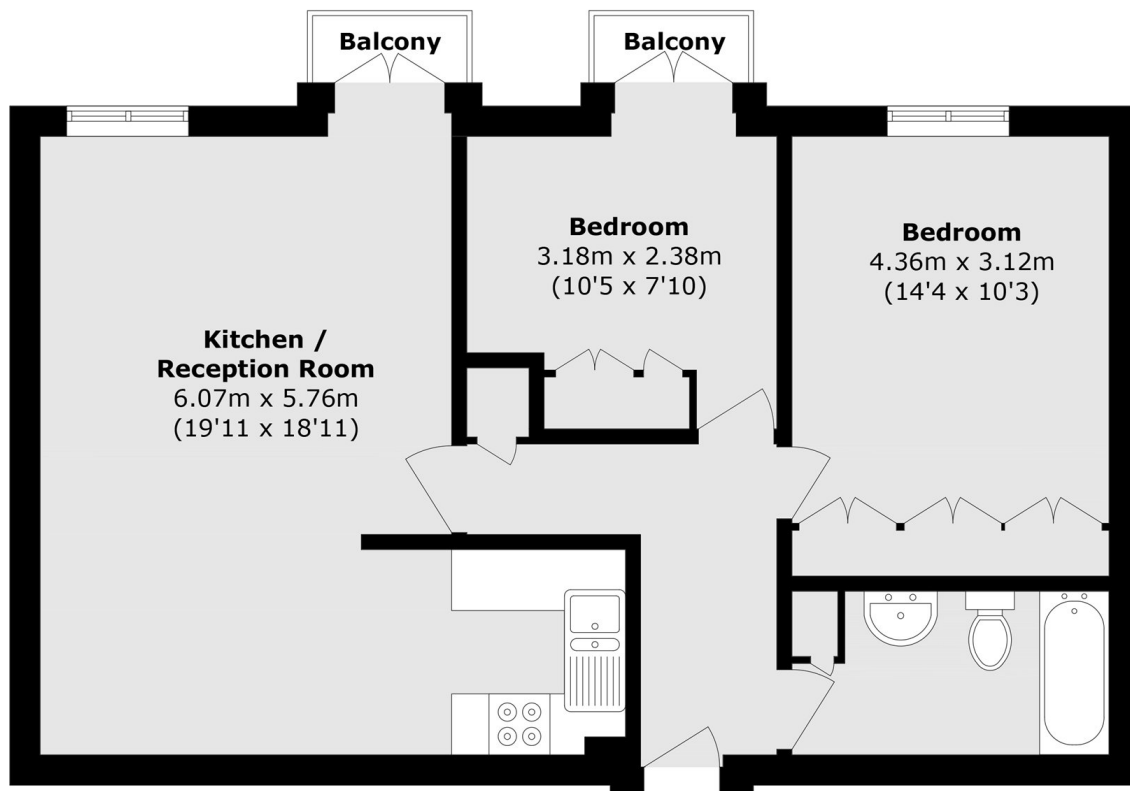

Total area (approx.): 64.7 sq. m (696.4 sq. ft)
Balcony area (approx.): 2.0 sq. m (21.5 sq. ft)