



CLAPHAM COMMON SOUTH SIDE,

£2,250 per month

This spacious and bright one bedroom apartment has been finished to an exacting standard throughout and boasts wooden floors and neutral décor.

One bedroom
High specification
Lift access

Open plan dining
Spacious
Clapham South

STEP INSIDE CLAPHAM COMMON SOUTH SIDE

The Latitude, SW4

APPROX. GROSS INTERNAL FLOOR AREA 596 SQFT / 55.37 SQM

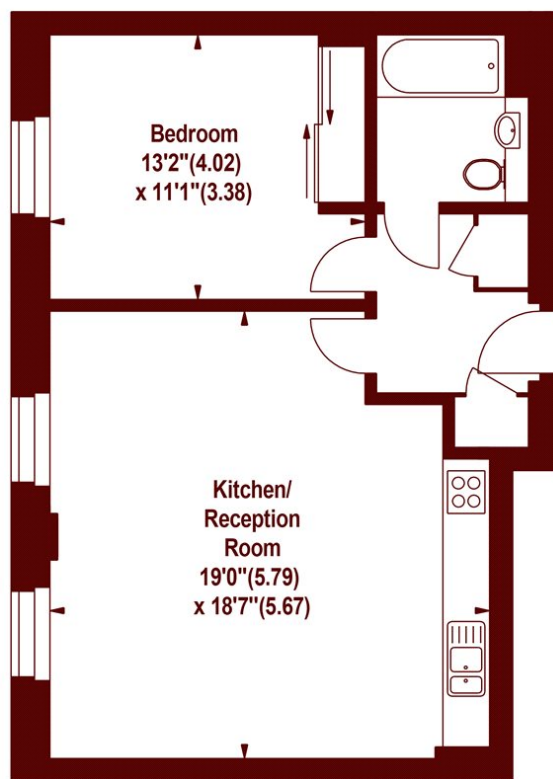

THIRD FLOOR

Illustration For Identification Purposes Only. Not To Scale
*Floorplan Drawn According To RICS Guidelines
Copyright of FeaturePRO

Balham & Clapham South
020 8772 9200

Energy Rating: We aim to make our particulars both accurate and reliable. However, they are not guaranteed; nor do they form part of an offer or contract. If you require clarification on any points then please contact us, especially if you're traveling some distance to view. Please note that appliances and heating systems have not been tested and therefore no warranties can be given as to their good working order

**MARSH &
PARSONS**