

abbotFox



Trowse, NR14
£240,000 - £250,000

“

We are a team of genuine individuals who hold a deep passion for both property and marketing. Collectively, we bring over 70 years of experience in the property market of Norfolk and Suffolk. Our affection for both counties runs deep, and we are enthusiastic about sharing our passion with you.

Colin McKenzie | **Branch Partner**







THE DETAIL _____

abbotFox presents this charming mid-terraced cottage, enviably positioned overlooking the picturesque village green in the highly sought after village of Trowse, and offered to the market with no onward chain.

Enjoying an idyllic setting, this characterful home offers a wonderful sense of calm and community, with uninterrupted views across open green space right from the front door. The accommodation is both flexible and inviting, perfectly suited to a variety of lifestyles.

Internally, the property comprises, two reception rooms, kitchen and bathroom to the ground floor, with two generous double bedrooms, and an additional third bedroom access off the rear garden.

Externally, the property benefits from a rear garden, providing a peaceful outdoor retreat ideal for entertaining, gardening, or simply unwinding after a long day.

Trowse is widely regarded as one of the area's most desirable villages, offering a perfect balance of countryside charm and city convenience, with scenic riverside walks, local amenities, and excellent access to Norwich city centre, the A47, and mainline rail links.

Properties in this position are rarely available, making an early viewing highly recommended to fully appreciate the setting, character, and lifestyle on offer.

Guide Price £230,000 - £240,000







THE HIGHLIGHTS _____

- Mid terraced cottage
- Two / three bedrooms
- Two reception rooms
- Overlooking the village green
- Easy access to Norwich City Centre
- Excellent local amenities
- No onward chain
- Viewing advised
- Guide Price £230,000 - £240,000

Approx Gross Internal Area
65 sq m / 695 sq ft

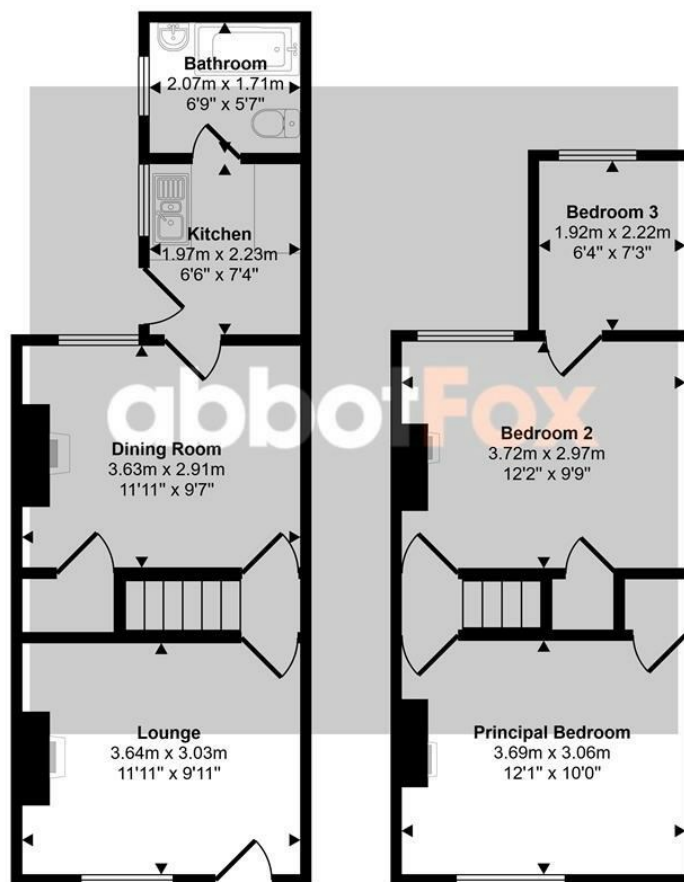

Ground Floor
Approx 34 sq m / 368 sq ft

First Floor
Approx 30 sq m / 327 sq ft

This floorplan is only for illustrative purposes and is not to scale. Measurements of rooms, doors, windows, and any items are approximate and no responsibility is taken for any error, omission or mis-statement. Icons of items such as bathroom suites are representations only and may not look like the real items. Made with Made Snappy 360.

Let's talk

01603 660000

sales@abbotfox.co.uk

@abbotfox

EPC RATING -

Disclaimer – In accordance with the Property Misdescriptions Act, the company abbotFox gives notice that all descriptions, references to condition, necessary permissions for use and other details are given in good faith and believed to be correct, but any purchaser should not rely on them as statements of fact, and must satisfy themselves by inspection or other means, as to their accuracy.