



# Millstone Cottages, Portskewett

3 Bedrooms  
2 Bathrooms  
1 Receptions

£279,950



## Beautiful Home with Spectacular Views!

Nestled in the charming village of Portskewett, Caldicot, Millstone Cottages offers a delightful opportunity for those seeking a comfortable family home. This well-appointed house features three generous double bedrooms, providing ample space for relaxation and privacy. The primary bedroom is complemented by its own en-suite and walk-in wardrobe, ensuring convenience and comfort.

The property boasts a welcoming reception room, perfect for entertaining guests or enjoying quiet evenings with family. The layout of the house is designed to maximise both space and light, creating a warm and inviting atmosphere throughout. The kitchen/ diner is a lovely social space benefiting from plenty of natural light via Velux windows and patio doors leading to a patio area. The property benefits from an integral garage with parking behind.

Situated on Main Road, this home benefits from easy access to local amenities and transport links, making it an ideal choice for families and professionals alike. The surrounding area is known for its picturesque landscapes and friendly community, offering a peaceful retreat from the hustle and bustle of city life.

Mill Stone Cottages is not just a house; it is a place where memories can be made. With its blend of modern comforts and traditional charm, this property is sure to appeal to those looking for a new home in a desirable location. Do not miss the chance to make this lovely house your own.



Lounge  
14x13'1

Garage  
9'2x20'11

Kitchen  
14x8

W/C  
3'3x5'7

Dining Room  
9'2x11'8

Bedroom One  
12'2x15'7

en suite  
7x5'7

Bedroom Two  
10'7x12'2

Bedroom Three  
7'6x8'10

Bathroom  
6'2x5'6



- No Onward Chain
- Three Bedrooms
- Village Location
- Driveway Parking
- Integral Garage

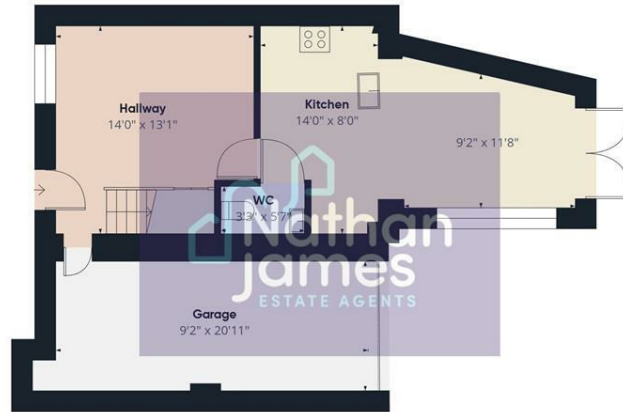

Floor 0

Approximate total area<sup>1)</sup>  
1143 ft<sup>2</sup>



Floor 1

(1) Excluding balconies and terraces

Calculations reference the RICS IPMS 3C standard. Measurements are approximate and not to scale. This floor plan is intended for illustration only.

GIRAFFE360

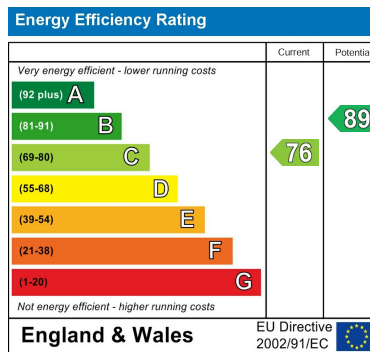

8 Newport Road  
Caldicot  
Monmouthshire  
NP26 4HX  
01291 421600

nj@nathanjamesestateagents.co.uk  
nathanjamesestateagents.com