



Blenheim Way, Yaxley Peterborough  
**£210,000** Freehold

**Sharman  
Quinney**

# Key Features



- Established Mid Terraced Home
- Two Double Bedrooms
- Downstairs Cloakroom
- Kitchen/Diner
- Enclosed Rear Garden

Perfect First Time Home, Established Mid Terraced House is located in a popular area of Yaxley and in brief the accommodation includes, Entrance Hall with stairs to the first floor landing and doors to, Downstairs Cloakroom with a low level wc, wash hand basin, wall mounted heating boiler, Lounge with double glazed sliding patio doors to the rear garden, Kitchen/Diner which is fitted with a range of base and eye level units, cupboards and drawers, worktop space with a single drainer sink unit, space for a cooker and fridge/freezer, plumbing for a washing machine, walk-in storage cupboard, Upstairs First Floor Landing with doors to the Two Double Bedrooms, three piece Family Bathroom comprising of a panelled bath with a hand shower attachment, low level wc, wash hand basin with storage under, Outside open plan garden to the front, Rear Garden is enclosed, laid



mainly to law, with a patio seating area, various plants and shrubs, door to the brick built-in store shed, at the bottom of the garden there is a driveway providing off road parking and benefits from having a Carport.

For Measurements please see the floorplan.

Entrance Hall:

Downstairs Cloakroom

Lounge

Kitchen/Diner

Built-In Storage Cupboard

First Floor Landing:

Bedroom 1

Bedroom 2

Family Bathroom



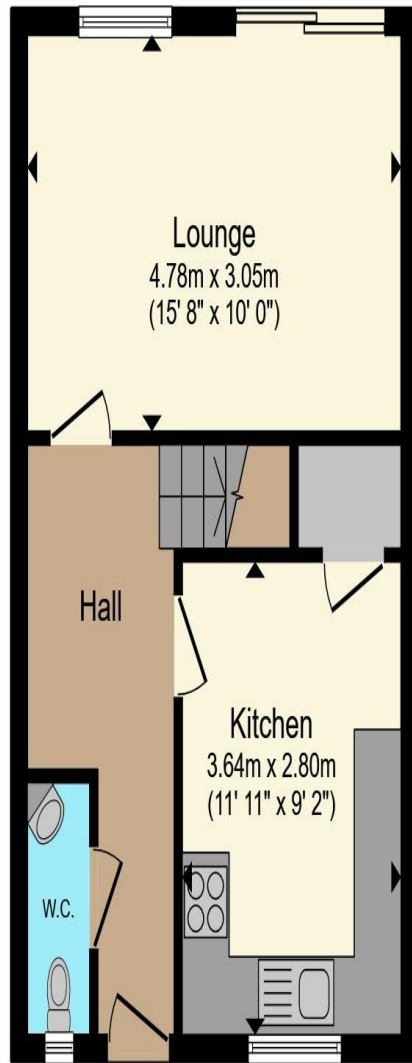

**Ground Floor**

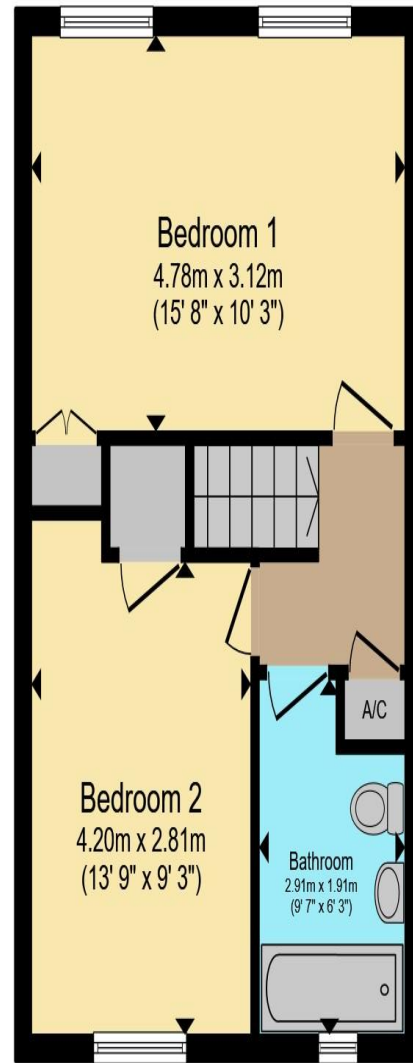

**First Floor**

Total floor area 73.5 m<sup>2</sup> (791 sq.ft.) approx

This floor plan is for illustrative purposes only. It is not drawn to scale. Any measurements, floor areas (including any total floor area), openings and orientation are approximate. No details are guaranteed, they cannot be relied upon for any purpose and they do not form part of any agreement. No liability is taken for any error, omission or misstatement. A party must rely upon its own inspection(s). Powered by [www.propertybox.io](http://www.propertybox.io)

**Sharman  
Quinney**

To view this property call Sharman Quinney on:  
**01733 245400**

# Selling your property?

Contact us to arrange a **FREE** home valuation.

 01733 245400

 Unit 19 Maltings Square, Broadway Shopping Centre, Yaxley, Cambridgeshire, PE7 3EW

 yaxley@sharmanquinney.co.uk

 [www.sharmanquinney.co.uk](http://www.sharmanquinney.co.uk)



 SCAN ME



Sharman Quinney Holdings Limited is registered in England and Wales under company number 4174227, Registered Office is Cumbria House, 16-20 Hockliffe Street, Leighton Buzzard, Bedfordshire, LU7 1GN. VAT Registration Number is 500 2481 05.

1: These particulars do not constitute part or all of an offer or contract. 2: The measurements indicated are supplied for guidance only and as such must be considered incorrect. 3: Potential buyers are advised to recheck the measurements before committing to any expense. 4: Sharman Quinney has not tested any apparatus, equipment, fixtures, fittings or services and it is the buyers interests to check the working condition of any appliances. 5: Sharman Quinney has not sought to verify the legal title of the property and buyers must obtain verification from their legal representative. 6: Intending purchasers will be asked to produce identification documentation at a later stage and we would ask your co-operation in order that there will be no delay in agreeing the sale. Ref: YAX203302 - 0003

